

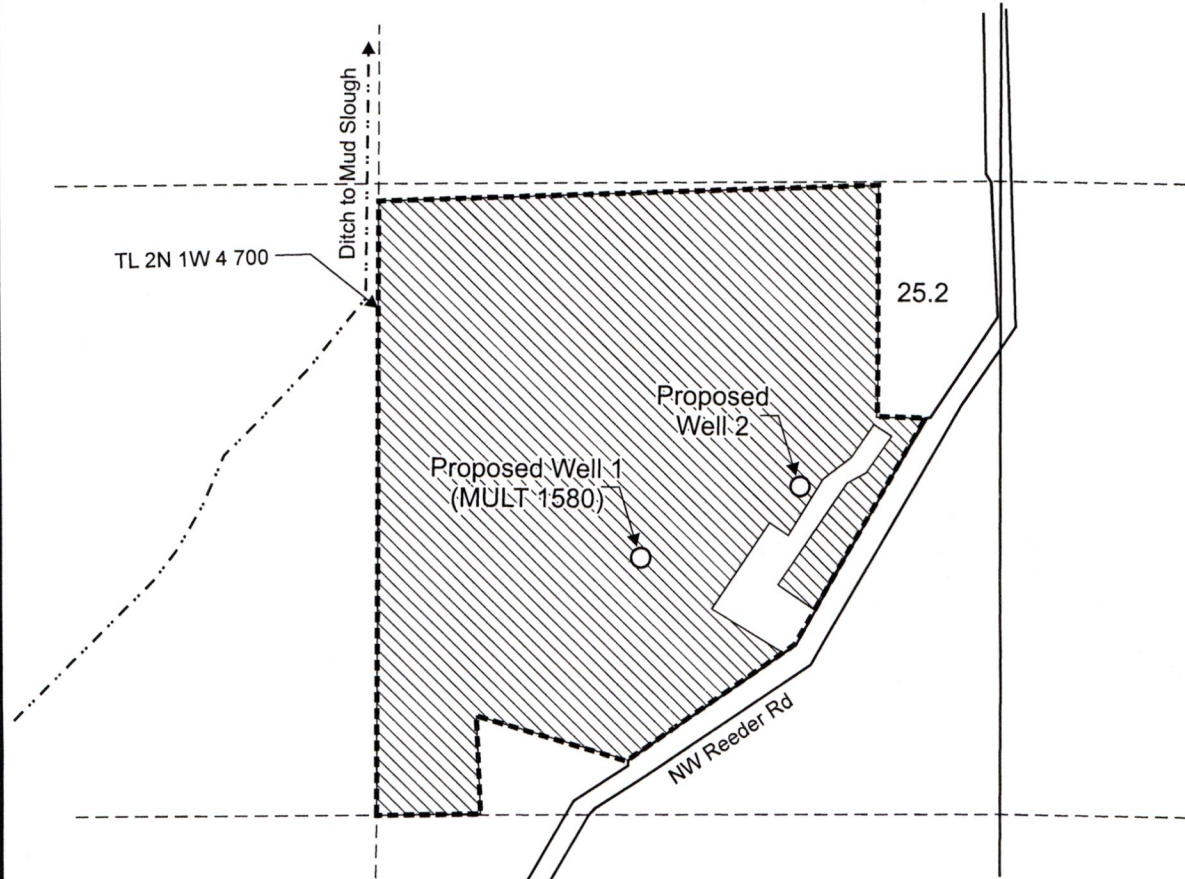

T.2N. R.1W. Section 4, W.M.



Proposed Well 1 (MULT 1580) is located 1,830 feet north and 740 feet west from the SE corner, Section 4.

Proposed Well 2 is located 1,980 feet north and 400 feet west from the SE corner, Section 4.

 Area (25.2 Acres) to be Irrigated

 Tax lot boundary

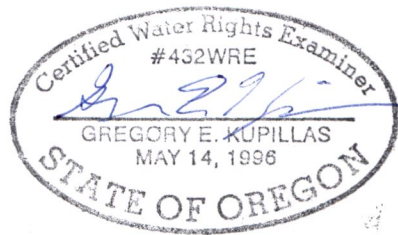

EXPIRATION DATE: 6/30/2019

RECEIVED

MAR 23 2018

OWRD

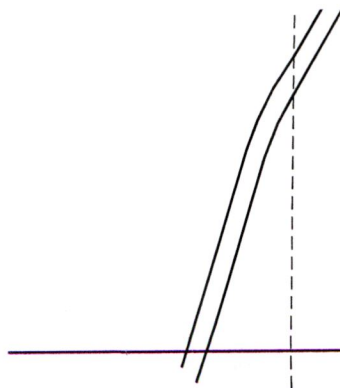

4	3
9	10



This map was prepared for the purpose of identifying the location of a water right only and is not intended to provide legal dimensions or location of property ownership lines.

Pacific Hydro-Geology Inc.

Water Right Application Map

Columbia Holdings LLC c/o Peter Stott
T.2N. R.1W. Section 4, W.M.

03/2018

StottGWApp.cdr

6-19279