

# Water Right Application to Use Groundwater Points of Appropriation and Place of Use Map

Suprise Valley Electrification Corporation

Lake County  
Township 33 South, Range 18 East (W.M.)

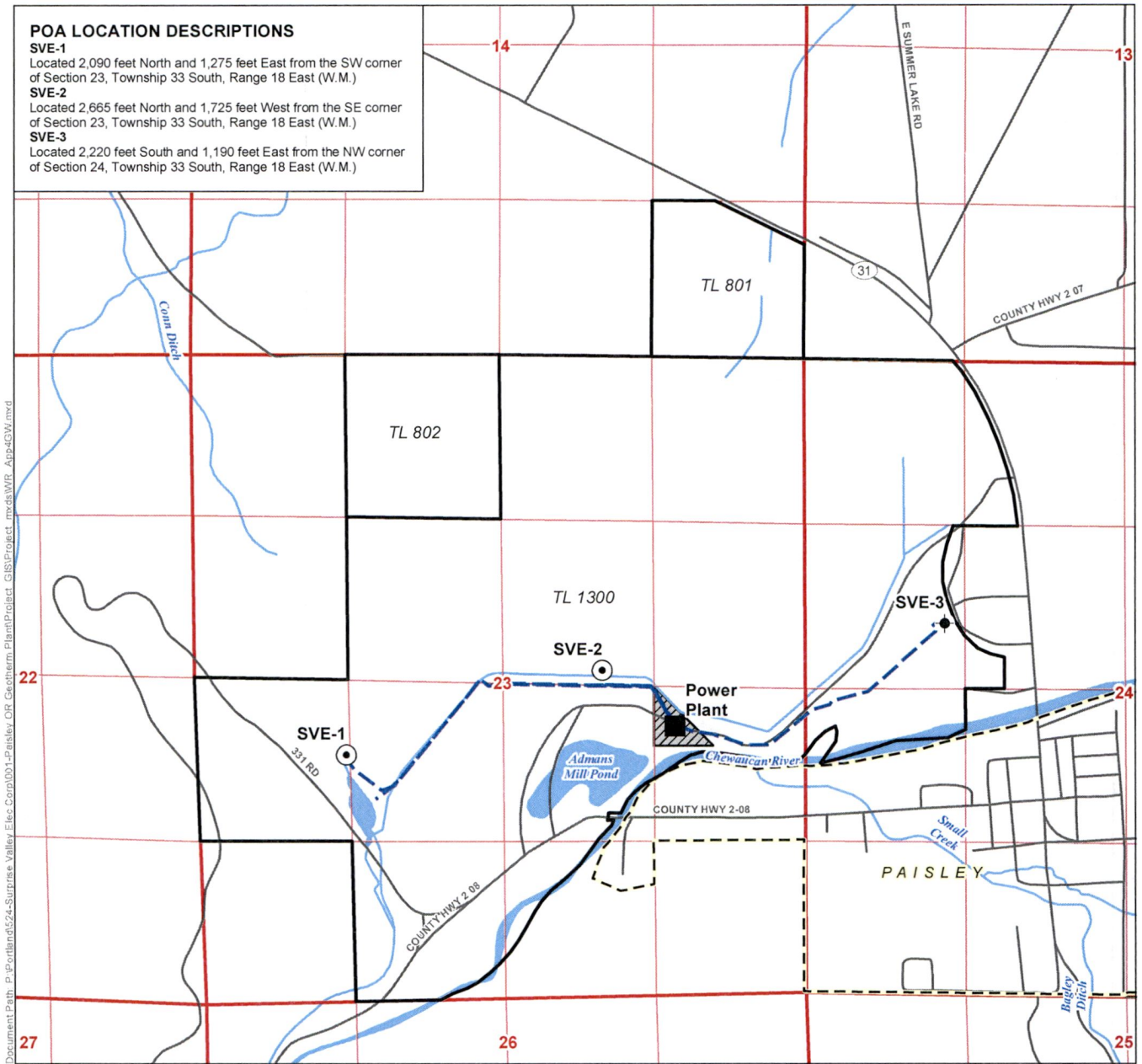

**POA LOCATION DESCRIPTIONS**  
**SVE-1**  
 Located 2,090 feet North and 1,275 feet East from the SW corner of Section 23, Township 33 South, Range 18 East (W.M.)  
**SVE-2**  
 Located 2,665 feet North and 1,725 feet West from the SE corner of Section 23, Township 33 South, Range 18 East (W.M.)  
**SVE-3**  
 Located 2,220 feet South and 1,190 feet East from the NW corner of Section 24, Township 33 South, Range 18 East (W.M.)

Document Path: P:\ord\hand6524-Suprise Valley Elec. Corp\001-Paisley OF Geoterm Plant\Project\_GIS\Project\_mxd\WP\_App-GW.mxd

**LEGEND**

- Point of Appropriation (POA)
- Injection Well (SVE-2)
- Power Plant
- Power Plant Piping System
- Place of Use (POU)
- Tax Lot
- Paisley City Limit
- Road
- Watercourse
- Waterbody

**DISCLAIMER**

This map was prepared for the purpose of identifying the location of a water right only and it is not intended to provide legal dimensions or location of property ownership lines.

**MAP NOTES**

Date: September 20, 2017  
 Data Sources: OWRD, USGS, US BLM, ESRI

RECEIVED BY OWRD

DEC 04 2017

SALEM, OR

RECEIVED

JAN 02 2018

OWRD

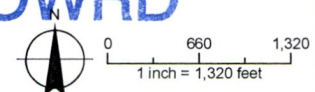

6-18-17