

Permit Amendment Application Additional Point of Appropriation

Application G-14300, Permit G-17743
City of St. Paul, Oregon

Township 4 South, Range 2 West (W.M.)

RECEIVED

APR 24 2020

OWRD

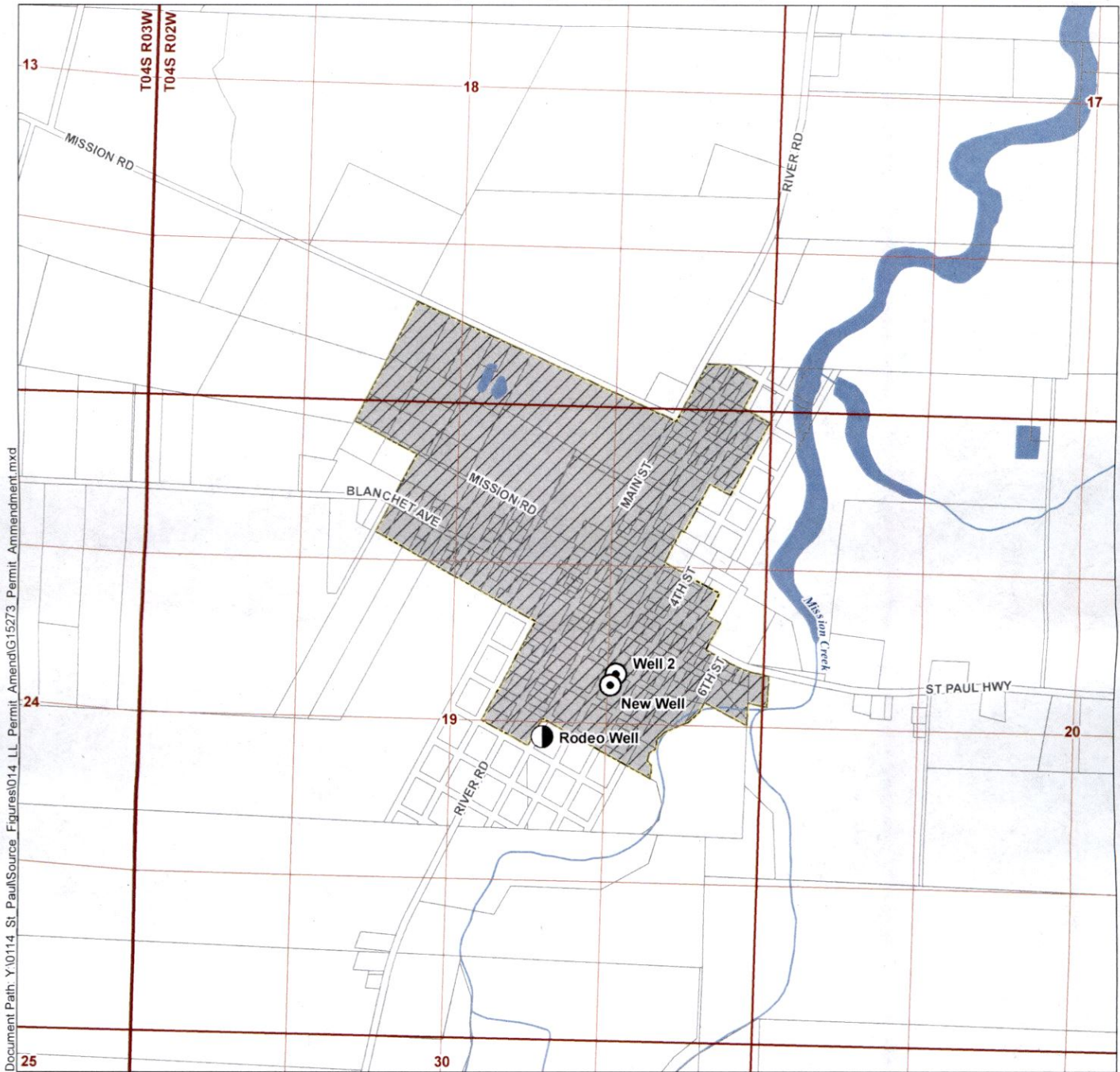

Document Path: Y:\0114 St. Paul\Source Figures\014_LL_Permit_Amend\G15273_Permit_Amendment.mxd

LEGEND

- Point of Appropriation (POA)
- Additional Point of Appropriation (POA)
- Place of Use (POU)
- City Boundary
- Tax Lot
- Watercourse
- Waterbody

Disclaimer
This map was prepared for the purpose of identifying the location of a water right only and it is not intended to provide legal dimensions or location of property ownership lines.

Map Notes

Date: February 27, 2020
Data Sources: BLM, ESRI, USGS

POA Location Description

New Well: Located 2,400 feet South and 4,085 feet East from the NW corner of Section 19, Township 4 South, Range 2 West (W.M.)
Well 2: Located 2,314 feet South and 4,150 feet East from the NW Corner Section 19, Township 4 South, Range 2 West (W.M.)
Rodeo Well: Located 2,620 feet North and 1,900 feet West from the SE Corner Section 19, Township 4 South, Range 2 West (W.M.)

13430

