

Sections 7, 17 & 18, T1N, R1E, W.M.,
Multnomah County, Oregon

RECEIVED





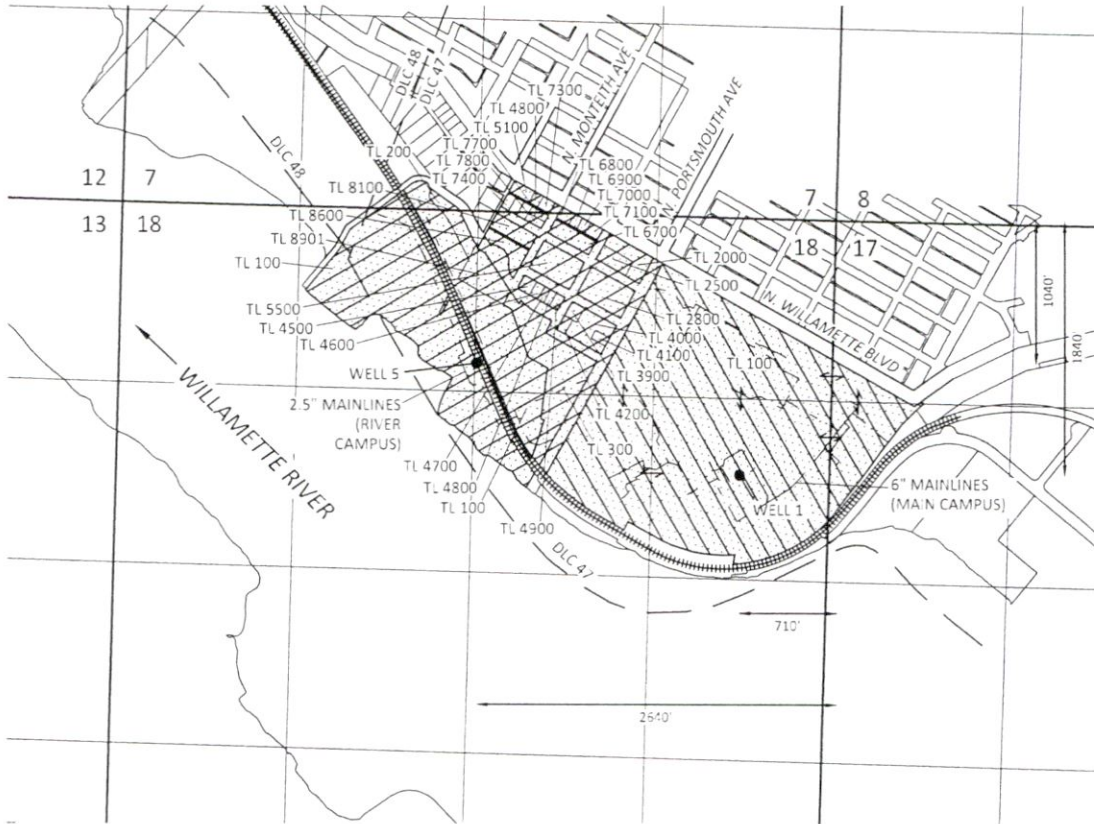

FEB 11 2021

Application G-16653, Permit G-16085
PERMIT AMENDMENT APPLICATION MAP
University of Portland

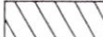
OWRD



EXPLANATION

-  AUTHORIZED PLACE OF USE
-  WELL 1 PROPOSED PLACE OF USE
-  WELL 5 PROPOSED PLACE OF USE
-  WELL
-  RAILROAD (EXCLUDED FROM PLACE OF USE)
-  PIPELINE

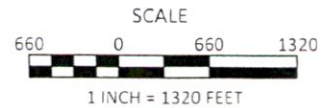

January 15, 2020

This map is not intended to provide legal dimensions or locations of property ownership lines



111 SW Fifth Ave., Suite 2600
Portland, OR 97204
O: 503.542.3860
F: 503.224.4681
www.kpff.com

FOR
INFORMATION
ONLY

Figure 16 -