

T4N, R2W T4N, R1W

**POA LOCATION DESCRIPTIONS**

- MR-1**  
Located 270 feet North and 3,400 feet West from the East 1/4 corner of section 7, Township 3 North, Range 1 West (W.M.)
- MR-2**  
Located 360 feet North and 3,630 feet West from the East 1/4 corner of section 7, Township 3 North, Range 1 West (W.M.)
- MR-3**  
Located 2,475 feet South and 1,795 feet East from the NW corner of Section 7, Township 3 North, Range 1 West (W.M.)
- CZ-1**  
Located 1,590 feet South and 680 feet East from the NW corner of Section 7, Township 3 North, Range 1 West (W.M.)
- CZ-2**  
Located 900 feet South and 1,120 feet East from the NW corner of Section 7, Township 3 North, Range 1 West (W.M.)
- CZ-3**  
Located 1,410 feet South and 1,855 feet East from the NW corner of Section 7, Township 3 North, Range 1 West (W.M.)
- MP-1**  
Located 2,330 feet North and 1,345 feet East from the SW corner of Section 7, Township 3 North, Range 1 West (W.M.)
- Well Option 1**  
Located 700 feet South and 2,230 feet West from the NE corner of Section 7, Township 3 North, Range 1 West (W.M.)
- Well Option 2**  
Located 820 feet South and 2,725 feet West from the NE corner of Section 7, Township 3 North, Range 1 West (W.M.)
- Well Option 3**  
Located 280 feet South and 1,820 feet West from the NE corner of Section 7, Township 3 North, Range 1 West (W.M.)
- Well Option 4**  
Located 1,580 feet North and 950 feet East from the SW corner of Section 6, Township 3 North, Range 1 West (W.M.)
- Well Option 5**  
Located 870 feet North and 1,100 feet East from the SW corner of Section 6, Township 3 North, Range 1 West (W.M.)
- Well Option 6**  
Located 885 feet South and 1,785 feet West from the NE corner of Section 6, Township 3 North, Range 1 West (W.M.)
- Well Option 7**  
Located 2,390 feet North and 1,640 feet West from the SE corner of Section 6, Township 3 North, Range 1 West (W.M.)
- Well Option 8**  
Located 1,010 feet North and 1,630 feet West from the SE corner of Section 6, Township 3 North, Range 1 West (W.M.)

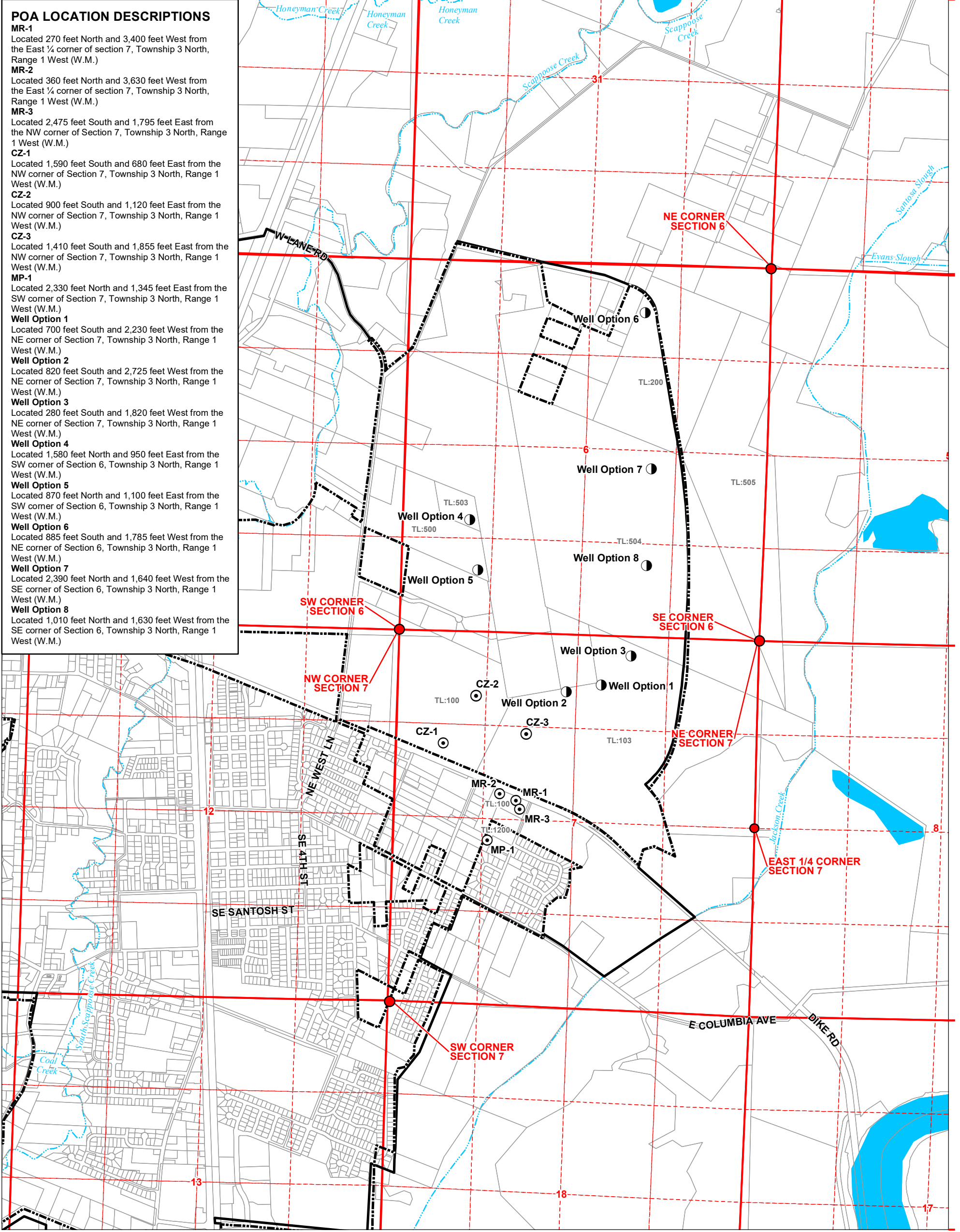

**LEGEND**

- ⊙ Existing POA
- Proposed POA
- Scappoose City Limits
- Scappoose Urban Growth Boundary
- Tax Lots
- ~ Watercourses
- Waterbodies

**DISCLAIMER**

This map was prepared for the purpose of identifying the location of a water right only and it is not intended to provide legal dimensions or location of property ownership lines.

**Application for a Permit Amendment  
in the Name of the City of Scappoose**

**Points of Appropriation**

Permit G-17644, Application G-15792  
Township 3 North, Ranges 1 & 2 West (W.M.)

**MAP NOTES:**

Date: January 29, 2016  
Data Sources: Columbia Co. GIS, OWRD, OGIC, US BLM, ESRI

