

Permit Amendment Application
 For Permit G-18689
 Point of Appropriation Map
 Morrow County, OR
 Townships 4 North,
 Ranges 25 & 26 East (W.M.)

LEGEND

- ⊕ Monitoring Well Location – Approved by OWRD
- ⊙ Authorized POA
- Proposed POA
- Railroad
- Tax Lot
- ~ Watercourse
- Waterbody

Received by OWRD

JUL 20 2023

Salem, OR

POA LOCATION DESCRIPTION

Authorized Points of Appropriation
 Well 1: Located 1230 feet North and 1330 feet East from the SW corner of Section 1, Township 4 North, Range 25 East (W.M.)
 Well 2: Located 120 feet North and 2500 feet East from the SW corner of Section 1, Township 4 North, Range 25 East (W.M.)
 Well 3: Located 1500 feet North and 2660 feet East from the SW corner of Section 1, Township 4 North, Range 25 East (W.M.)
 Well 4: Located 2878 feet North and 3120 feet East from the SW corner of Section 1, Township 4 North, Range 25 East (W.M.)
 Well 5: Located 740 feet South and 1860 feet West from the NE corner of Section 12, Township 4 North, Range 25 East (W.M.)
 Well 6: Located 150 feet South and 1780 feet West from the NE corner of Section 12, Township 4 North, Range 25 East (W.M.)
 Well 7: Located 2500 feet North and 100 feet West from the SE corner of Section 1, Township 4 North, Range 25 East (W.M.)
Proposed Points of Appropriation
 Well A: Located 340 feet South and 2500 feet East from the NW corner of Section 6, Township 4 North, Range 25 East (W.M.)
 Well B: Located 35 feet South and 3140 feet East from the NW corner of Section 6, Township 4 North, Range 25 East (W.M.)
 Well C: Located 5 feet South and 3500 feet East from the NW corner of Section 6, Township 4 North, Range 25 East (W.M.)
 Well D: Located 475 feet South and 3540 feet East from the NW corner of Section 6, Township 4 North, Range 25 East (W.M.)
 Well E: Located 830 feet South and 3535 feet East from the NW corner of Section 6, Township 4 North, Range 25 East (W.M.)
 Well F: Located 1295 feet South and 3420 feet East from the NW corner of Section 6, Township 4 North, Range 25 East (W.M.)
 Well G: Located 1880 feet South and 3410 feet East from the NW corner of Section 6, Township 4 North, Range 25 East (W.M.)
 Well H: Located 2525 feet South and 3400 feet East from the NW corner of Section 6, Township 4 North, Range 25 East (W.M.)
 Well I: Located 2730 feet South and 2850 feet East from the NW corner of Section 6, Township 4 North, Range 25 East (W.M.)
 Well J: Located 3680 feet South and 2820 feet East from the NW corner of Section 6, Township 4 North, Range 25 East (W.M.)
 Well K: Located 45 feet South and 1610 West from the NE corner of Section 1, Township 4 North, Range 25 East (W.M.)
 Well L: Located 4360 feet South and 3940 West from the NE corner of Section 1, Township 4 North, Range 25 East (W.M.)

DISCLAIMER

This map was prepared for the purpose of identifying the location of a water right only and it is not intended to provide legal dimensions or location of property ownership lines.

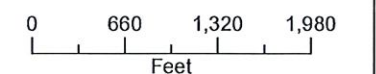

Date: July 20, 2023
 Data Sources: ESRI, Umatilla Co., Morrow Co.,
 USGS, BLM, OWRD



Groundwater Permit G-18689
Place of Use
 Umatilla and Morrow Counties, Oregon

- LEGEND**
- Place of Use (POU)
 - Primary - 1,128.9 ac.
 - Supplemental - 8,013.5 ac.
 - All Other Features
 - Tax Lot
 - County Boundary
 - Watercourse
 - Waterbody

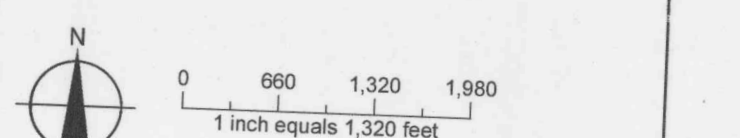

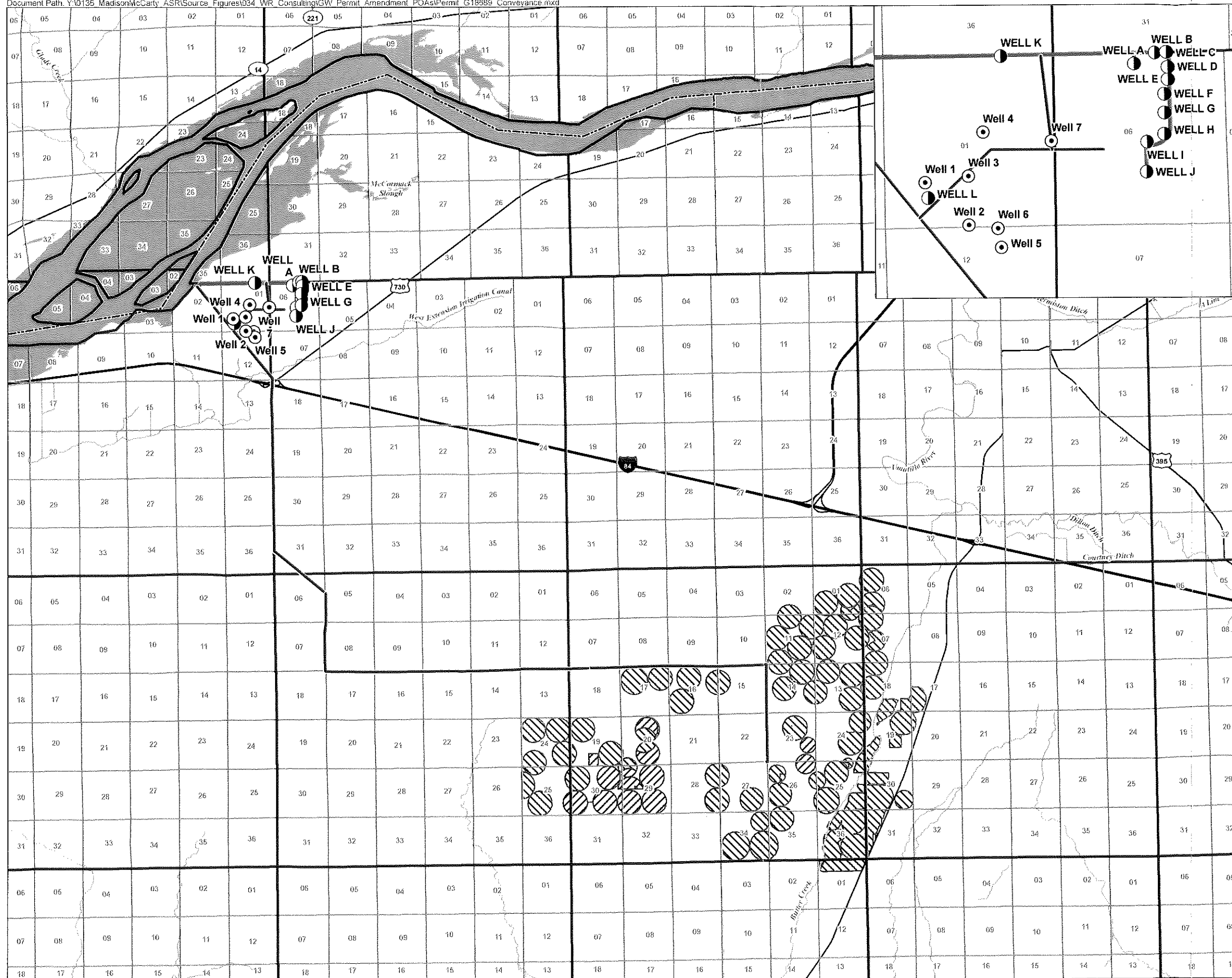

Conveyance Map For Permit G-18689

Umatilla and Morrow Counties,
Oregon

Townships 2, 3, 4, & 5 North,
Ranges 25, 26, 27, & 28 East (W.M.)

- LEGEND**
- Conveyance Pipeline
 - Proposed Mainline
 - Point of Appropriation (POA)
 - Authorized POA
 - Proposed POA
 - Place of Use (POU)
 - Primary - 1,128.9 ac.
 - Supplemental - 8,013.5 ac.
 - All Other Features
 - County Boundary
 - Major Road
 - Watercourse
 - Waterbody

RECEIVED
JAN 14 2022
OWRD
13893

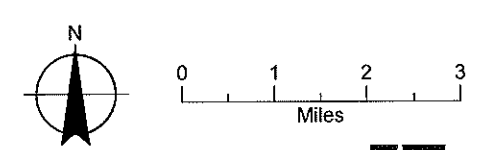

13893
~~19683~~

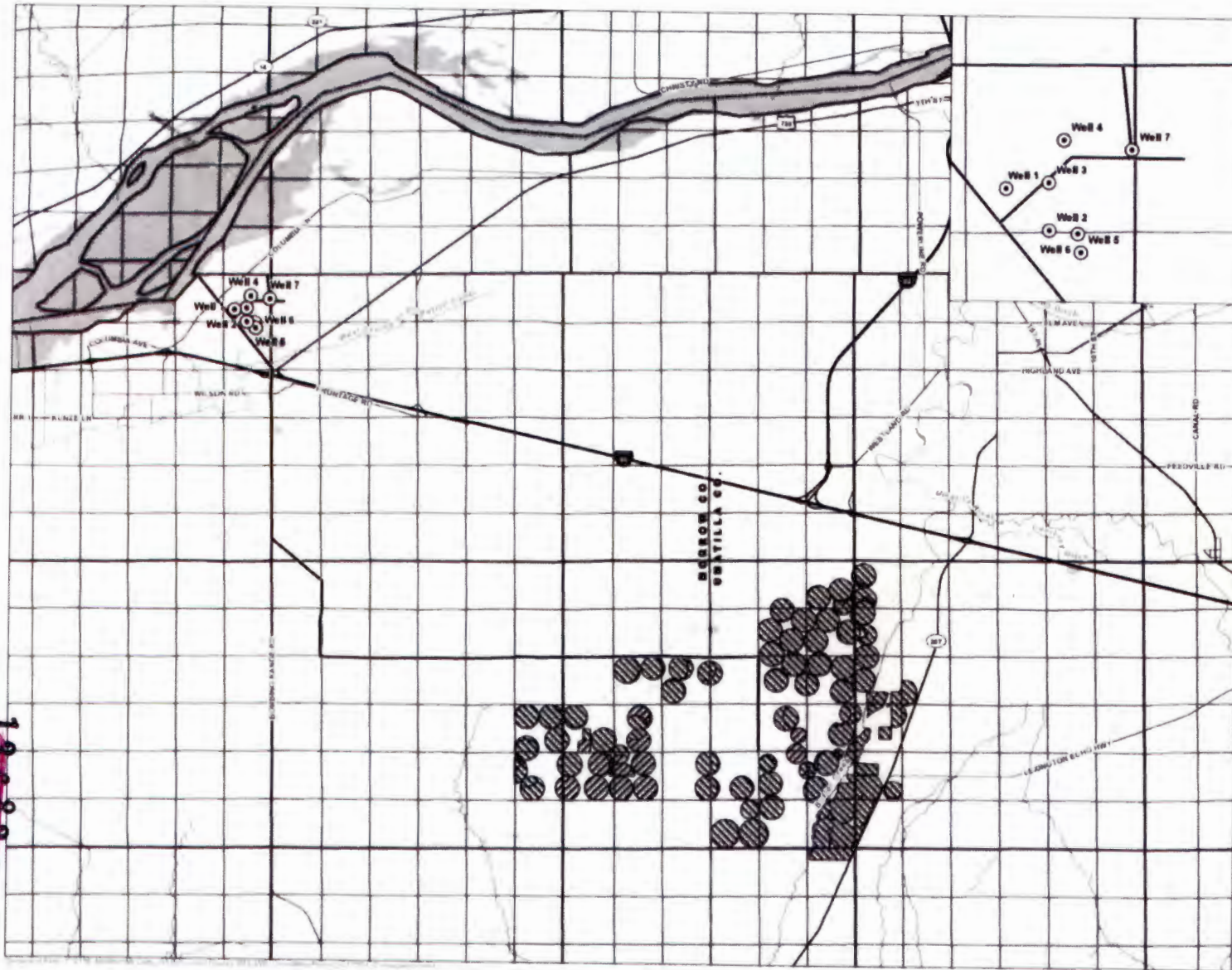

**Conveyance Map For
Permit G-17354
Umatilla and Morrow Counties,
Oregon**
Townships 2, 3, 4, & 5 North,
Ranges 25, 26, 27, & 28 East (W.M.)

- LEGEND**
- Authorized PDA
 - ~ Conveyance Pipeline
 - Place of Use (POU)**
 - ▨ Primary - 1,128.9 ac
 - ▩ Supplemental - 8,013.5 ac
 - All Other Features**
 - County Boundary
 - ≡ Major Road
 - ~ Watercourse
 - Waterbody

RECEIVED
APR 21 2021
OWRD

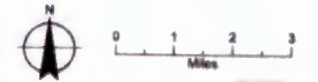

Date: March 26 2021
Data Sources: BLM, ESRI, USGS



RECEIVED
JAN 14 2022

OWRD

**Permit Amendment Application
For Permit G-18689
Point of Appropriation Map
Morrow County, OR
Townships 4 North,
Ranges 25 & 26 East (W.M.)**

- LEGEND**
- ⊕ Monitoring Well Location - Approved by OWRD
 - ⊙ Authorized POA
 - ⊖ Proposed POA
 - Railroad
 - ▭ Tax Lot
 - ▭ Watercourse
 - ▭ Waterbody

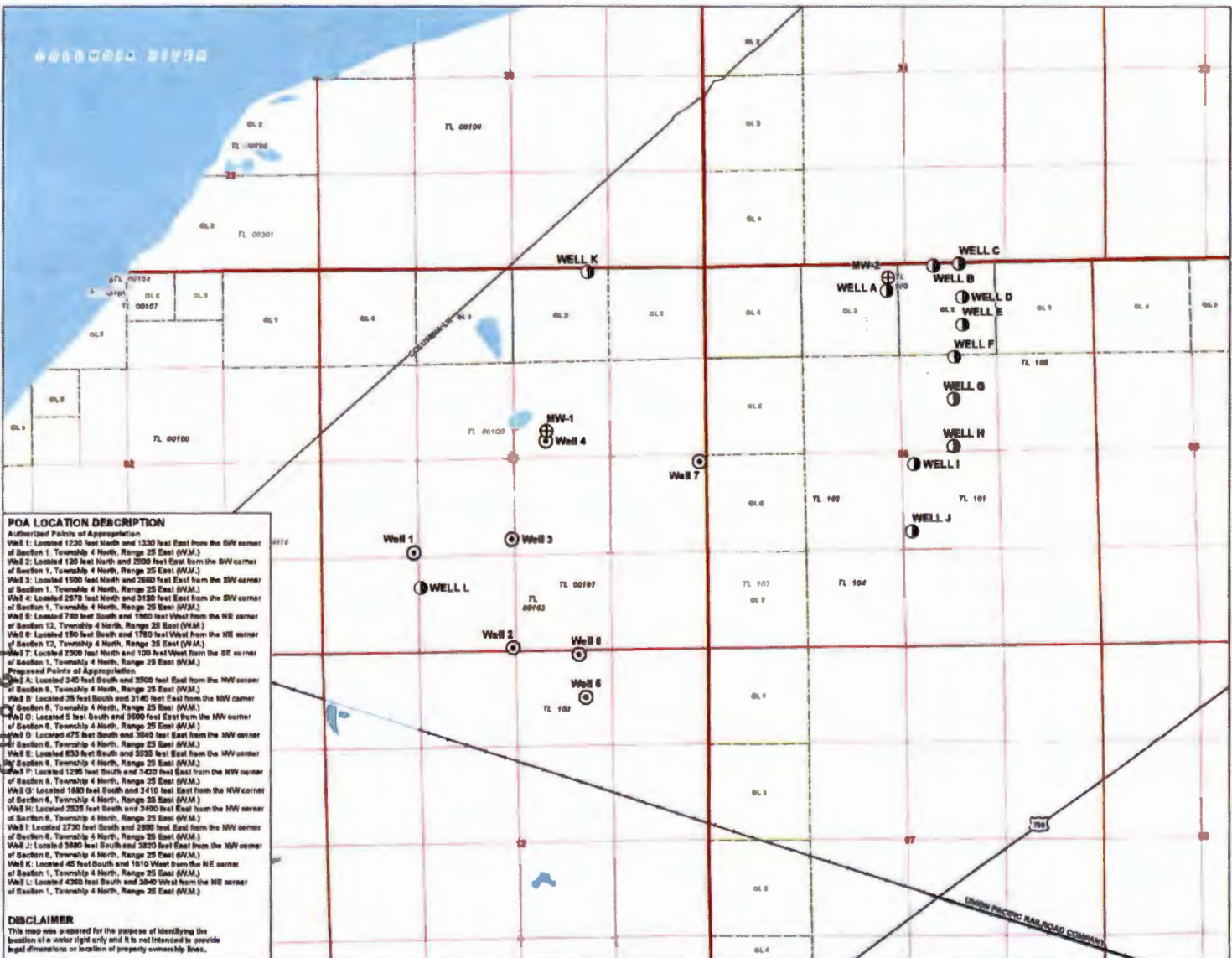

POA LOCATION DESCRIPTION
Authorized Points of Appropriation
Well 1: Located 1230 feet South and 1330 feet East from the SW corner of Section 1, Township 4 North, Range 25 East (W.M.)
Well 2: Located 120 feet North and 2000 feet East from the NW corner of Section 1, Township 4 North, Range 25 East (W.M.)
Well 3: Located 1500 feet North and 2600 feet East from the SW corner of Section 1, Township 4 North, Range 25 East (W.M.)
Well 4: Located 2978 feet North and 3120 feet East from the SW corner of Section 1, Township 4 North, Range 25 East (W.M.)
Well 5: Located 740 feet South and 1950 feet West from the NE corner of Section 12, Township 4 North, Range 25 East (W.M.)
Well 6: Located 180 feet South and 1780 feet West from the NE corner of Section 12, Township 4 North, Range 25 East (W.M.)
Well 7: Located 2508 feet North and 100 feet West from the SE corner of Section 1, Township 4 North, Range 25 East (W.M.)
Proposed Points of Appropriation
Well A: Located 340 feet South and 2500 feet East from the NW corner of Section 8, Township 4 North, Range 25 East (W.M.)
Well B: Located 26 feet South and 3140 feet East from the NW corner of Section 8, Township 4 North, Range 25 East (W.M.)
Well C: Located 5 feet South and 3990 feet East from the NW corner of Section 8, Township 4 North, Range 25 East (W.M.)
Well D: Located 475 feet South and 3640 feet East from the NW corner of Section 8, Township 4 North, Range 25 East (W.M.)
Well E: Located 630 feet South and 3230 feet East from the NW corner of Section 8, Township 4 North, Range 25 East (W.M.)
Well F: Located 1295 feet South and 3420 feet East from the NW corner of Section 8, Township 4 North, Range 25 East (W.M.)
Well G: Located 1800 feet South and 3410 feet East from the NW corner of Section 8, Township 4 North, Range 25 East (W.M.)
Well H: Located 2528 feet South and 3400 feet East from the NW corner of Section 8, Township 4 North, Range 25 East (W.M.)
Well I: Located 2730 feet South and 2890 feet East from the NW corner of Section 8, Township 4 North, Range 25 East (W.M.)
Well J: Located 5080 feet South and 3200 feet East from the NW corner of Section 8, Township 4 North, Range 25 East (W.M.)
Well K: Located 45 feet South and 1610 feet West from the NE corner of Section 1, Township 4 North, Range 25 East (W.M.)
Well L: Located 4360 feet South and 3640 feet West from the NE corner of Section 1, Township 4 North, Range 25 East (W.M.)

DISCLAIMER
 This map was prepared for the purpose of identifying the location of a water right only and is not intended to provide legal dimensions or location of property ownership lines.

RECEIVED
 JAN 14 2022
 OWRD

0 660 1,320 1,980
 Feet

Date: September 17, 2021
 Data Source: EBRL, Umatilla Co., Morrow Co.,
 USBR, BLM, OWRD
 GSI
 Water Solutions, Inc.

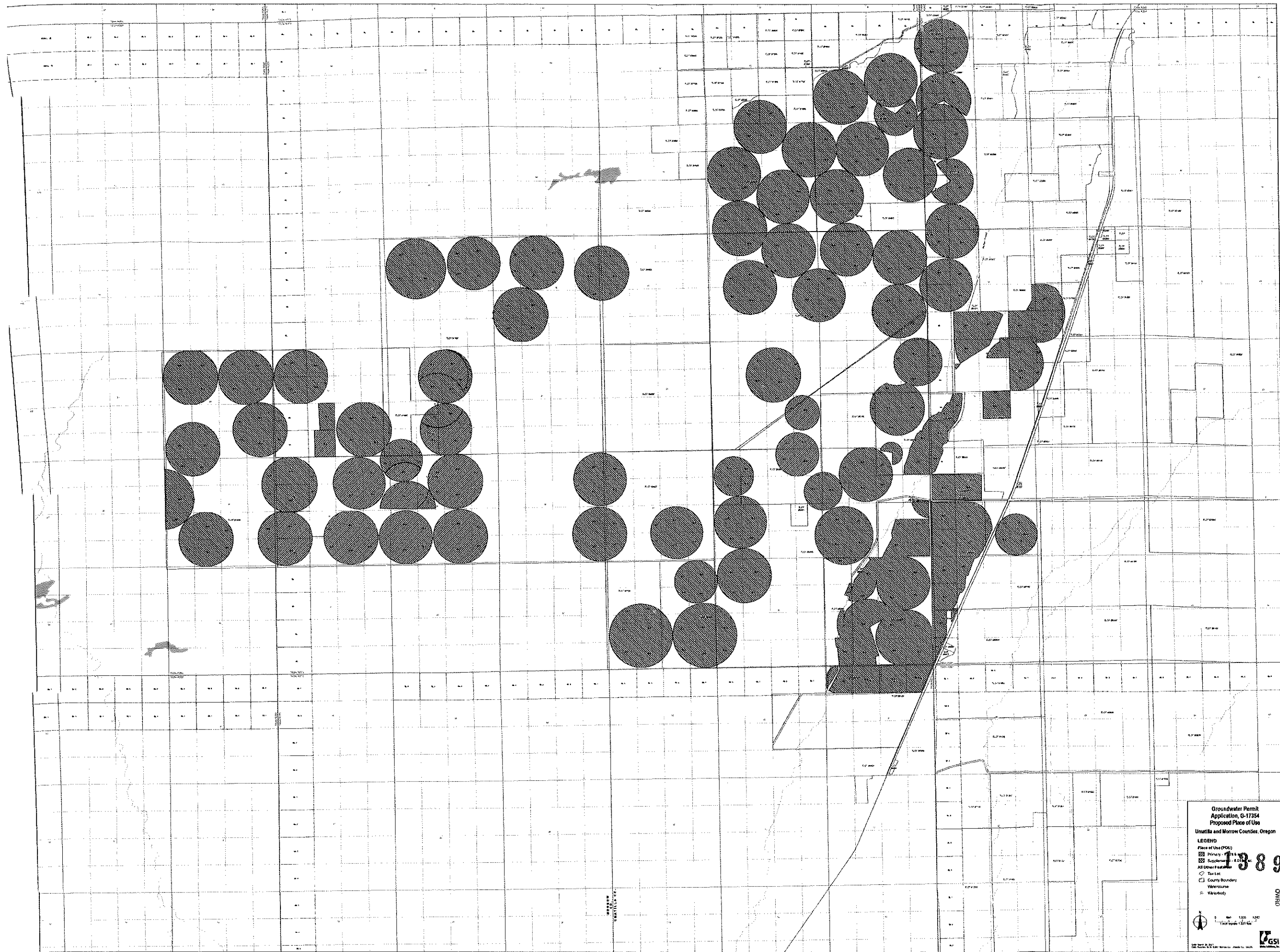

RECEIVED
 JAN 14 2022
 OWRD

Groundwater Permit
 Application, G-17354
 Proposed Place of Use
 Unstilla and Morrow Counties, Oregon

LEGEND
 Place of Use (POU)
 Primary POU
 Supplemental POU
 All Other POU
 Watercourse
 County Boundary
 Watercourse
 Waterbody

13893

OWRD
 2022 JAN 14 10:00 AM

GSI



FIGURE 1
Test Hole Location Map
 Madison Ranches

LEGEND

- Authorized POA
- Proposed POA
- Test Hole
- Main line
- - - Proposed Mainline
- ▬ Potable Pipeline
- One Mile Buffer from Columbia River
- ▭ City Boundary
- ≡ Major Road
- Railroad
- ~ Watercourse

RECEIVED
 JAN 14 2022
 OWRD

Note:
 TH-1 = MORR 52512
 TH-2 (Destroyed)
 TH-3 = MORR 52575
 TH-4 = MORR 52578
 TH-5 = MORR 52579
 TH-6 = MORR 52580

13893

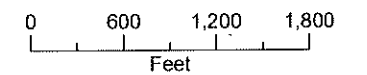
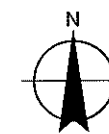

Date: April 20, 2021
 Data Sources: BLM, ESRI, ODOT, USGS,
 Aerial Photo 2019



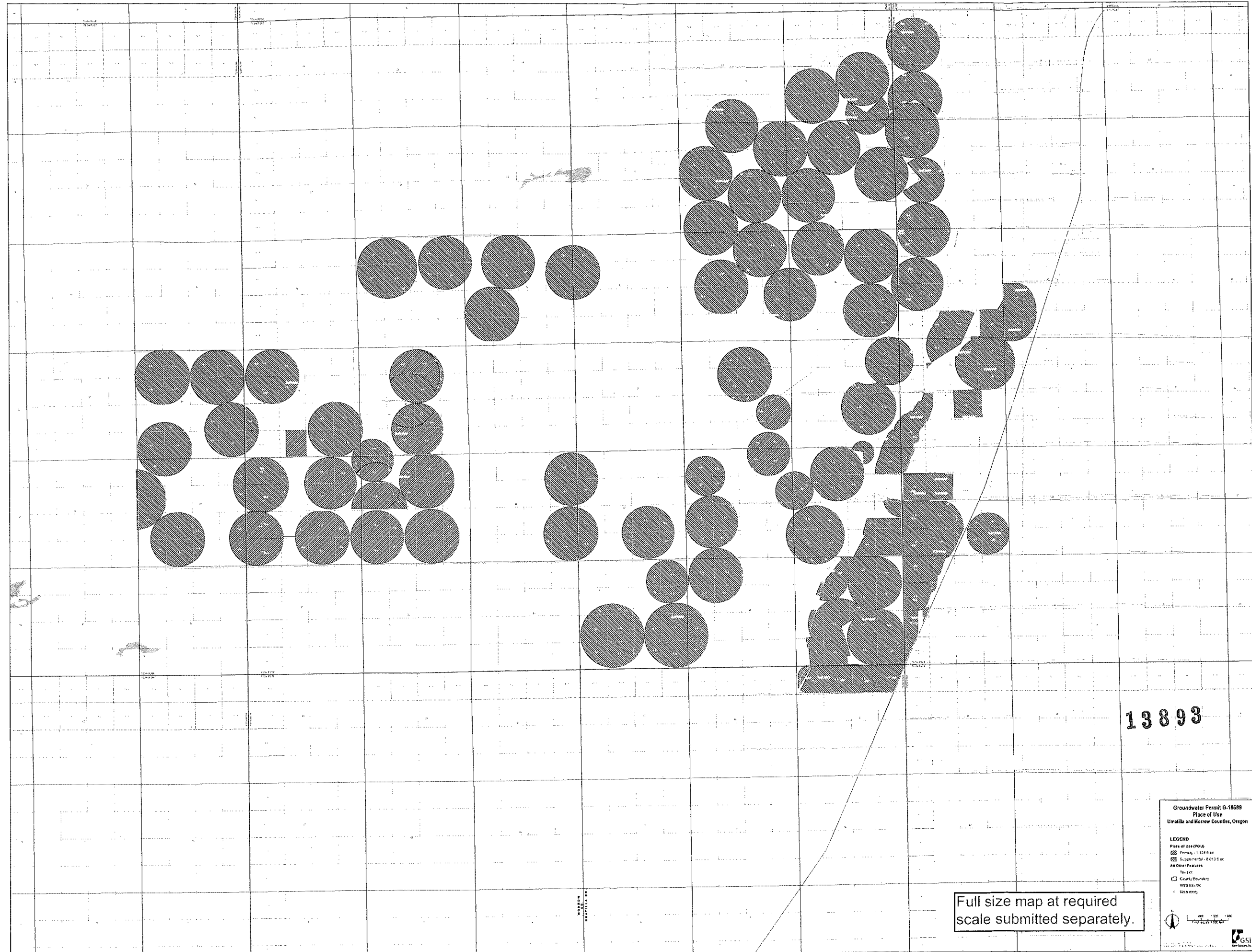

RECEIVED

JAN 14 2022

OWRD

13893

Groundwater Permit D-16589
Place of Use
Unalla and Morrow Counties, Oregon

- LEGEND**
Place of Use (POU)
Primary - 1,000 ft²
Supplemental - 2,610 ft²
All Other Facilities
County Boundary
Watercourse
Wellhead

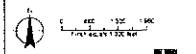

Full size map at required
scale submitted separately.

**Permit Amendment Application
For Permit G-18689
Point of Appropriation Map
Morrow County, OR
Townships 4 North,
Ranges 25 & 26 East (W.M.)**

LEGEND

- ⊕ Monitoring Well Location –
Approved by OWRD
- ⊙ Authorized POA
- Proposed POA
- Railroad
- - - Tax Lot
- ~ Watercourse
- Waterbody

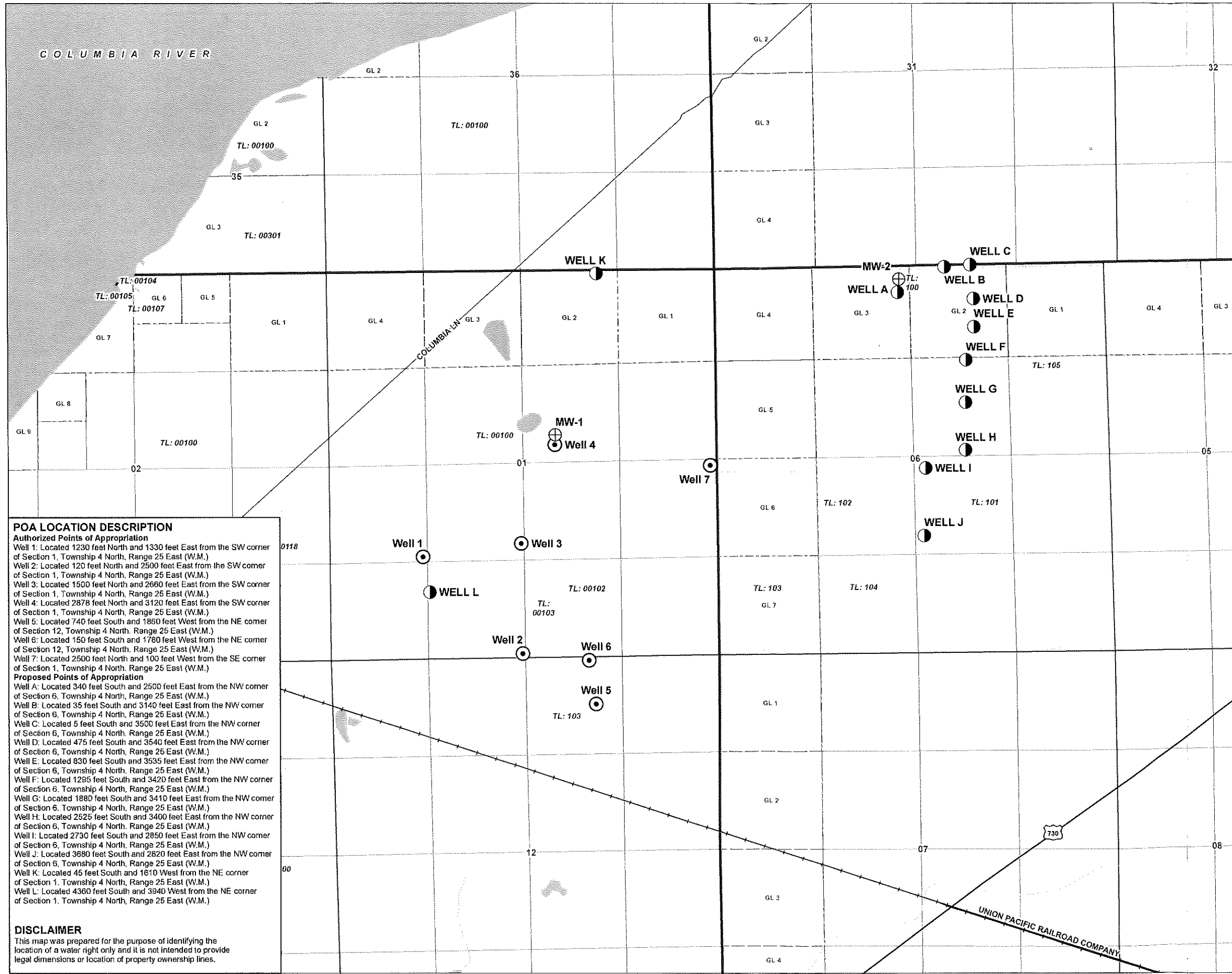

POA LOCATION DESCRIPTION

Authorized Points of Appropriation
 Well 1: Located 1230 feet North and 1330 feet East from the SW corner of Section 1, Township 4 North, Range 25 East (W.M.)
 Well 2: Located 120 feet North and 2500 feet East from the SW corner of Section 1, Township 4 North, Range 25 East (W.M.)
 Well 3: Located 1500 feet North and 2660 feet East from the SW corner of Section 1, Township 4 North, Range 25 East (W.M.)
 Well 4: Located 2878 feet North and 3120 feet East from the SW corner of Section 1, Township 4 North, Range 25 East (W.M.)
 Well 5: Located 740 feet South and 1860 feet West from the NE corner of Section 12, Township 4 North, Range 25 East (W.M.)
 Well 6: Located 150 feet South and 1780 feet West from the NE corner of Section 12, Township 4 North, Range 25 East (W.M.)
 Well 7: Located 2500 feet North and 100 feet West from the SE corner of Section 1, Township 4 North, Range 25 East (W.M.)

Proposed Points of Appropriation
 Well A: Located 340 feet South and 2500 feet East from the NW corner of Section 6, Township 4 North, Range 25 East (W.M.)
 Well B: Located 35 feet South and 3140 feet East from the NW corner of Section 6, Township 4 North, Range 25 East (W.M.)
 Well C: Located 5 feet South and 3500 feet East from the NW corner of Section 6, Township 4 North, Range 25 East (W.M.)
 Well D: Located 475 feet South and 3540 feet East from the NW corner of Section 6, Township 4 North, Range 25 East (W.M.)
 Well E: Located 830 feet South and 3535 feet East from the NW corner of Section 6, Township 4 North, Range 25 East (W.M.)
 Well F: Located 1295 feet South and 3420 feet East from the NW corner of Section 6, Township 4 North, Range 25 East (W.M.)
 Well G: Located 1880 feet South and 3410 feet East from the NW corner of Section 6, Township 4 North, Range 25 East (W.M.)
 Well H: Located 2525 feet South and 3400 feet East from the NW corner of Section 6, Township 4 North, Range 25 East (W.M.)
 Well I: Located 2730 feet South and 2850 feet East from the NW corner of Section 6, Township 4 North, Range 25 East (W.M.)
 Well J: Located 3680 feet South and 2820 feet East from the NW corner of Section 6, Township 4 North, Range 25 East (W.M.)
 Well K: Located 45 feet South and 1610 West from the NE corner of Section 1, Township 4 North, Range 25 East (W.M.)
 Well L: Located 4360 feet South and 3940 West from the NE corner of Section 1, Township 4 North, Range 25 East (W.M.)

DISCLAIMER
 This map was prepared for the purpose of identifying the location of a water right only and it is not intended to provide legal dimensions or location of property ownership lines.

13893

RECEIVED

JAN 14 2022

OWRD

Note:
 MW-1 = MORR 52512
 MW-2 = MORR 52575

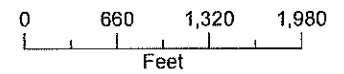
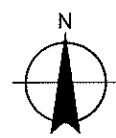

Date: September 17, 2021
 Data Sources: ESRI, Umatilla Co., Morrow Co.,
 USGS, BLM, OWRD

