

E. F. McDole
Rt 1, Box 183
Hermiston, Oregon 97838

Well # 4
Map showing well location, pipeline
and area to be irrigated.

Scale 1" = 660'

RECEIVED
NOV 19 1965
STATE ENGINEER
DIVISION

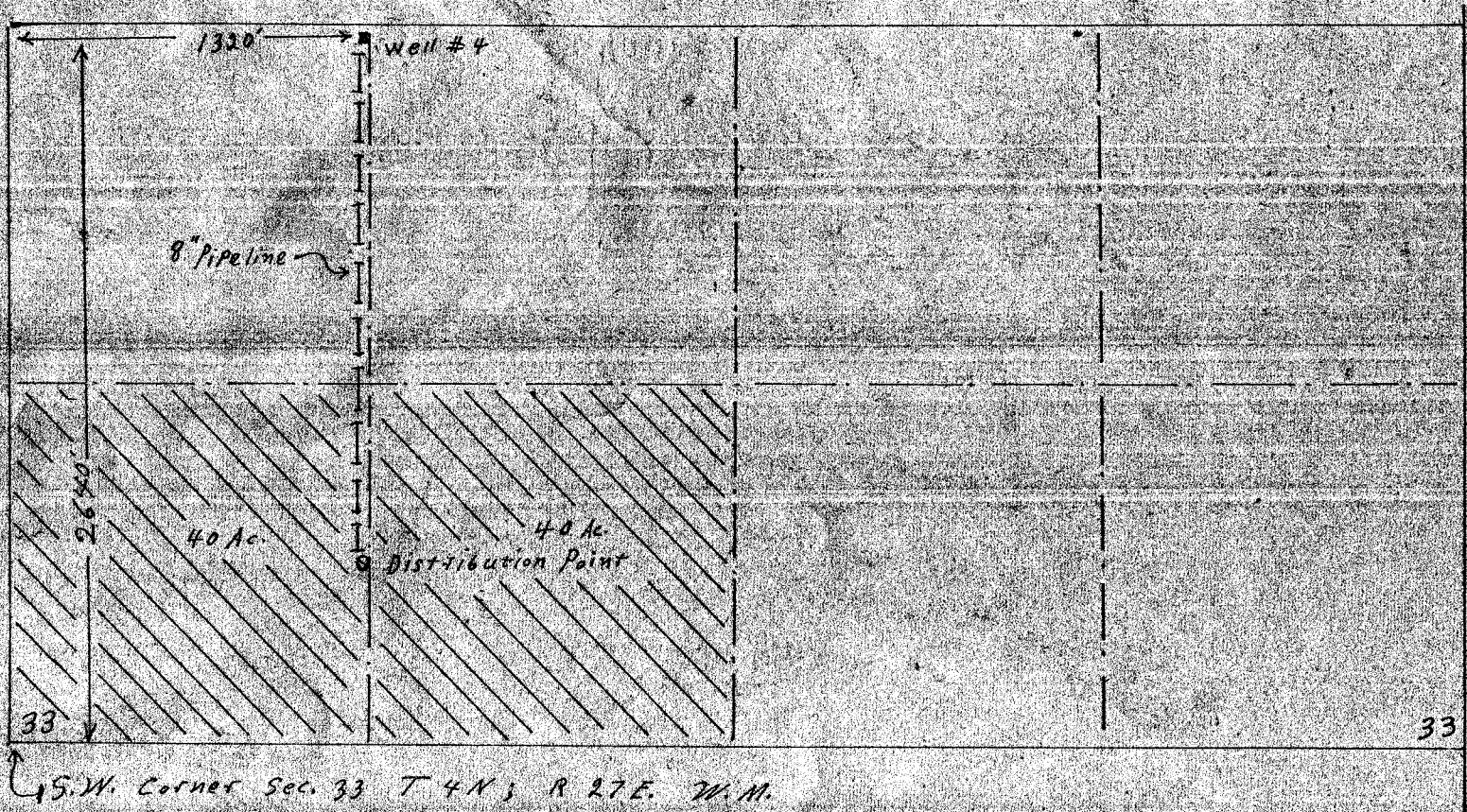

Application No. G-3029
Permit No. G-2782

G-2782
34281