

T. 4 N., R. 27 E., W. M.
MORROW COUNTY, OREGON

8

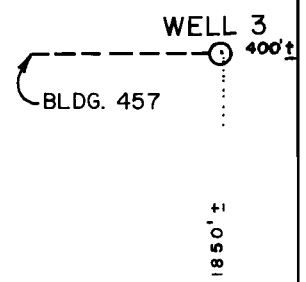

SCALE: 1" = 1,000'

DEPARTMENT OF THE ARMY
OFFICE OF THE SEATTLE DISTRICT ENGINEER
NORTH PACIFIC DIVISION

REAL ESTATE

UMATILLA ARMY DEPOT
WELL SITES 6, 7 & 3

AD

E-3010, G-3011

G-28296-282

25 NOV. '64 SH. 1 of 3

SE-RE 720.9