

T.2N.R.13E.W.M.

8

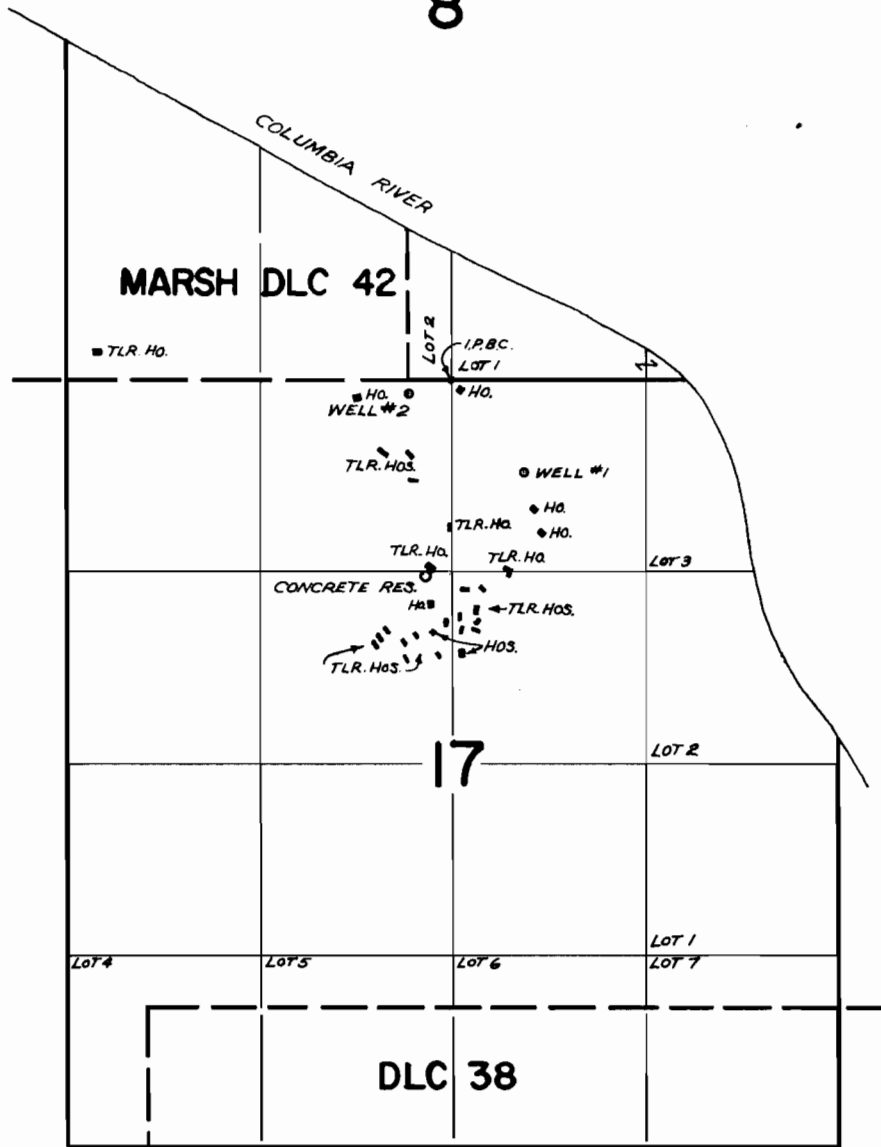

WELL #1 LOCATED 630'S. & 490'E. FROM N. 1/4 COR. OF SEC. 17
WELL #2 LOCATED 80'S. & 280'W. FROM N. 1/4 COR. OF SEC. 17
CONCRETE RES. LOCATED 1350'S. & 180'W. FROM N. 1/4 COR. OF SEC. 17

FINAL PROOF SURVEY
UNDER

Application No. G-3204 Permit No. G-2942
IN NAME OF

TOOLEY WATER DISTRICT

Surveyed OCT. 21 1970, by L.E. GOULD