

SECTION 16 T1S R3W W.M.

1S 3 16

WASHINGTON COUNTY OREGON

SCALE 1"=400'

TUALATIN RIVER

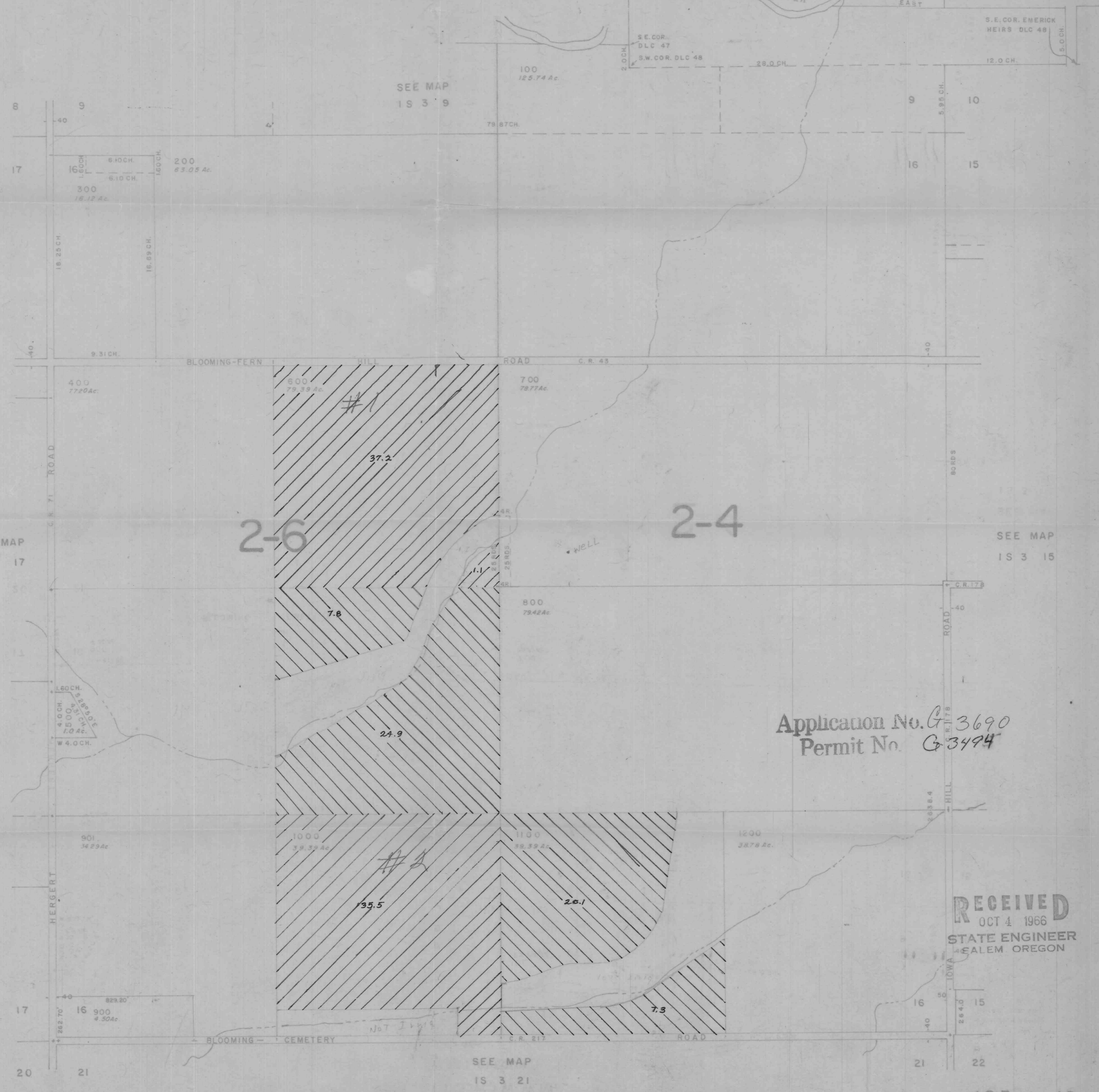

Application No. G3690
Permit No. G3494

RECEIVED
OCT 4 1966
STATE ENGINEER
SALEM OREGON

RECEIVED & PRINTED
OCT 4 1966
DEPT. OF REVENUE & TAXATION
DANIELSON BUILDING
SALEM, OREGON

5-2