

# NESIKA BEACH WATER DISTRICT MUNICIPAL WATER SYSTEM

Township	Range	Section	Forty-acre Tract	Township	Range	Section	Forty-acre Tract
36s	14w	10	SW <sup>1</sup> / <sub>4</sub> of SW <sup>1</sup> / <sub>4</sub>	36s	14w	6	NE <sup>1</sup> / <sub>4</sub> of SW <sup>1</sup> / <sub>4</sub>
36s	14w	9	S <sup>1</sup> / <sub>2</sub> of SE & <del>SW</del> S <sup>1</sup> / <sub>2</sub> of SW <sup>1</sup> / <sub>4</sub>	36s	14w	6	SW <sup>1</sup> / <sub>4</sub> of NW <sup>1</sup> / <sub>4</sub>
36s	14w	16	NE <sup>1</sup> / <sub>2</sub> of NW <sup>1</sup> / <sub>4</sub>	36s	15w	1	NE <sup>1</sup> / <sub>4</sub> of NE <sup>1</sup> / <sub>4</sub>
36s	14w	8	SE <sup>1</sup> / <sub>4</sub> of SE <sup>1</sup> / <sub>4</sub>	35s	15w	36	SE <sup>1</sup> / <sub>4</sub> of SE <sup>1</sup> / <sub>4</sub>
36s	14w	8	SW <sup>1</sup> / <sub>4</sub> of SE <sup>1</sup> / <sub>4</sub>	35s	15w	36	NE <sup>1</sup> / <sub>4</sub> of SE <sup>1</sup> / <sub>4</sub>
36s	14w	8	NE <sup>1</sup> / <sub>4</sub> of SW <sup>1</sup> / <sub>4</sub>	35s	14w	31	Entire Section
36s	14w	8	SE <sup>1</sup> / <sub>4</sub> of NW <sup>1</sup> / <sub>4</sub>	35s	14w	30	SW <sup>1</sup> / <sub>4</sub> of SW <sup>1</sup> / <sub>4</sub>
36s	14w	8	NW <sup>1</sup> / <sub>4</sub> of NW <sup>1</sup> / <sub>4</sub>	35s	14w	30	SE <sup>1</sup> / <sub>4</sub> of SW <sup>1</sup> / <sub>4</sub>
36s	14w	6	SE <sup>1</sup> / <sub>4</sub> of SE <sup>1</sup> / <sub>4</sub>	<del>36s</del> 36s	14w	17	W <sup>1</sup> / <sub>2</sub> of E <sup>1</sup> / <sub>2</sub>
36s	14w	6	NW <sup>1</sup> / <sub>4</sub> of SE <sup>1</sup> / <sub>4</sub>	35s	14w	30	SW <sup>1</sup> / <sub>4</sub> of SE <sup>1</sup> / <sub>4</sub>
36s	14w	6	SE <sup>1</sup> / <sub>4</sub> of NW <sup>1</sup> / <sub>4</sub>	36s	14w	17	NE <sup>1</sup> / <sub>4</sub> of NE <sup>1</sup> / <sub>4</sub>
36s	14w	6	NW <sup>1</sup> / <sub>4</sub> of NW <sup>1</sup> / <sub>4</sub>	36s	14w	8	SW <sup>1</sup> / <sub>4</sub> of NW <sup>1</sup> / <sub>4</sub>

REGISTERED  
**OREGON**  
LAND SURVEYOR

*Martin L. Beyerlein*

NOV. 5, 1948  
**MARTIN L. BEYERLEIN**  
247

Jan. 17, 1967

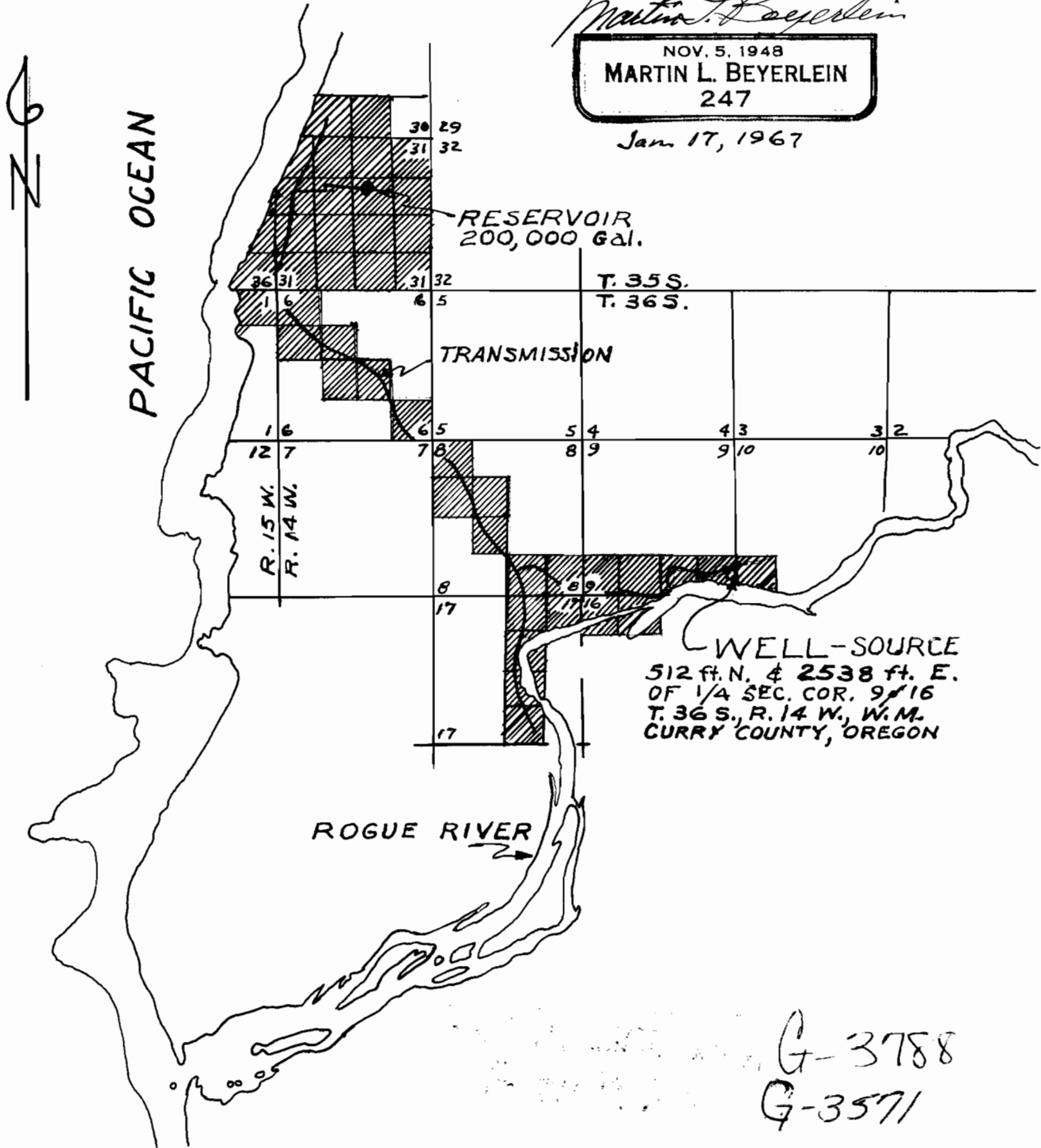

G-3788  
G-3571