

T.37S., R.6W., W.M.

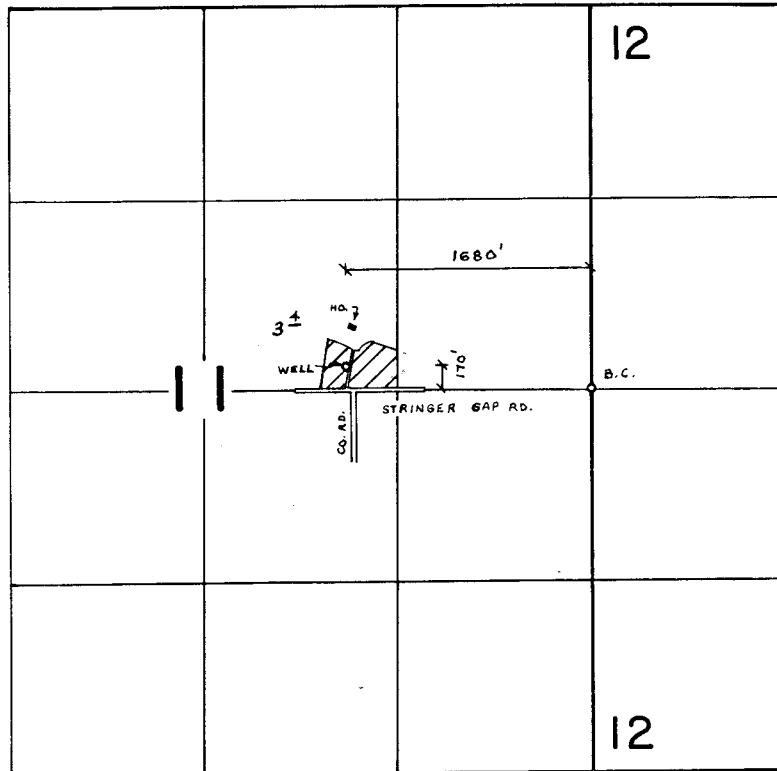

RECEIVED

OCT 1 1981

WM. DIST. 14
GRANTS PASS, ORE

FINAL PROOF SURVEY
UNDER

Application No. G-3851 Permit No. G-3627
IN NAME OF

GEORGE L. HICKMAN

Surveyed NOV. 9 1978, by B. SUND

D.H.M.

B50-2-4