

T3S R38E WM

WELL NO. 1
WELL NO. 2

530'
510'

3060'



6 5
7 8

RECEIVED
APR 11 1969
STATE ENGINEER
SALMON DIVISION

G-4823
G 4542

CITY WELLS NO.1&2 GROUND WATER PERMIT

APPLICATION MAP

SCALE
1"=1000'

DRAWN BY
R.H.H.
REVISED

DATE
4/3/69

APPROVED BY
Ronald J. Gross

DRAWING NUMBER
SUPPLEMENT "A"

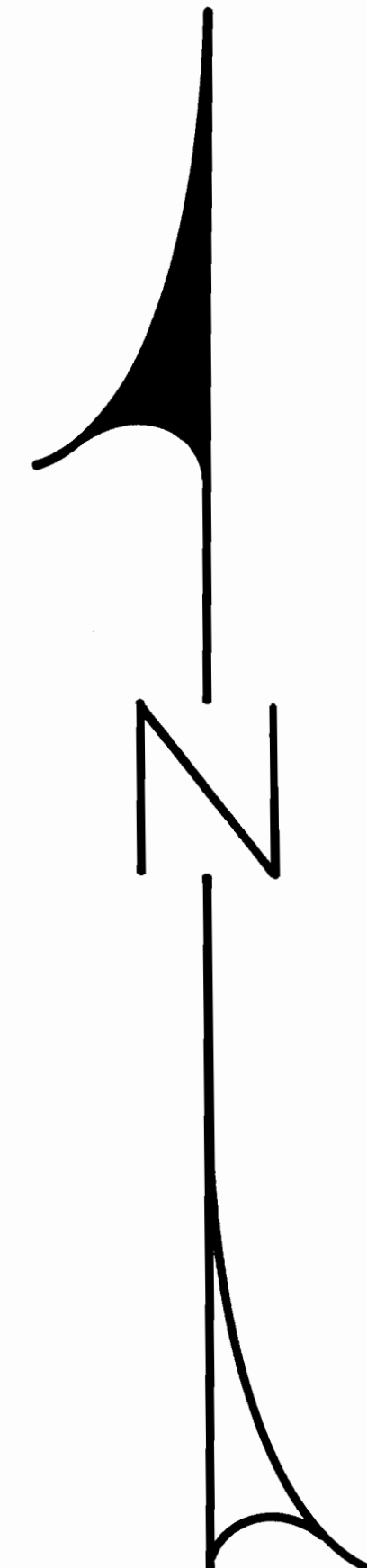
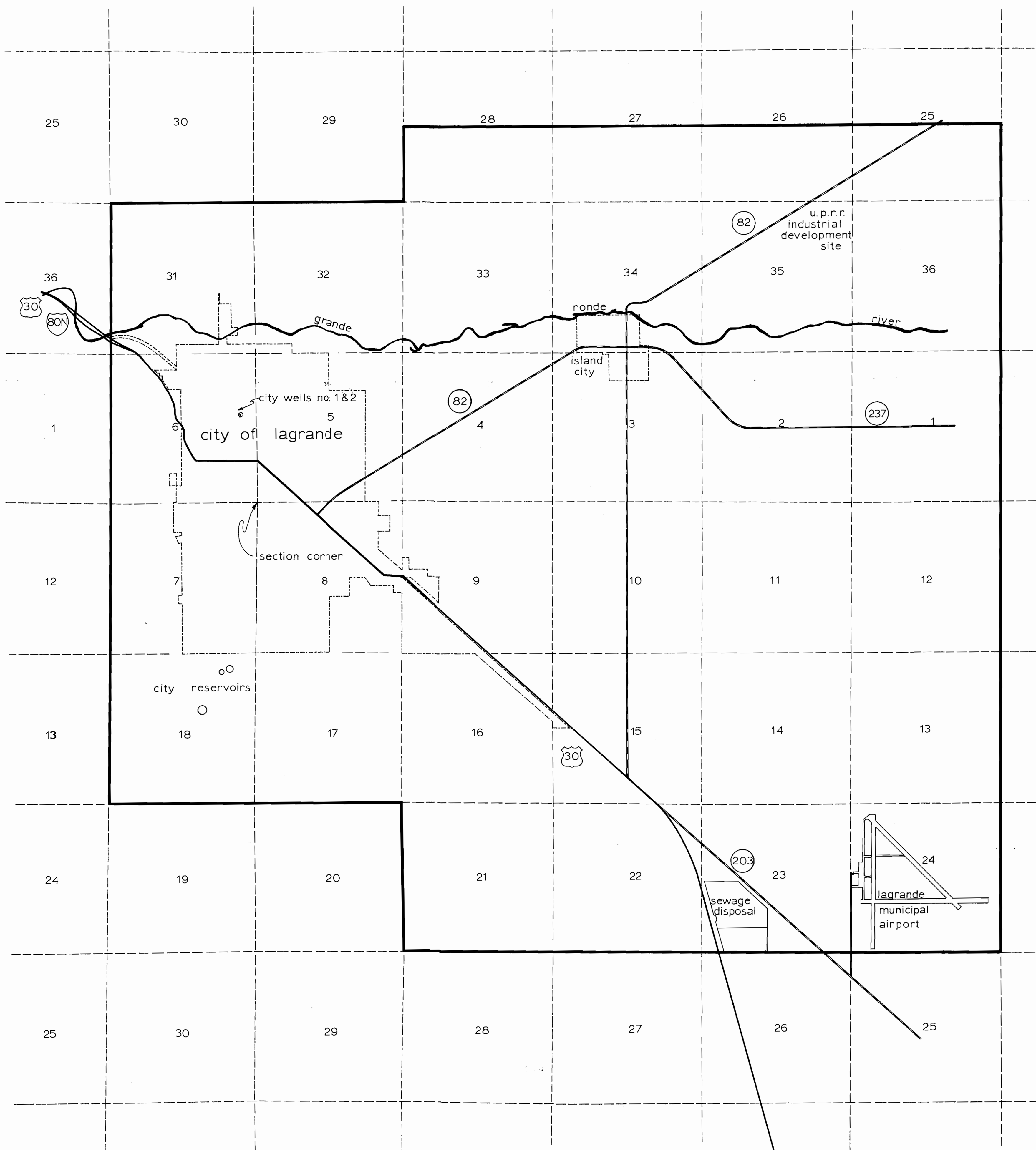

RECEIVED
 APR 11 1969
 STATE ENGINEER
 SALEM, OREGON

RECEIVED
 APR 11 1969
 STATE ENGINEER
 SALEM, OREGON

G-4823
 G-4512

CITY WELLS NO. 1 & 2 GROUND WATER PERMIT APPLICATION MAP		
SCALE: 1:2000 DATE: 2/27/69	APPROVED BY: <i>Donald Gross</i>	DRAWN BY R.H.H. REVISED
ENGINEER'S OFFICE		
CITY OF LAGRANDE LAGRANDE, OREGON		DRAWING NUMBER