

# T.4S., R.1W., W.M.

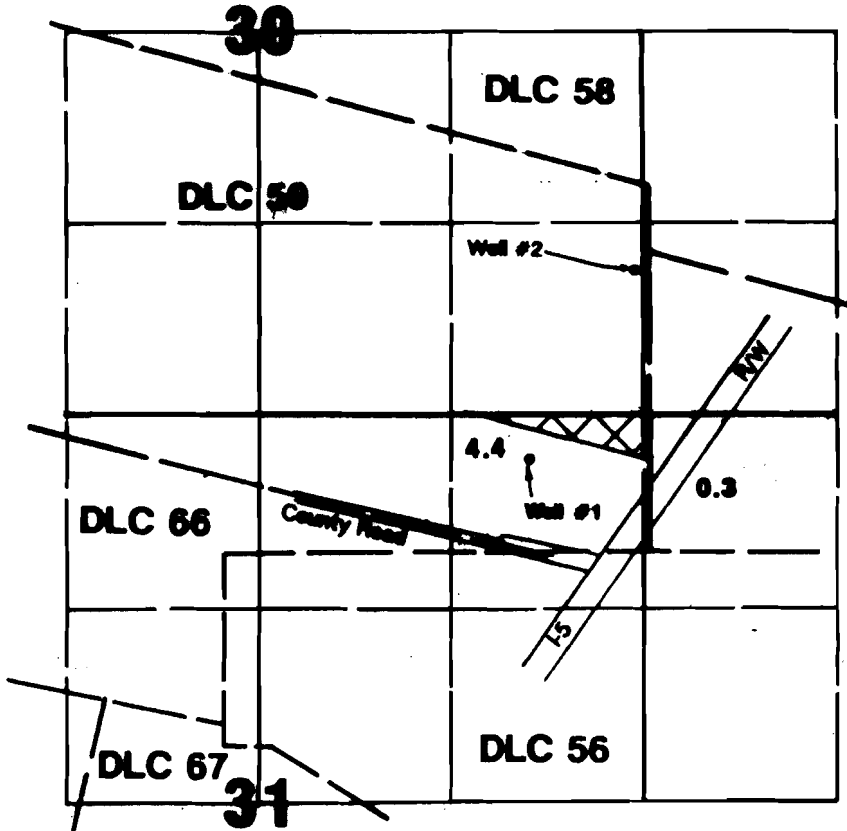

Well #2 (add'l POA) located 1000'N & 50'W from SE corner Section 30.  
 Well #1 located 607'N & 12'W from SE corner DLC 66.

*812'  
 AL  
 8/16/2005*

**RECEIVED**

JAN 29 1996

WATER RESOURCES DEPT.  
 SALEM, OREGON

**Final Proof Survey**

**Transfer: T-6488**

In Name Of

**Jesse C. Owre**

Surveyed on December 5, 1985 by J.M. Schuette

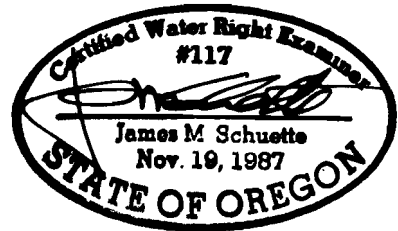

THIS MAP WAS PREPARED FOR THE PURPOSE OF IDENTIFYING THE LOCATION OF A WATER RIGHT ONLY AND IS NOT INTENDED TO PROVIDE LEGAL DIMENSIONS OR LOCATION OF PROPERTY OWNERSHIP LINES.