

**RECEIVED**

MAY 11 1970

STATE ENGINEER  
SALEM OREGON

**RECEIVED**

AUG 4 1970

STATE ENGINEER  
SALEM, OREGON

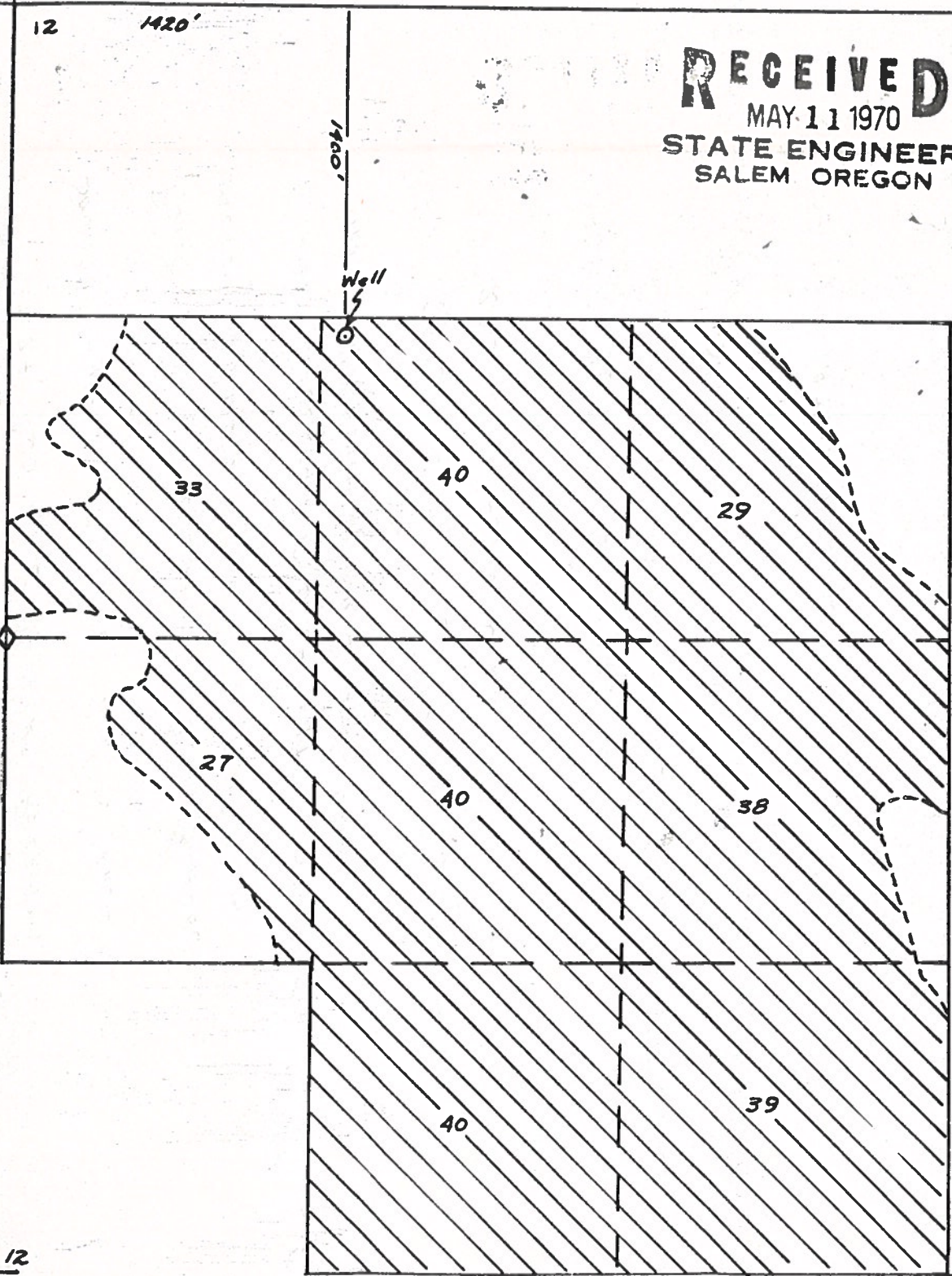

Application No. G-5190  
Permit No. G-5060

Scale 1" = 660'  
8" = 1 mi.

LONE PINE RANCH  
T-500 P.O.F. WM

Application No. G-5190

2 1  
11 12  
12 13

1  
12  
12  
13