

T. 35 S., R. 6 W., W.M.

RECEIVED

FEB 23 1979

WM. DIST. 14
GRANTS PASS, ORE

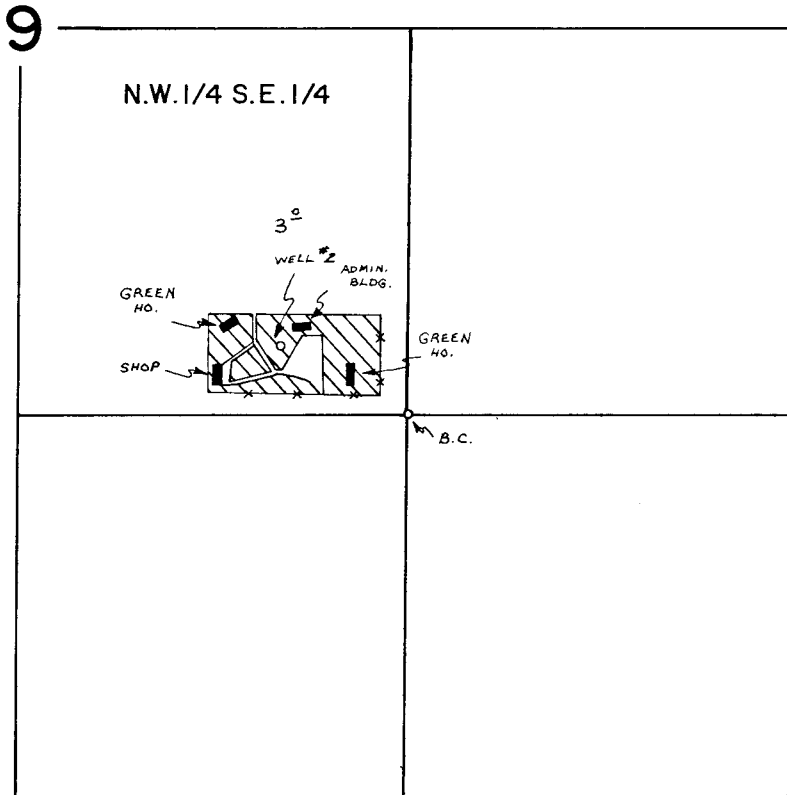

WELL LOC.: 230' N. & 430' W. FROM S.E. COR., N.W. 1/4 S.E. 1/4, SEC. 9.

SCALE: 1" = 660'

FINAL PROOF SURVEY
UNDER

Application No. G-5363 Permit No. G-5299
IN NAME OF

BUREAU OF LAND MANAGEMENT

Surveyed DEC. 7 1977, by B. SUND

D.H.M.
PTS - 1977-14-B