

T.27S. R.19E. W.M.

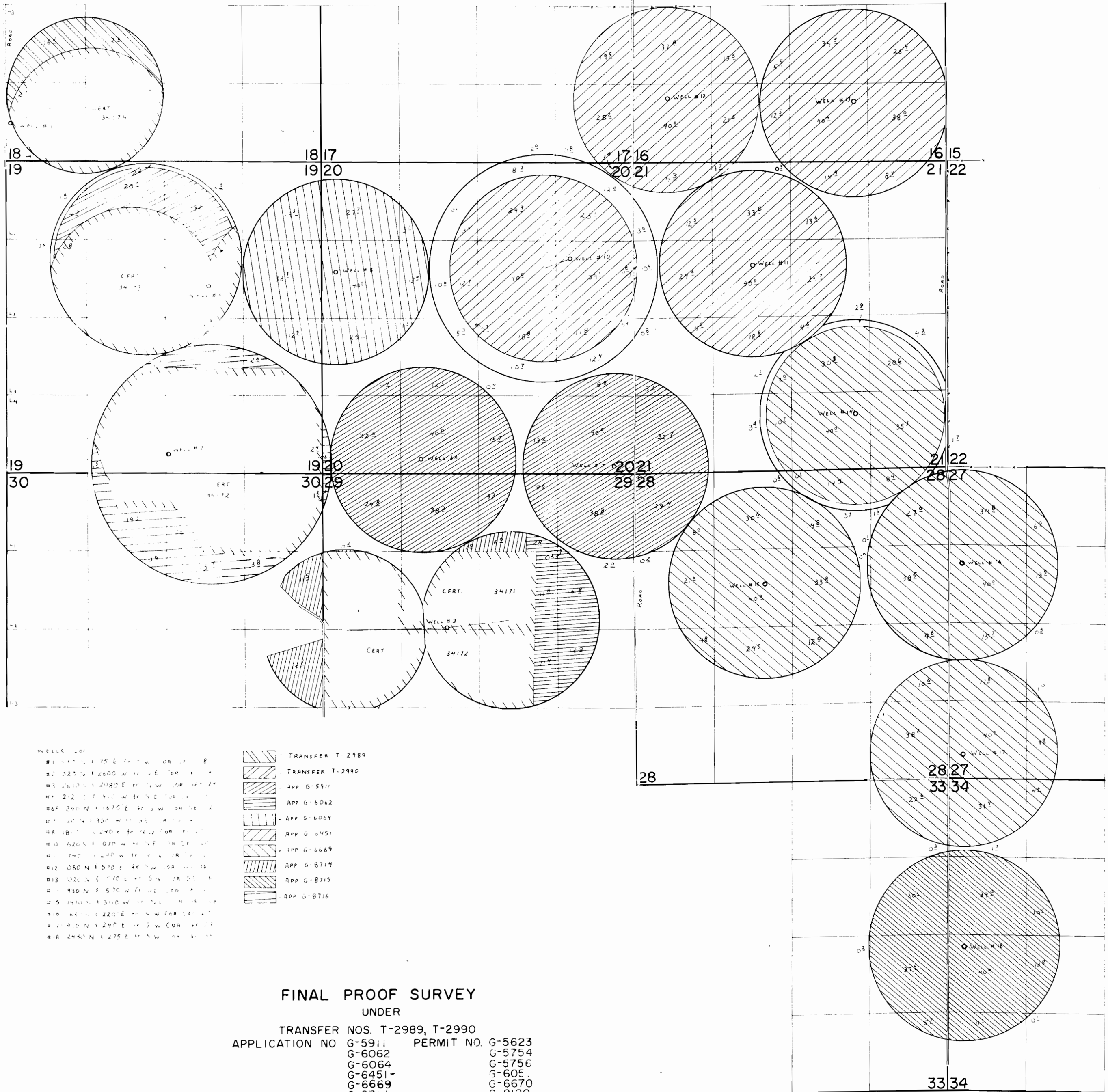

WELLS LOG
 #1 147' N 75° E 34' W OR SP. E.
 #2 327' N 126° 00' W 12' E OR SP. E.
 #3 261' N 120° 00' E 11' W OR SP. E.
 #4 222' N 71° 40' W 10' E OR SP. E.
 #6 250' N 116° 00' E 10' W OR SP. E.
 #7 20' N 130° W 10' E OR SP. E.
 #8 185' N 124° 00' E 11' W OR SP. E.
 #9 420' S 07° 00' W 11' E OR SP. E.
 #10 740' S 140° W 10' E OR SP. E.
 #12 080' N 05° 00' E 10' W OR SP. E.
 #13 1020' S 07° 00' E 11' W OR SP. E.
 #14 130' N 05° 57' W 11' E OR SP. E.
 #15 1170' N 131° 00' W 11' E OR SP. E.
 #16 645' S 22° 00' E 11' W OR SP. E.
 #17 40' N 124° 00' E 11' W OR SP. E.
 #18 245' N 127° 00' E 11' W OR SP. E.

- TRANSFER T-2989
- TRANSFER T-2990
- APP G-5911
- APP G-6062
- APP G-6064
- APP G-6451
- APP G-6669
- APP G-8714
- APP G-8715
- APP G-8716

FINAL PROOF SURVEY
 UNDER

TRANSFER NOS. T-2989, T-2990
 APPLICATION NO G-5911 PERMIT NO. G-5623
 G-6062 G-5754
 G-6064 G-575C
 G-6451 G-60E
 G-6669 G-6670
 G-8714 G-8120
 G-8715 G-8121
 G-8716 G-8122

IN NAME OF

ALDER CREEK RANCH

SURVEYED AUG. 26, 1979, by C. L. HUGHES

T.27S.R.18&19E.W.M.

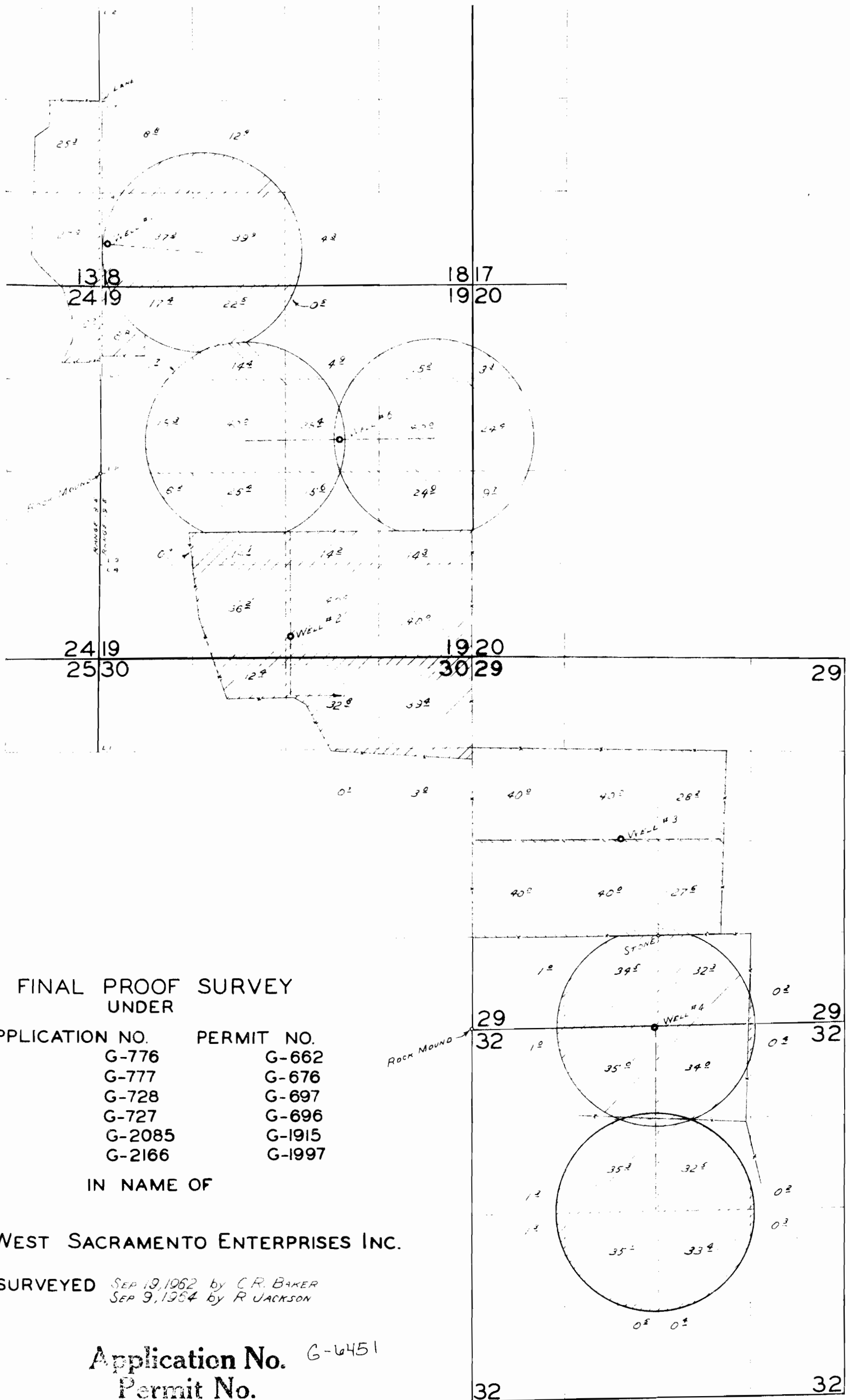

FINAL PROOF SURVEY
UNDER

APPLICATION NO.	PERMIT NO.
G-776	G-662
G-777	G-676
G-728	G-697
G-727	G-696
G-2085	G-1915
G-2166	G-1997

IN NAME OF

WEST SACRAMENTO ENTERPRISES INC.

SURVEYED *SEP 19, 1962 by C.R. BAKER*
SEP 9, 1954 by R. JACKSON

Application No. G-6451
Permit No.