

RECEIVED

NOV 14 1974

STATE ENGINEER  
SALEM, OREGON

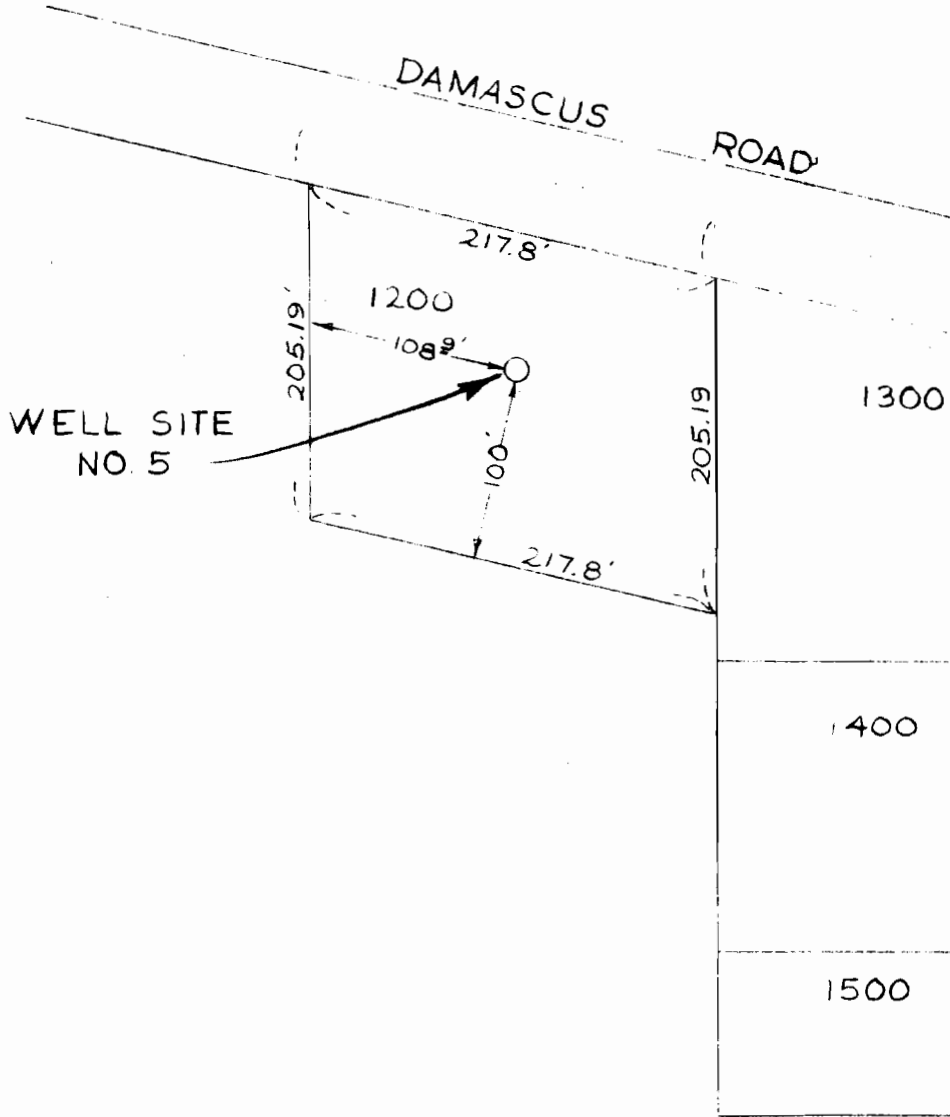

WELL SITE  
NO. 5

Section 6, T.2S. R3E. WM.  
Clackamas County

Application No. G6723  
Permit No. G 6079

REVISIONS

**CARTER, BRINGLE & ASSOC.**  
CONSULTING ENGINEERS  
1204 OREGON BANK BLDG PORTLAND, OREGON

**DAMASCUS  
WATER DISTRICT**

**WELL SITE NO.5**

DATE 3-16-73 SCALE 1"=100' 363-047

12817 (A)