

T. 40 S., R. 7 W., W.M.

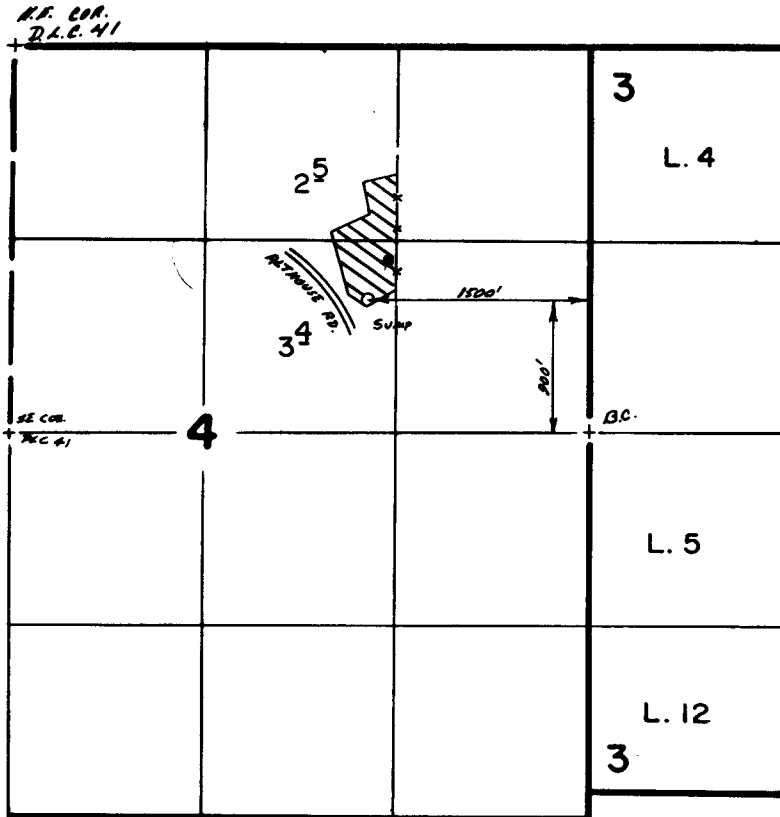

Scale: 1" = 1320'

MAY 3 1988

FINAL PROOF SURVEY
UNDER

Application No. G-6747 Permit No. G-6270
IN NAME OF

CELESTA A. YEOMAN

Surveyed MAY 6, 1986, by B. S. JAMES

W.M. DIST. 14
GRANTS PASS, OK