

RECEIVED

05471
6-338
6-645
6-646
6-647
6-648

FEB 6 1987

WATER RESOURCES DEPT.
SALEM, OREGON

T.2N.R.13E.W.M.

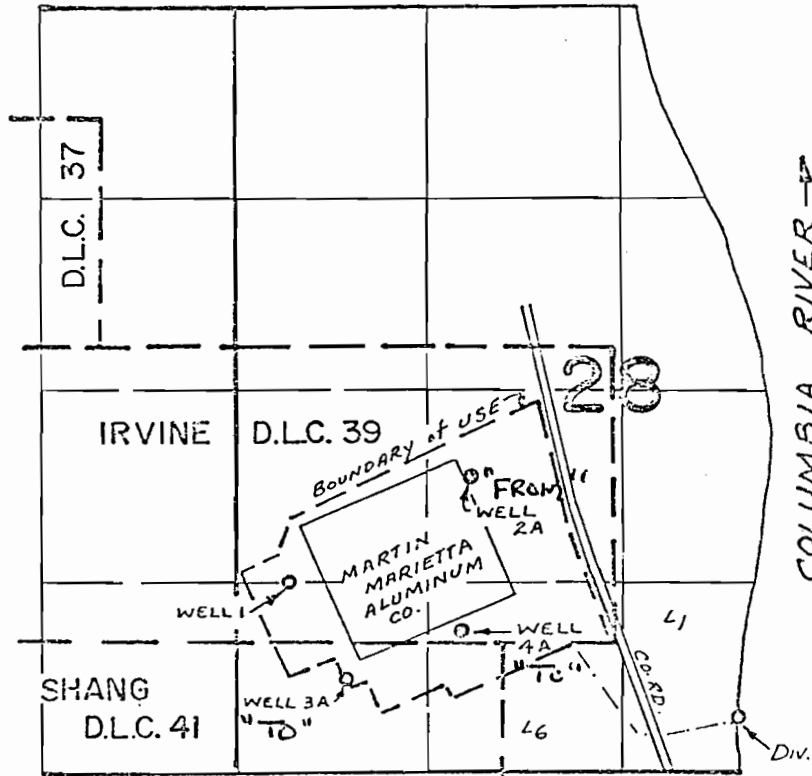

DIV. PTS. LOC: RIVER - 380' N. & 780' E.
 WELL 1 - 1320' N & 2260' W,
 WELL 2A - 2020' N & 1030' W,
 WELL 3A - 640' N & 1680' W,
 WELL 4A - 970' N & 1030' W, ALL FROM S 1/4
 COR. SEC. 28

FINAL PROOF SURVEY

37388	27829
32400	25977
G-471	G-338
G-734	G-645
G-735	G-646
G-736	G-647
G-737	G-648

Application No. G-737 Permit No. G-648
 IN NAME OF

MARTIN MARIETTA ALUMINUM CO.

Surveyed MAR. 23, 1973, by TOM PAUL