

T. 37 S., R. 5 & 6 W., W.M.

RECEIVED

JUL 7 1982

WM. DIST. 14
BEAVERS PASS, ORE

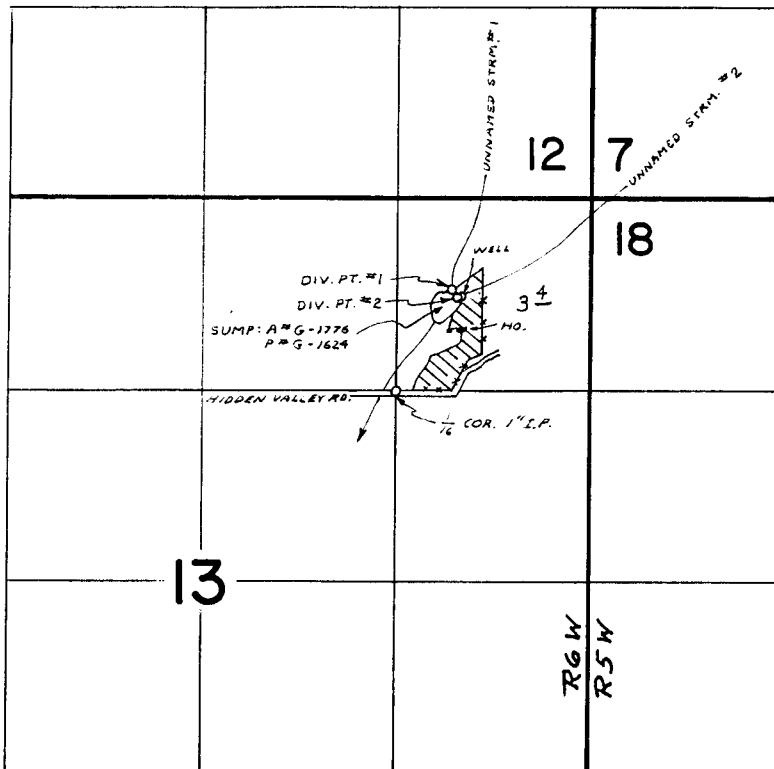

WELL LOC.: 670'S f 870'W FROM NE COR. SEC. 13
 DIV. PT. #1 LOC.: 620'S f 990'W FROM NE COR. SEC. 13
 DIV. PT. #2 LOC.: 680'S f 890'W FROM NE COR. SEC. 13

FINAL PROOF SURVEY
 UNDER

G-7171 G-6610 SUPPL.
 Application No. 55596 Permit No. 41662 SUPPL.
 IN NAME OF

..... DON T. & MARILYN J. WADE

Surveyed OCT. 14 77 by B. SUND
 19.....

P.T.S. -1977-14 - B