

T.37 & 38S., R.5W., W.M.

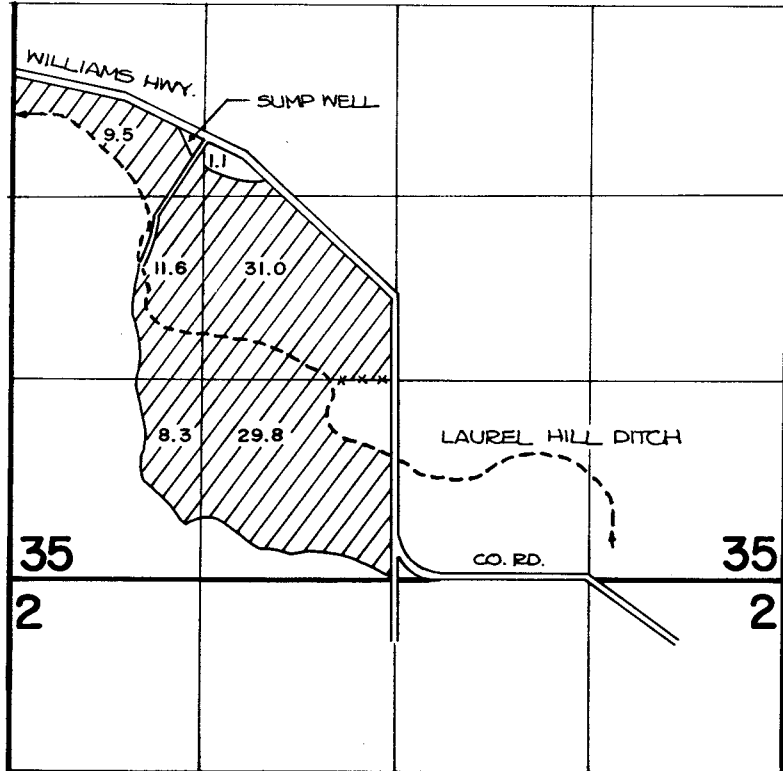

SUMP WELL IS LOCATED 310' N. AND 1400' W. FROM THE CENTER OF SECTION 35.

FINAL PROOF SURVEY
UNDER

Application No. G-7264 Permit No. G-6660
IN NAME OF

LYLE WOODCOCK

Surveyed APR. 28 1983, by B. JAMES