

T.27S. R.19E. WM.

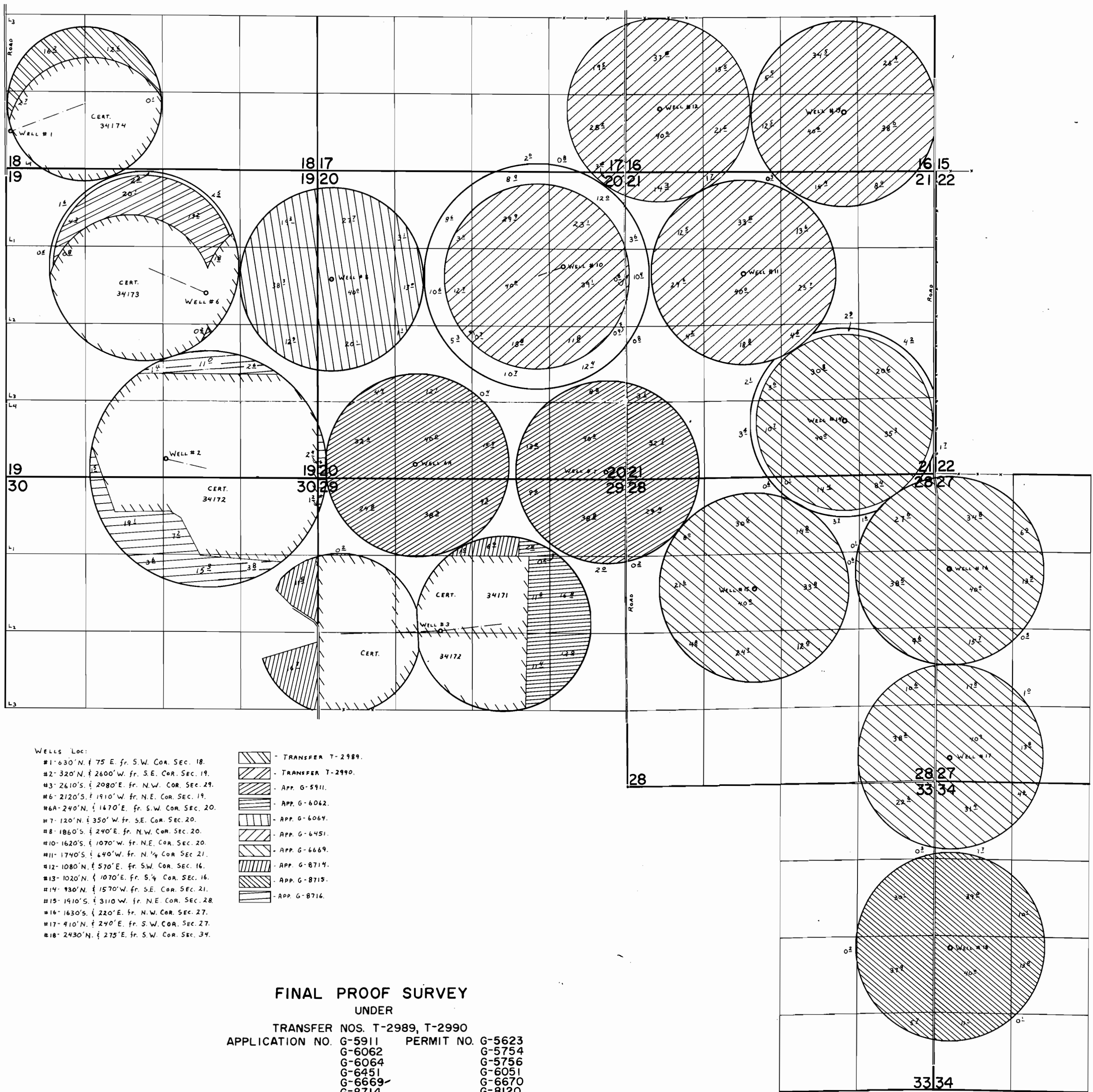

- WELLS LOC:
- #1- 630' N. § 75' E. fr. S.W. COR. SEC. 18.
  - #2- 320' N. § 2600' W. fr. S.E. COR. SEC. 19.
  - #3- 2610' S. § 2080' E. fr. N.W. COR. SEC. 29.
  - #6- 2120' S. § 1910' W. fr. N.E. COR. SEC. 19.
  - #6A- 240' N. § 1670' E. fr. S.W. COR. SEC. 20.
  - #7- 120' N. § 350' W. fr. S.E. COR. SEC. 20.
  - #8- 1860' S. § 240' E. fr. N.W. COR. SEC. 20.
  - #10- 1620' S. § 1070' W. fr. N.E. COR. SEC. 20.
  - #11- 1740' S. § 640' W. fr. N. ¼ COR. SEC. 21.
  - #12- 1080' N. § 570' E. fr. S.W. COR. SEC. 16.
  - #13- 1020' N. § 1070' E. fr. S. ¼ COR. SEC. 16.
  - #14- 930' N. § 1570' W. fr. S.E. COR. SEC. 21.
  - #15- 1910' S. § 3110' W. fr. N.E. COR. SEC. 28.
  - #16- 1630' S. § 220' E. fr. N.W. COR. SEC. 27.
  - #17- 910' N. § 290' E. fr. S.W. COR. SEC. 27.
  - #18- 2430' N. § 275' E. fr. S.W. COR. SEC. 39.

- TRANSFER T-2989.
- TRANSFER T-2990.
- APP. G-5911.
- APP. G-6042.
- APP. G-6064.
- APP. G-6451.
- APP. G-6669.
- APP. G-8714.
- APP. G-8715.
- APP. G-8716.

**FINAL PROOF SURVEY**  
 UNDER  
 TRANSFER NOS. T-2989, T-2990  
 APPLICATION NO. G-5911 PERMIT NO. G-5623  
 G-6062 G-5754  
 G-6064 G-5756  
 G-6451 G-6051  
 G-6669 G-6670  
 G-8714 G-8120  
 G-8715 G-8121  
 G-8716 G-8122

IN NAME OF

ALDER CREEK RANCH

SURVEYED AUG. 26, 1979, by C. L. HUGHES