

T16S. R43E. WM.

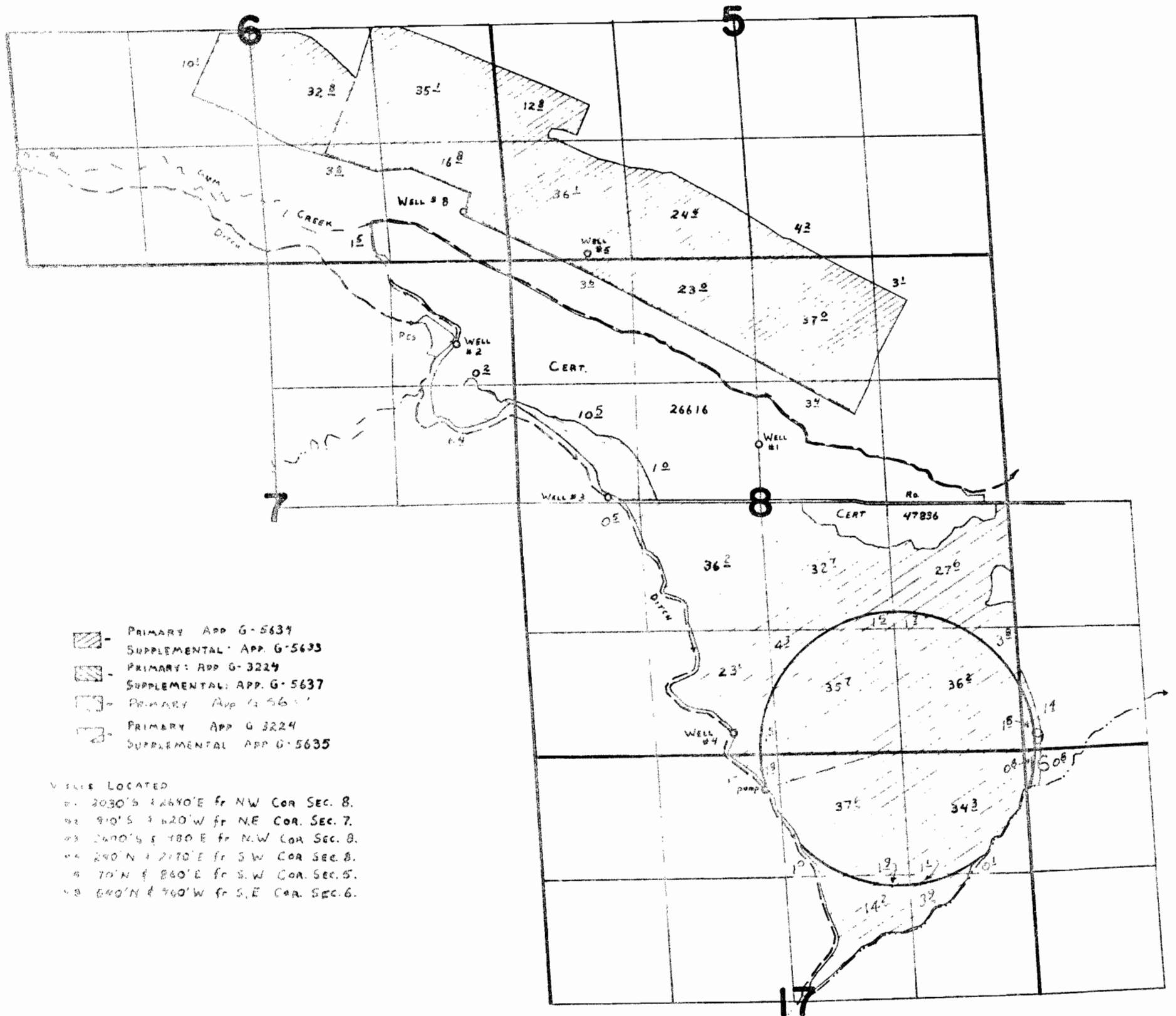

- PRIMARY APP G-5634
SUPPLEMENTAL APP G-5633
- PRIMARY APP G-3224
SUPPLEMENTAL APP G-5637
- PRIMARY APP G-5635
- PRIMARY APP G-3224
SUPPLEMENTAL APP G-5635

WELLS LOCATED

- #1 2030'S 42640'E fr NW COR SEC. 8.
- #2 910'S 31620'W fr NE COR SEC. 7.
- #3 2490'S 1780'E fr NW COR SEC. 8.
- #4 240'N 2710'E fr SW COR SEC. 8.
- #5 70'N 860'E fr S.W. COR. SEC. 5.
- #8 640'N 760'W fr S.E. COR. SEC. 6.

FINAL PROOF SURVEY UNDER

| | | |
|------------------|--------|--------------------|
| | G-5633 | G-6719 |
| | G-5634 | G-6720 |
| | G-5635 | G-6721 |
| Application Nos. | G-5637 | Permit Nos. G-6723 |
| | G-3224 | G-3167 |

IN NAME OF

**GUM CREEK FARMS, INC. &
KANSAS CITY LIFE INS CO**

Surveyed AUG. 6 1979, by C. L. HUGHES
SEPT 20