

**FINAL PROOF SURVEY**  
 UNDER

G-8953  
 G-7182

G-8323  
 G-6803

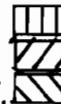

PRIORITY, SEPT. 28, 1978

Application No. G-11127 Permit No. G-10507

IN NAME OF

.....PINE HOLLOW DEVELOPMENT CORP.....

Surveyed ..... 19....., by .....

T.4S.,R.12E.,W.M.

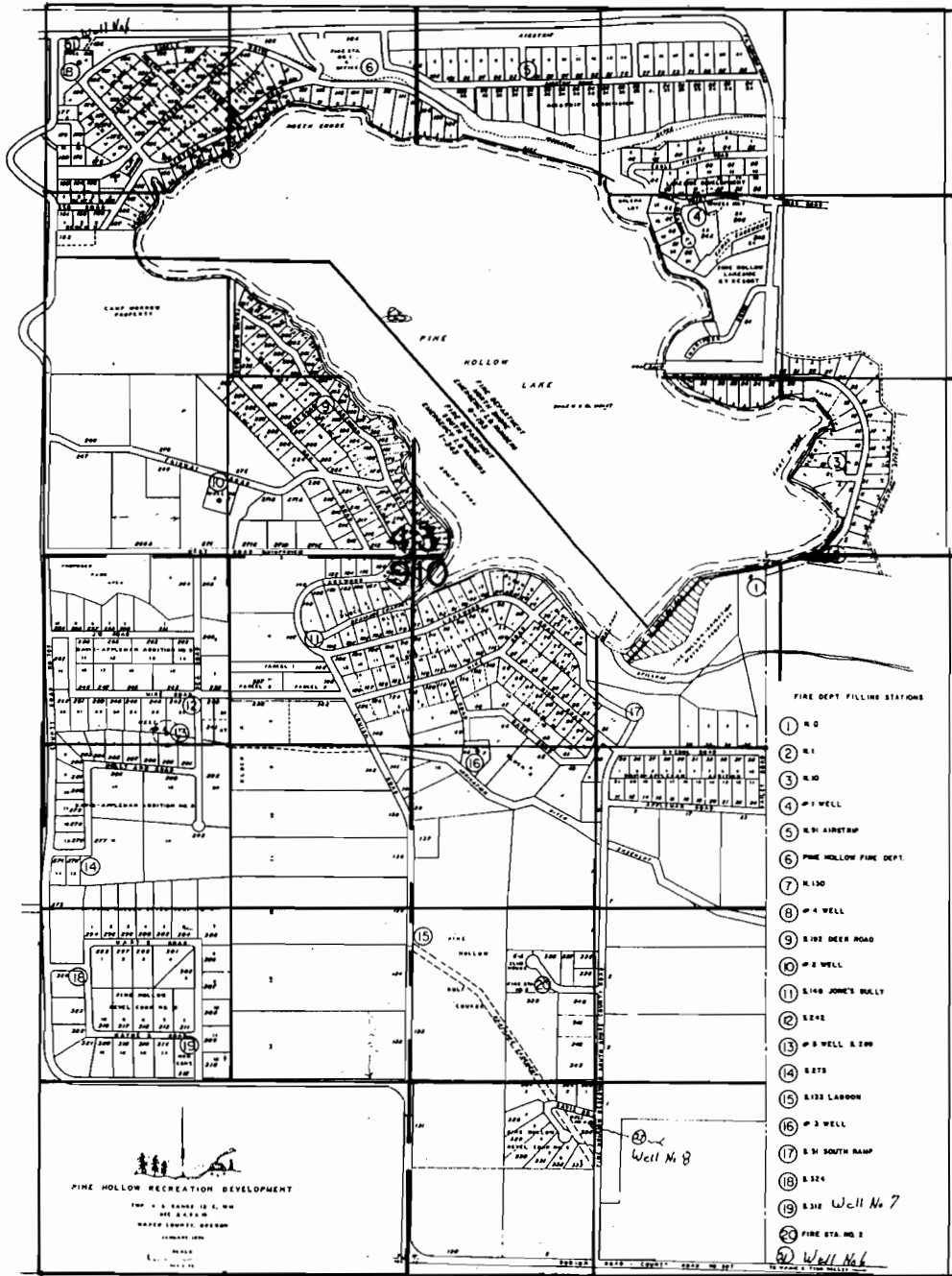

SCALE: 1" = 1320'

# FINAL PROOF SURVEY UNDER

G- 7182                      G- 6803  PRIORITY, DEC.16,1975  
 Application No. G-11127    Permit No. G-10507  PRIORITY, JULY12,1984  
 IN NAME OF

PINE HOLLOW DEVELOPMENT CORP.

Surveyed JUNE 28 1995, by R.M.SUTTERFIELD