

T.12S., R.4&5W., W.M.

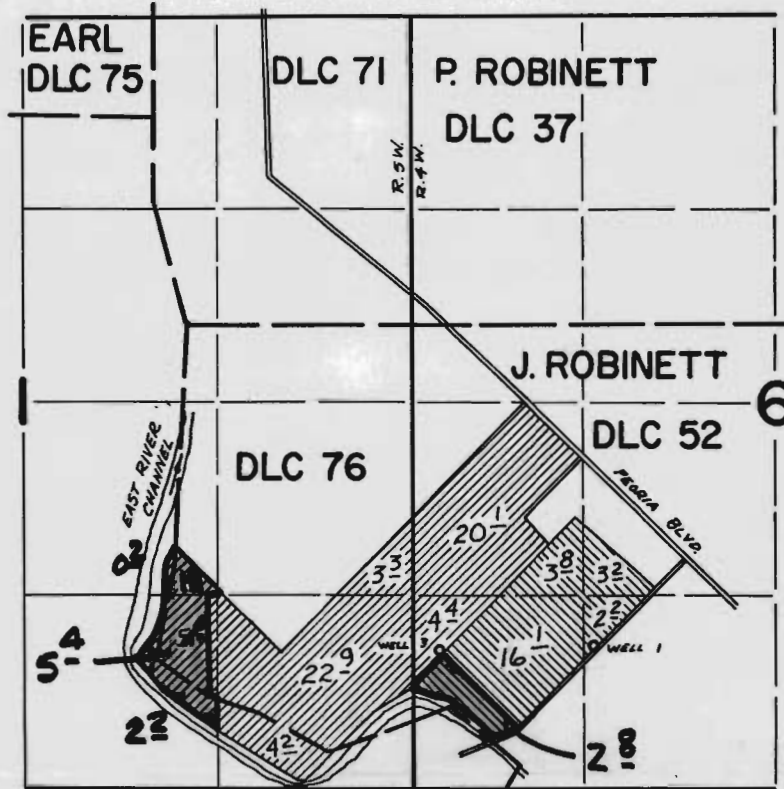

WELLS LOCATES: 1-3600'S & 3000'E; 3-3630'S & 1950'E FROM SE COR. EARL DLC 75.

Application No. G-7431

Permit No. G 6929

FINAL PROOF SURVEY
UNDER

RECEIVED
JUL 13 1976

WATER RESOURCES DEPT
SALEM, OREGON

Application No. G-4957 Permit No. G-4678
IN NAME OF

MERLE R. AND LORRAINE SMITH

Surveyed May 1 1974, by D.M. Norby