

WALLACE CUSHMAN D.L.C. 67

RECEIVED

MAY 28 1976

WATER RESOURCES DEPT  
SALEM, OREGON

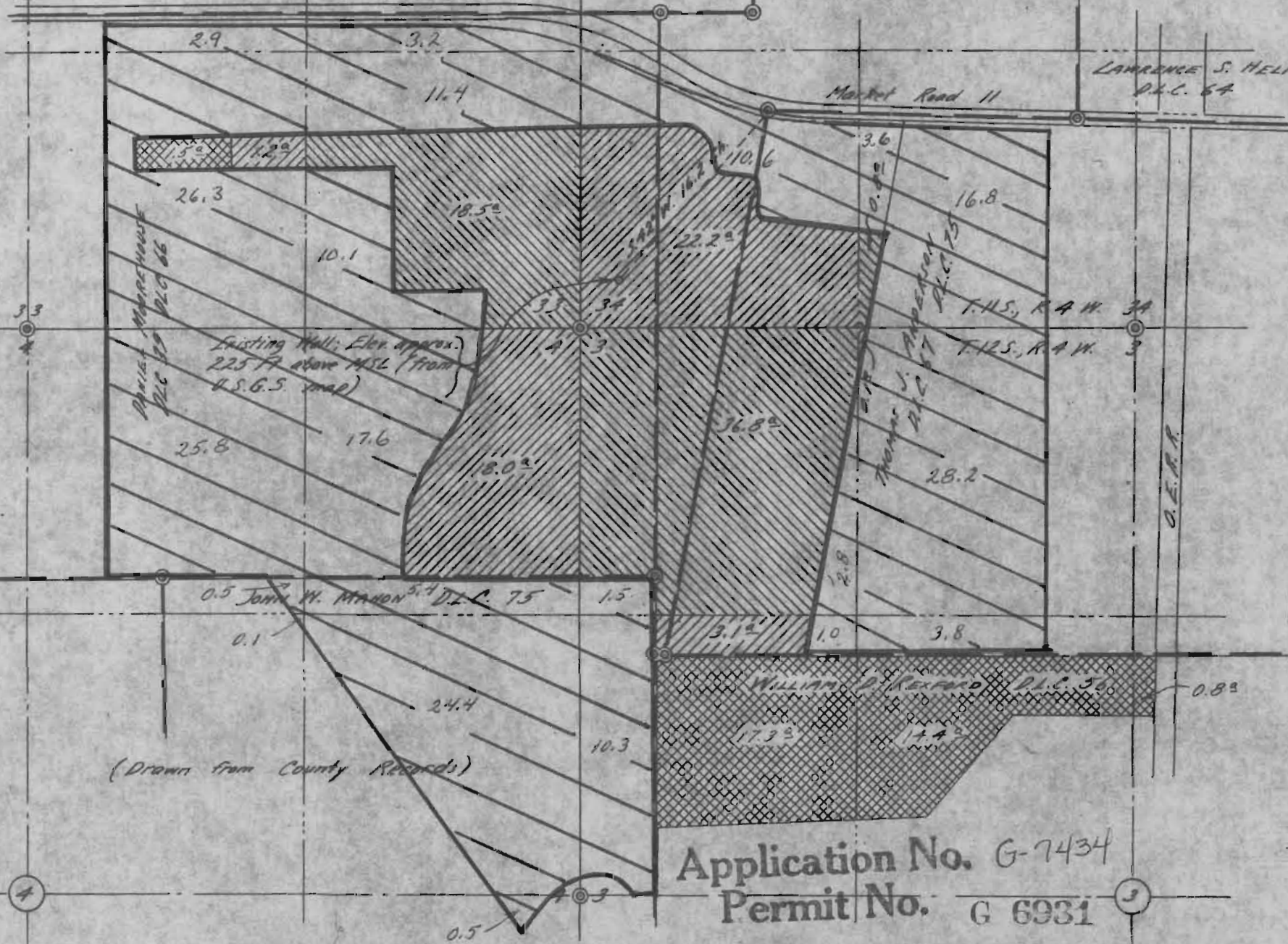

LAWRENCE S. HELM  
D.L.C. 64

W.R. 468

**JOHN & LETHA GLASER**  
SEC. 33 & 34, T. 11 S., R. 4 W., W.M.  
SEC. 3 & 4, T. 12 S., R. 4 W., W.M.  
LINN CO., ORE.

Scale: 1" = 10 Chains April 25, 1957

ORRIS A. CARNEGIE  
DEP. CO. SURVEYOR

1st revision: Dec. 28, 1960

REGISTERED  
OREGON  
LAND SURVEYOR

*Oris A. Carnegie*

MAY 5, 1947  
ORRIS A. CARNEGIE  
213

Note: Double crosshatching indicates area being filed upon by this 1st Revision; (Single crosshatched area has been filed upon previously.)

Application No. G-7434  
Permit No. G 6931

RECEIVED

JUL 15 1976

WATER RESOURCES DEPT  
SALEM, OREGON