

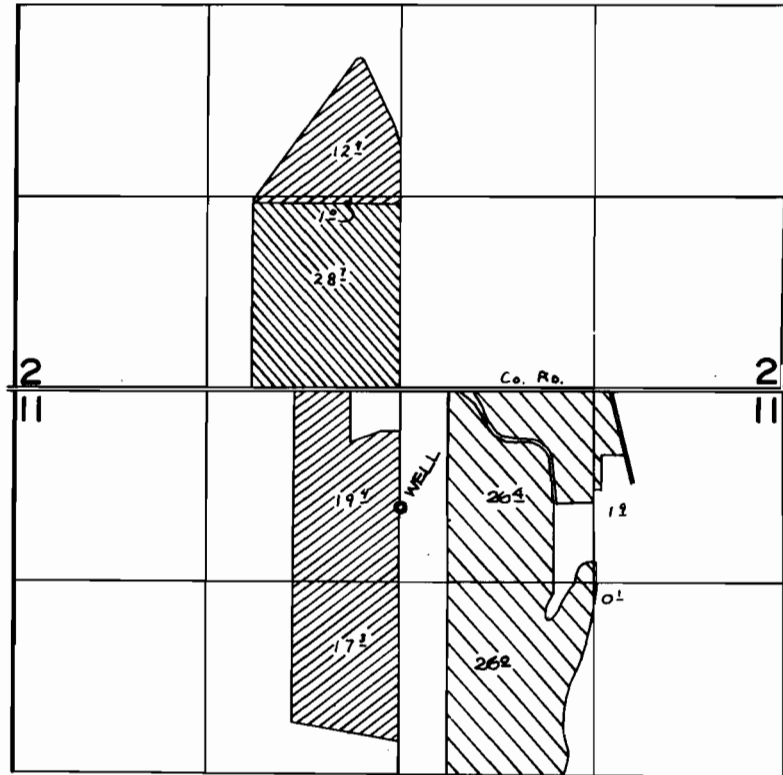



T.6S. R.1W. W.M.



WELL Loc: 820'S. / 20'E. fr. N. 1/4 Cor. Sec. 11.

-  - PRIMARY IRR.
-  - SUPPLEMENTAL TO GR CERT. 168.
-  - SUPPLEMENTAL TO CERT. 30707

FINAL PROOF SURVEY UNDER

Application No. G-7883. Permit No. G-7296...
IN NAME OF

ROBERT A. DUDA & DICKMAN FARMS, INC.

Surveyed July 9, 1980, by C.L. Hughes.....