

RECEIVED

OCT 10 1977

WATER RESOURCES DEPT.
SALEM, OREGON

N.E. Cor. Gov't Lot 3

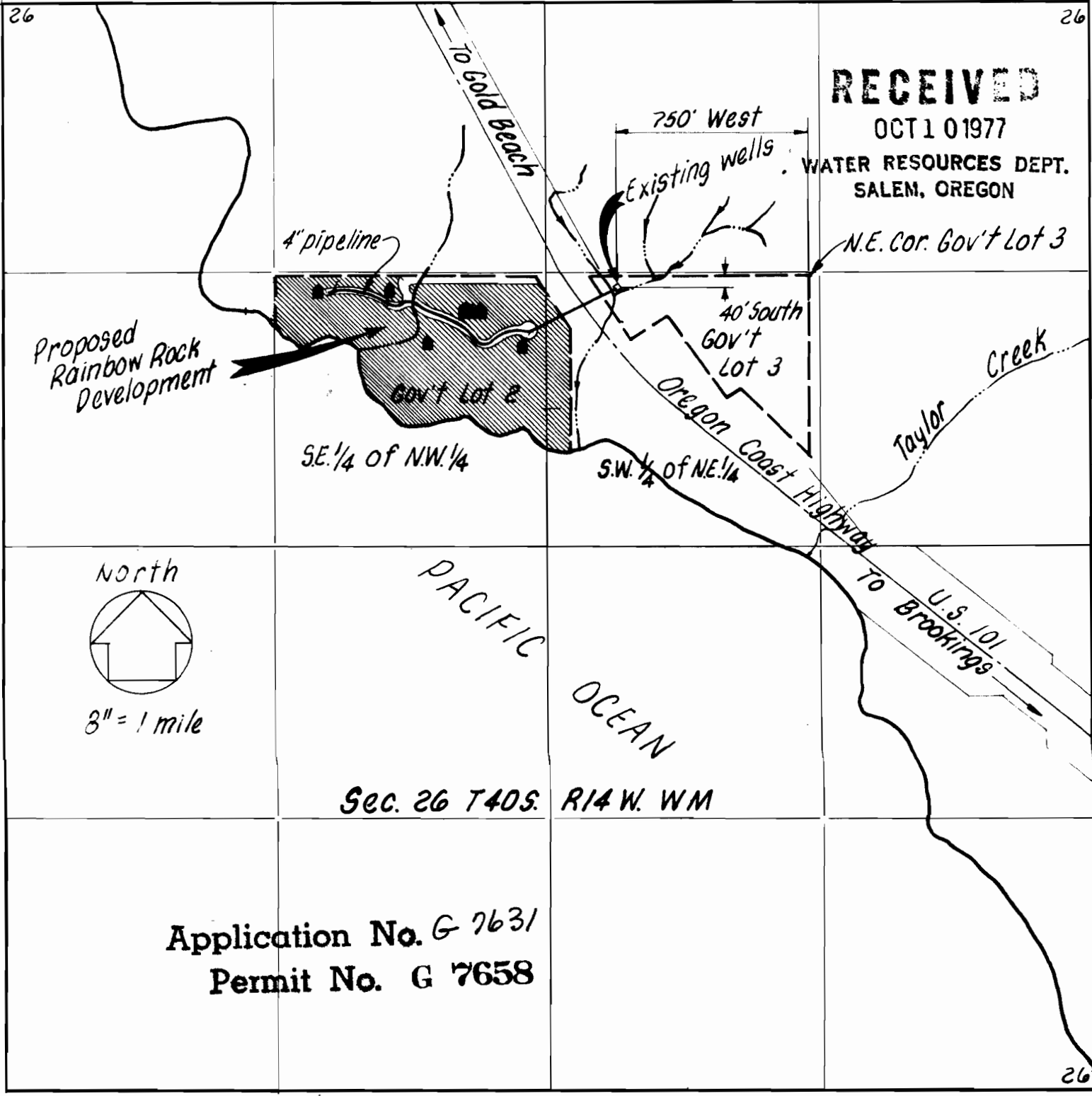

SE 1/4 of NW 1/4

S.W. 1/4 of NE 1/4

North

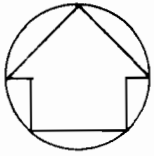

3" = 1 mile



PACIFIC

OCEAN

Sec. 26 T40S. R14 W. WM

Application No. G 7631
Permit No. G 7658

APPLICATION MAP FOR GROUND WATER USAGE RAINBOW ROCK DEVELOPMENT

-  Condominiums
-  Motel - Restaurant

RECEIVED
OCT 10 1977
WATER RESOURCES DEPT.
SALEM, OREGON

| | | |
|---|---------------|--------------------------------------|
| SCALE: NOTED | DATE: 8-19-77 | JOB NO: 1260 |
| MARQUSS & ASSOCIATES, INC. 12 GOLDBY BLDG. MEDFORD, OREGON 772-7115 | | DES: _____ DR: C.R. CN: CBS-LR |