

COUNTY SEAT OF SHERMAN CO.
OREGON

TWP. 15. R. 17 E.
Scale: 300 ft. to 1 inch.

Copyright 1913 by Geo. A. Ogle & Co.

Section 18 + 17.

Eastern Oregon Land Co.

H. W. Strong.

Application No. 68292
Permit No. G 7815

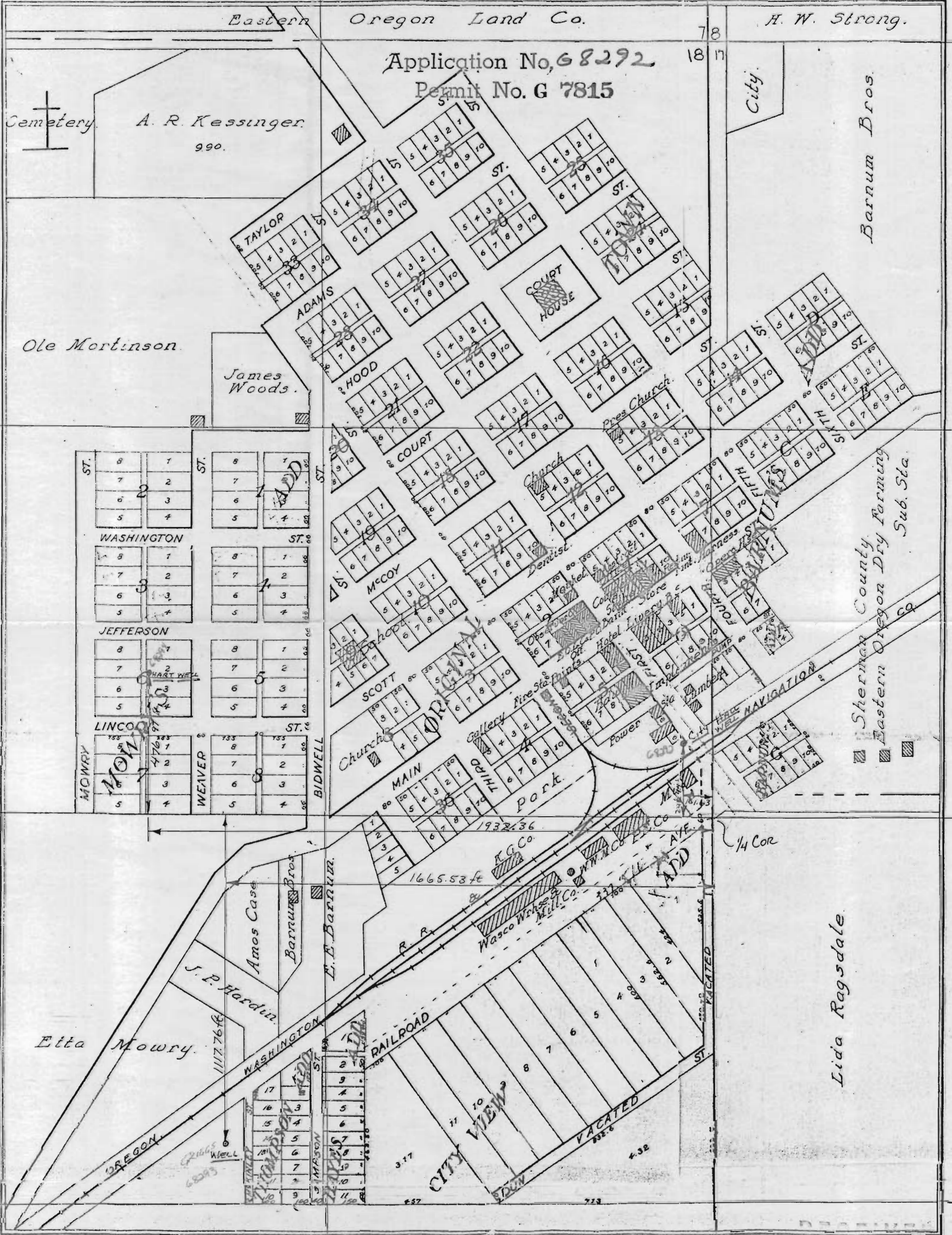

Section 18 NE 1/4 and the N 1/2 SE 1/4
Section 17 W 1/2 NW 1/4 and the NW 1/4 SW 1/4

1 South, Range 17 E.W.M.

NOV 14 1977
WATER RESOURCES DEPT.
SALEM, OREGON