

T.27S. R.19E. WM.

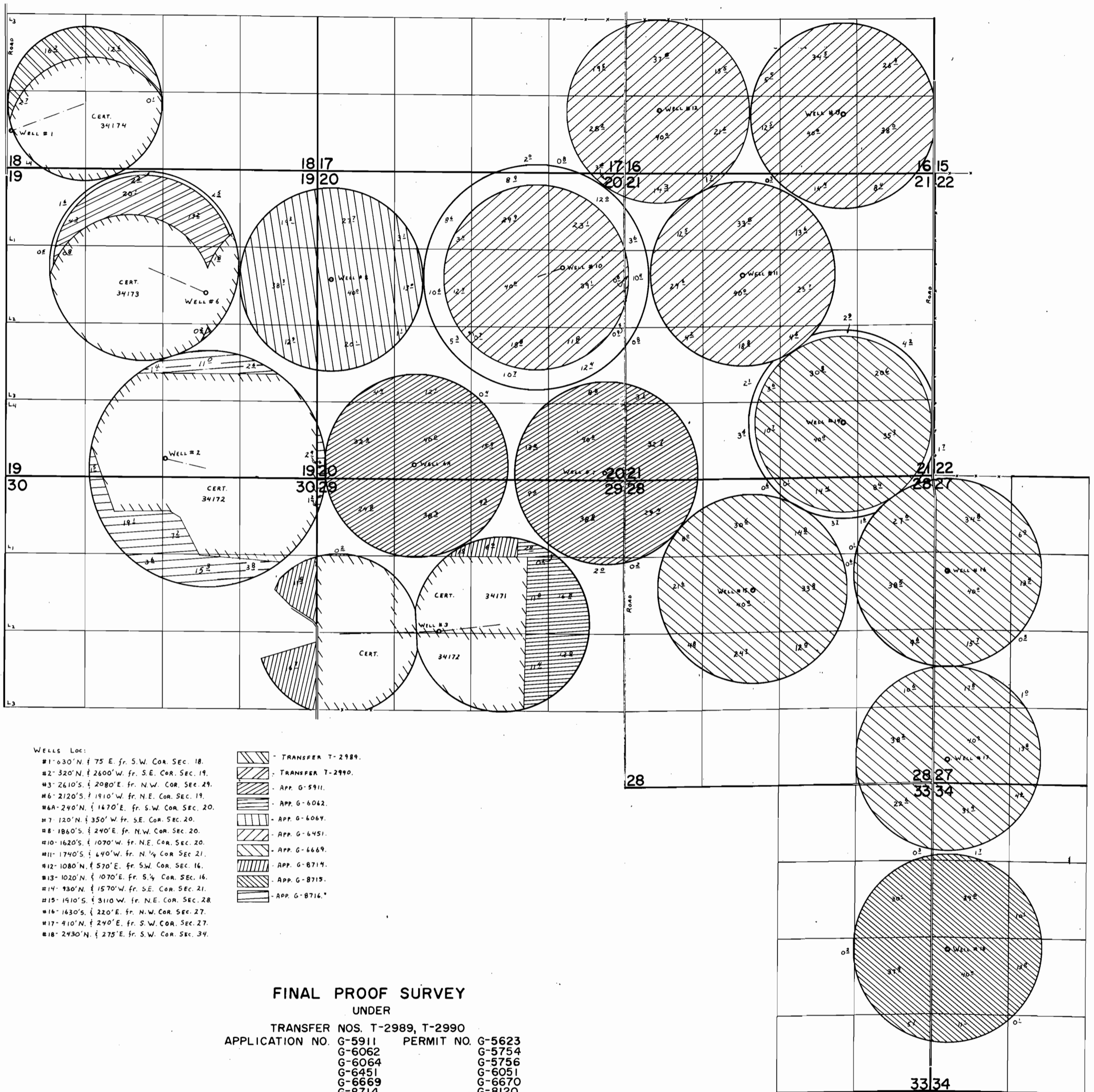

- WELLS LOC:
- #1- 630' N. § 75' E. fr. S.W. COR. SEC. 18.
 - #2- 320' N. § 2600' W. fr. S.E. COR. SEC. 19.
 - #3- 2610' S. § 2080' E. fr. N.W. COR. SEC. 29.
 - #6- 2120' S. § 1910' W. fr. N.E. COR. SEC. 19.
 - #6A- 240' N. § 1470' E. fr. S.W. COR. SEC. 20.
 - #7- 120' N. § 350' W. fr. S.E. COR. SEC. 20.
 - #8- 1860' S. § 240' E. fr. N.W. COR. SEC. 20.
 - #10- 1620' S. § 1070' W. fr. N.E. COR. SEC. 20.
 - #11- 1740' S. § 640' W. fr. N. ¼ COR. SEC. 21.
 - #12- 1080' N. § 570' E. fr. S.W. COR. SEC. 16.
 - #13- 1020' N. § 1070' E. fr. S. ¼ COR. SEC. 16.
 - #14- 930' N. § 1570' W. fr. S.E. COR. SEC. 21.
 - #15- 1910' S. § 3110' W. fr. N.E. COR. SEC. 28.
 - #16- 1630' S. § 220' E. fr. N.W. COR. SEC. 27.
 - #17- 910' N. § 240' E. fr. S.W. COR. SEC. 27.
 - #18- 2430' N. § 275' E. fr. S.W. COR. SEC. 34.

- TRANSFER T-2989.
- TRANSFER T-2990.
- APP. G-5911.
- APP. G-6062.
- APP. G-6069.
- APP. G-6451.
- APP. G-6669.
- APP. G-8714.
- APP. G-8715.
- APP. G-8716.

FINAL PROOF SURVEY
 UNDER
 TRANSFER NOS. T-2989, T-2990
 APPLICATION NO. G-5911 PERMIT NO. G-5623
 G-6062 G-5754
 G-6064 G-5756
 G-6451 G-6051
 G-6669 G-6670
 G-8714 G-8120
 G-8715 G-8121
 G-8716 G-8122

IN NAME OF

ALDER CREEK RANCH

SURVEYED AUG. 26, 1979, by C. L. HUGHES

Application No. M-8716
 Permit No. G 8122

NORTH

RECEIVED

APR 4 1978
 WATER RESOURCES DEPT.
 SALEM, OREGON

RECEIVED

MAY 15 1978
 WATER RESOURCES DEPT.
 SALEM, OREGON

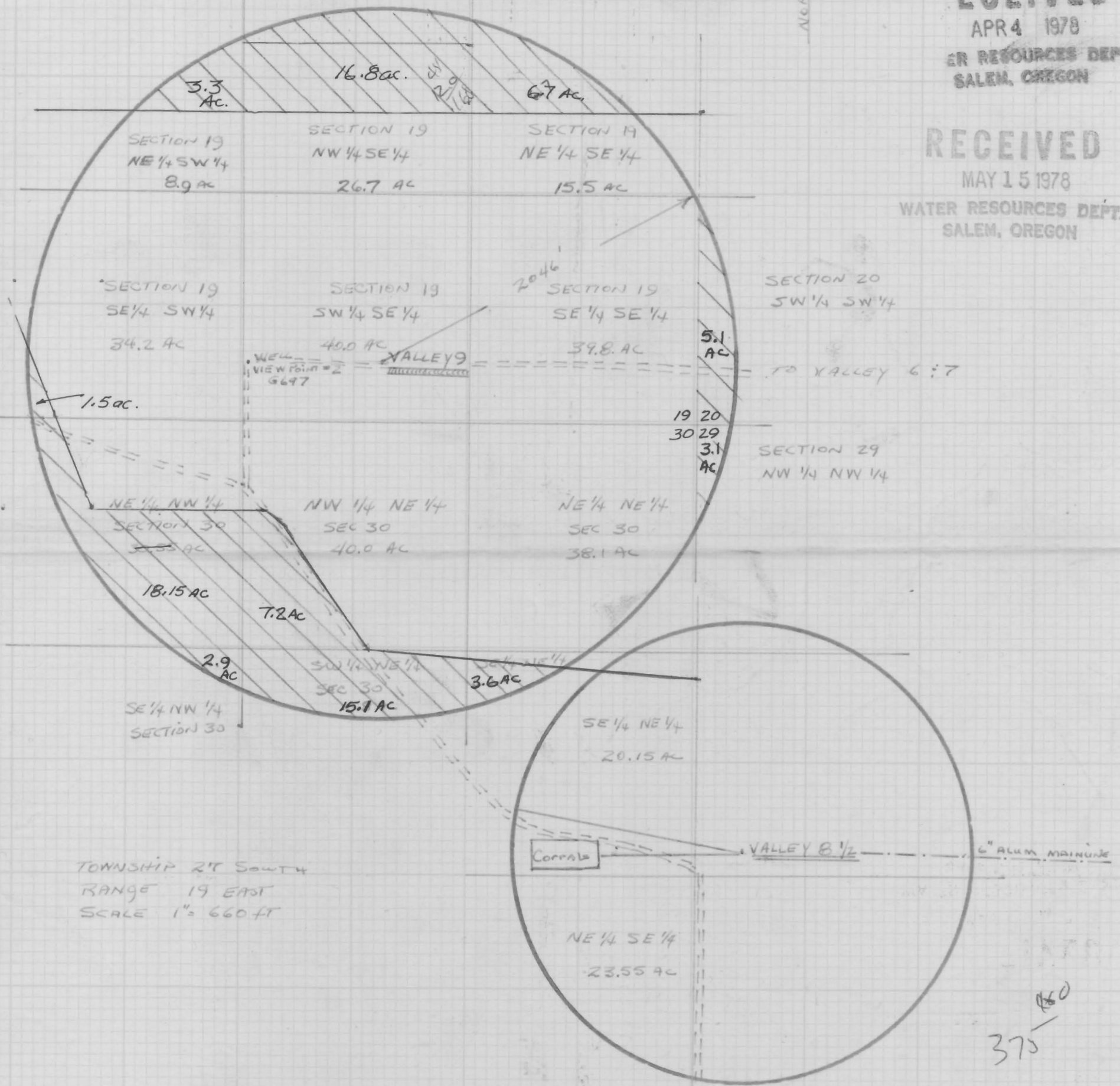

T.27S.R.18&19E.W.M.

Also certificate recording fee

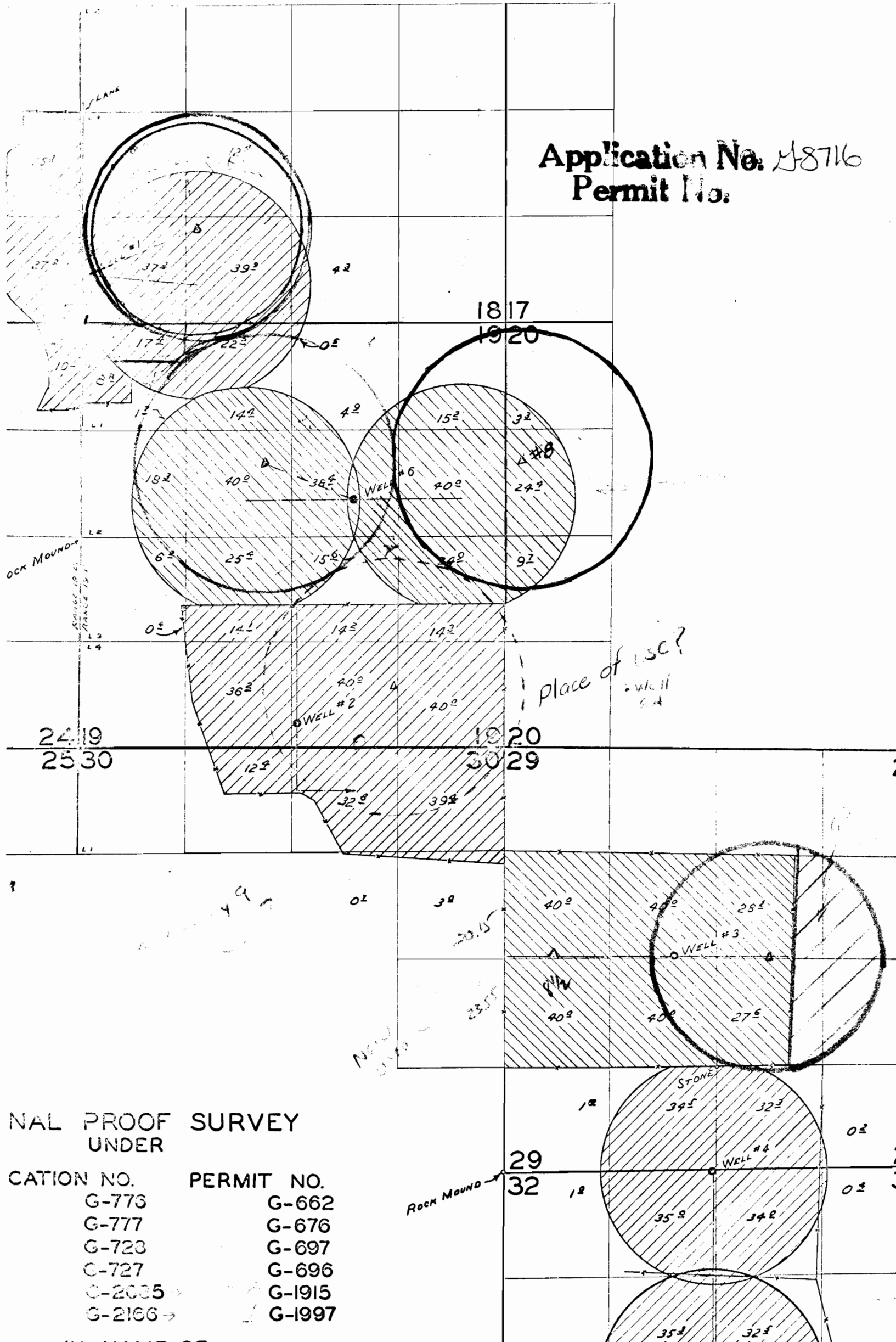

NAL PROOF SURVEY UNDER

CATION NO.	PERMIT NO.
G-776	G-662
G-777	G-676
G-723	G-697
C-727	G-696
C-2035 →	G-1915
G-2166 →	G-1997