

T.4S., R.1W., W.M.

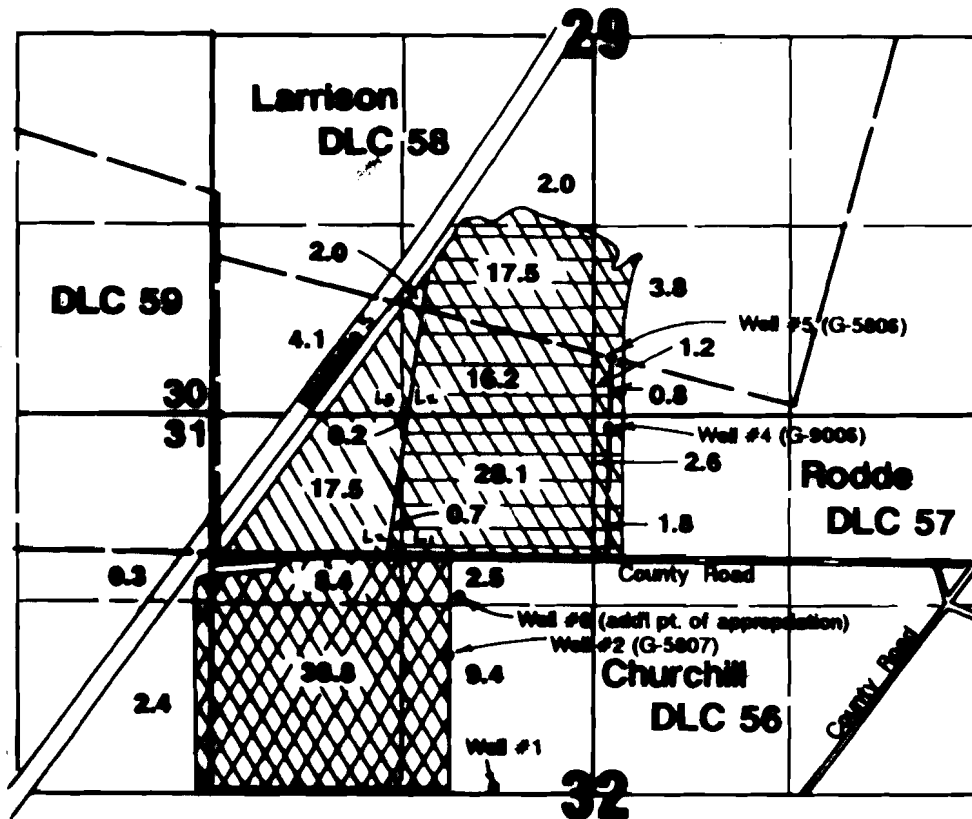

1" = 1320'

Area Irrigated

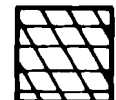

C-45551



C-54710



C-8387

Well #6 (addl pt. of appropriation) located 1380'N & 920'W from center Section 32.

Final Proof Survey

Transfer #6438

In Name Of

Tom DeArmond

Surveyed on October 15, 1993 by JM Schuette

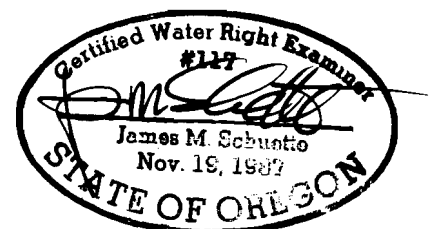

THIS MAP WAS PREPARED FOR THE PURPOSE OF IDENTIFYING THE LOCATION OF A WATER RIGHT ONLY AND IS NOT INTENDED TO PROVIDE LEGAL EVIDENCE ON LOCATION OF PROPERTY OWNERSHIP LINES.