

T. 38 S., R. 1 W., W.M.

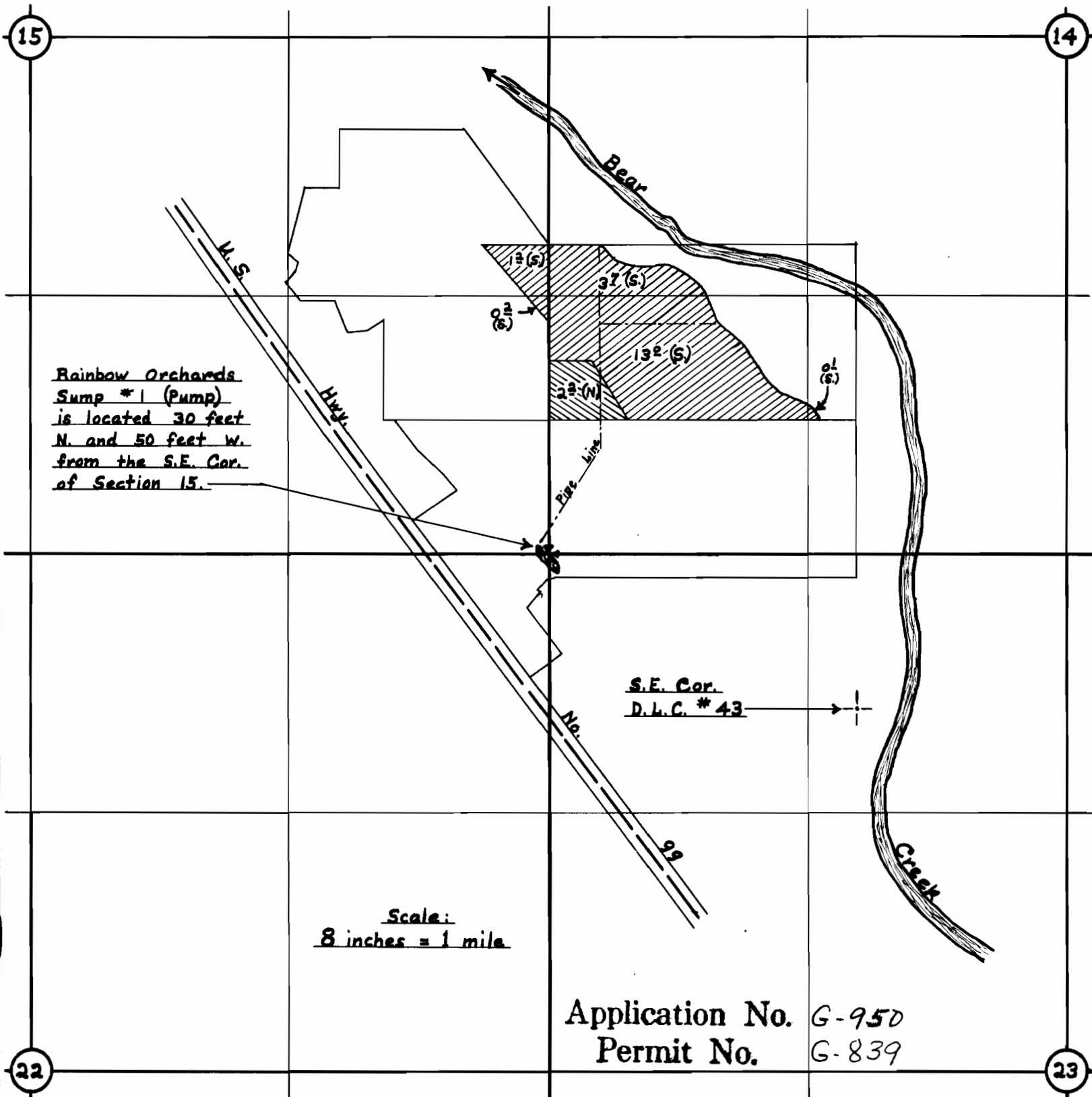

Rainbow Orchards Sump #1 (Pump) is located 30 feet N. and 50 feet W. from the S.E. Cor. of Section 15.

Map to accompany application in the name of "Harry and David," for use of water from Rainbow Orchards Sump #1 for Irrigation and Supplemental Irrigation purposes.

This Office -----April 17, 1958.

David C. Hendrix, Watermaster Dist. No. 15.