

20,000 sq. ft.



1" = 100'

NO. 395

WELL SITE

280'

Application No. G-8985
Permit No. G 8398

RECEIVED

NOV 27 1978

WATER RESOURCES DEPT.
SALEM, OREGON

RECEIVED

OCT 05 1978

WATER RESOURCES DEPT.
SALEM, OREGON

CITY OF LONG CREEK

WELL SITE #1

SW1/4 NW1/4, Sec. 10, T.10S., R.30E.W.M.
GRANT COUNTY, OREGON

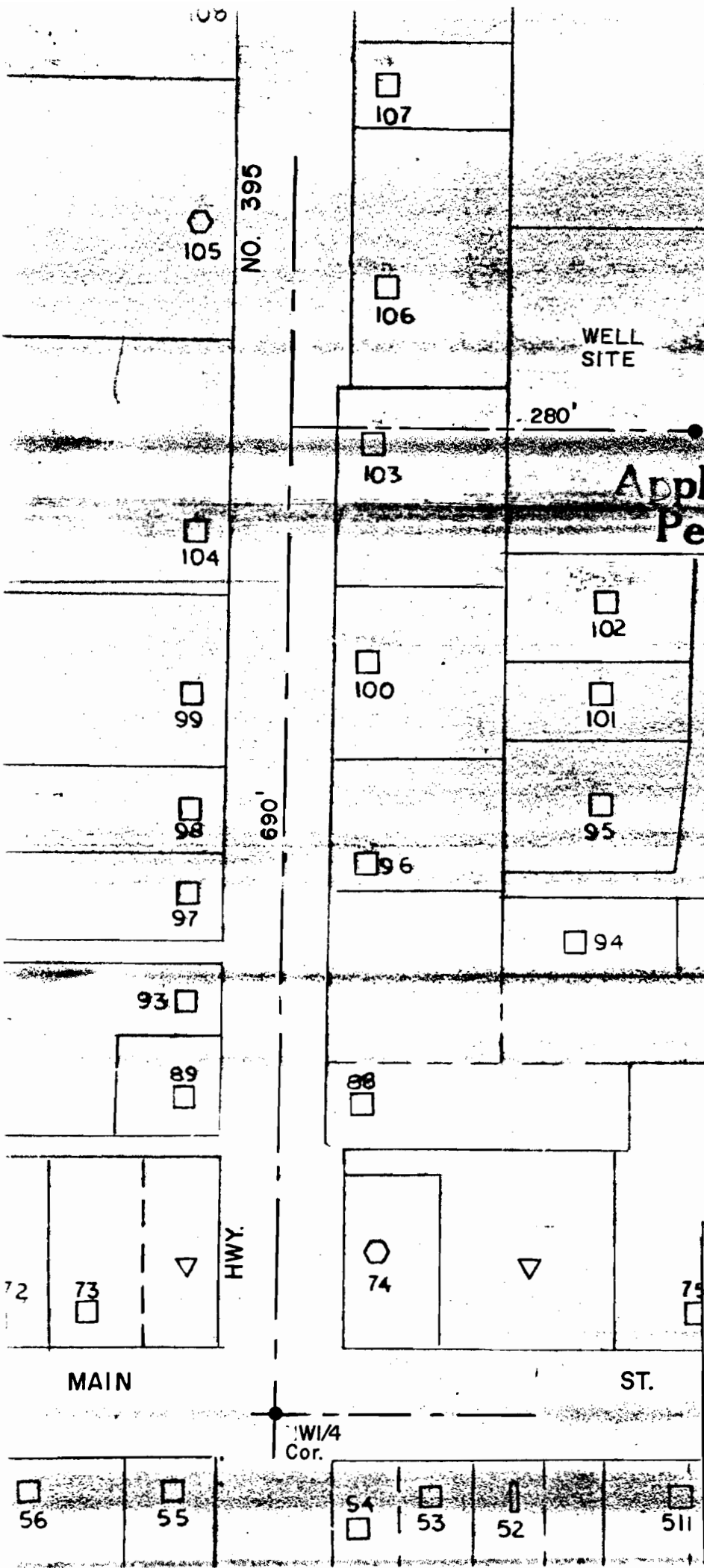

108

107

106

103

104

102

100

101

99

98

95

97

96

94

93

89

88

72

73

74

75

MAIN

ST.

HWY.

1/4 Cor.

56

55

54

53

52

51