

T. 38S., R. 5W., W.M.

RECEIVED

MAR 30 1987

WM. DIST. 14  
GRANTS PASS, ORE.

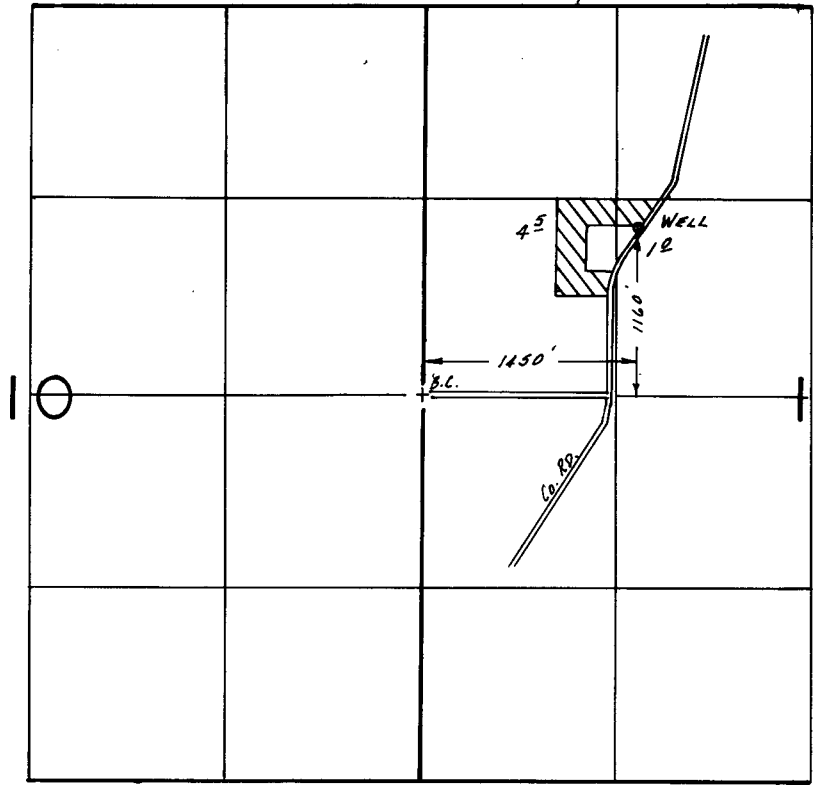
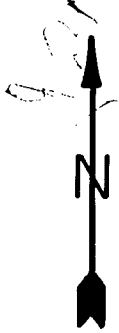

SCALE: 1" = 1320'

**FINAL PROOF SURVEY**  
UNDER

Application No. G-9154. Permit No. G-8530.....  
IN NAME OF

.....WILLIAM C. MACY.....

Surveyed Sept. 16.. 1985., by B.S. JAMES.....

3/21/87  
RWB  
41033-179-109 L