

INCREMENTAL PROOF MAP

THE CITY OF BEND
 APPLICATION # G-8695
 PERMIT # G-8565

WESTWOOD WELL
 NW 1/4 NW 1/4 SECTION 7,
 TOWNSHIP 18S, RANGE 12E, W.M.

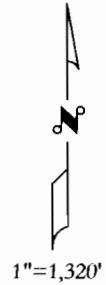
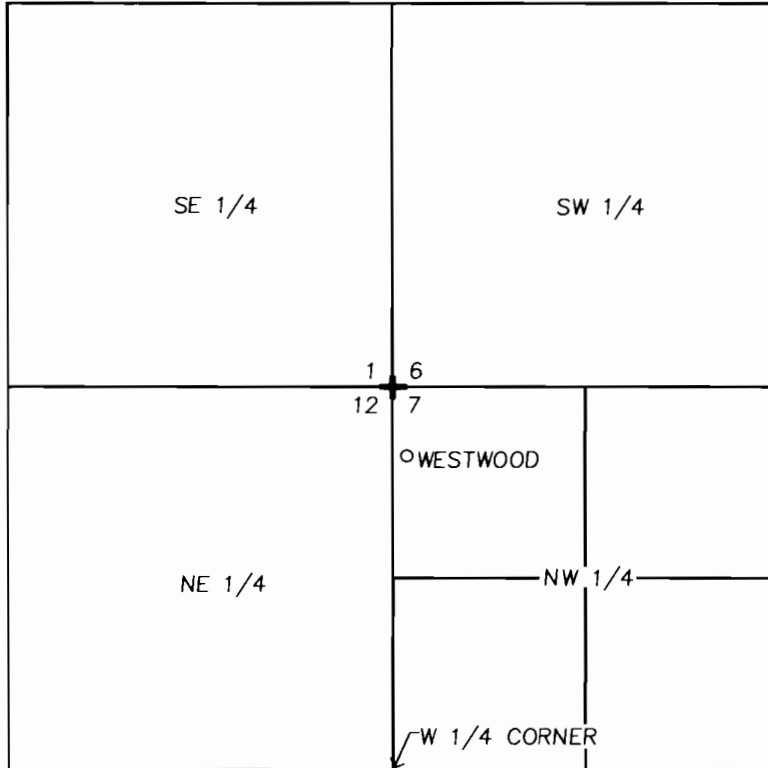

FROM THE NW CORNER OF SECTION 7, WESTWOOD WELL IS 485.52 FEET S 11° 18' 36" E

PLACE OF USE IS WITHIN THE SERVICE AREA OF THE CITY OF BEND.

THE PURPOSE OF THIS MAP IS TO IDENTIFY THE LOCATION OF THE WATER RIGHT. IT IS NOT INTENDED TO PROVIDE INFORMATION RELATIVE TO THE LOCATION OF PROPERTY OWNERSHIP LINES.

RECEIVED

AUG 3 1 2000

WATER RESOURCES DEPT.
 SALEM, OREGON



PREPARED FOR: CITY OF BEND

10541.000

INCREMENTAL PROOF MAP
 WESTWOOD WELL
 CITY OF BEND



644 NE GREENWOOD AVE.
 SUITE A
 BEND, OREGON 97701
 (541) 388-9290
 FAX (541) 382-5116

AUGUST 2000