

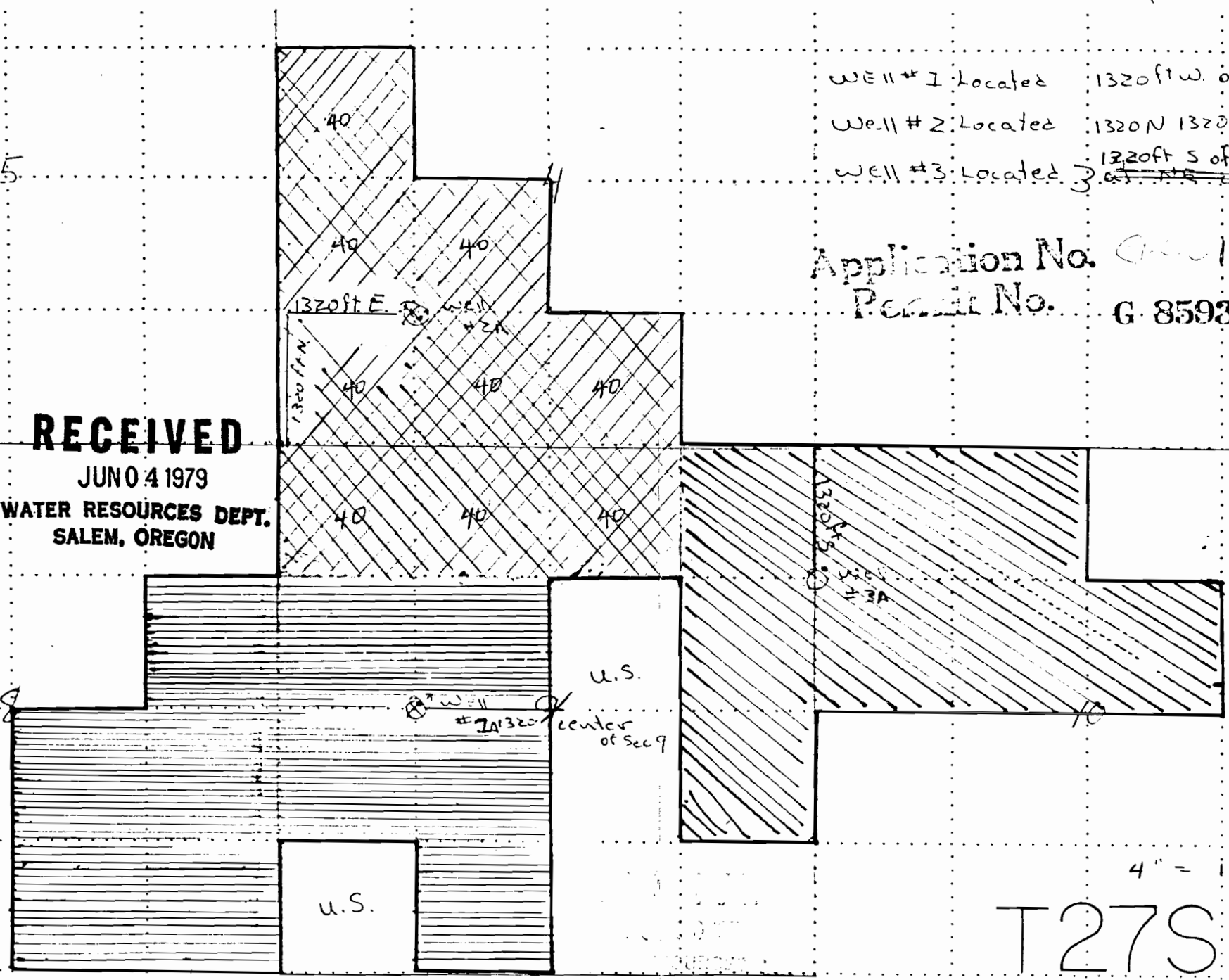

5

Well #1 Located 1320ft W. of Center of Sec 9 T27S R34E
 Well #2 Located 1320N 1320E of SW corner of Sec 4 T27S R34E
 Well #3 Located 3 ~~at the corner of Sec 9~~ 1320ft S of NE corner of Sec 9 T27S R34E

Application No. 00018
 Permit No. G 8593

RECEIVED
 JUN 04 1979
 WATER RESOURCES DEPT.
 SALEM, OREGON

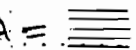

Well # 1A = 
 Well # 2A = 
 Well # 3A = 

4" = 1 mile

T27S R34E

OREGON
 DEPARTMENT OF WATER RESOURCES