

T. 35 S., R. 5 W., W.M.

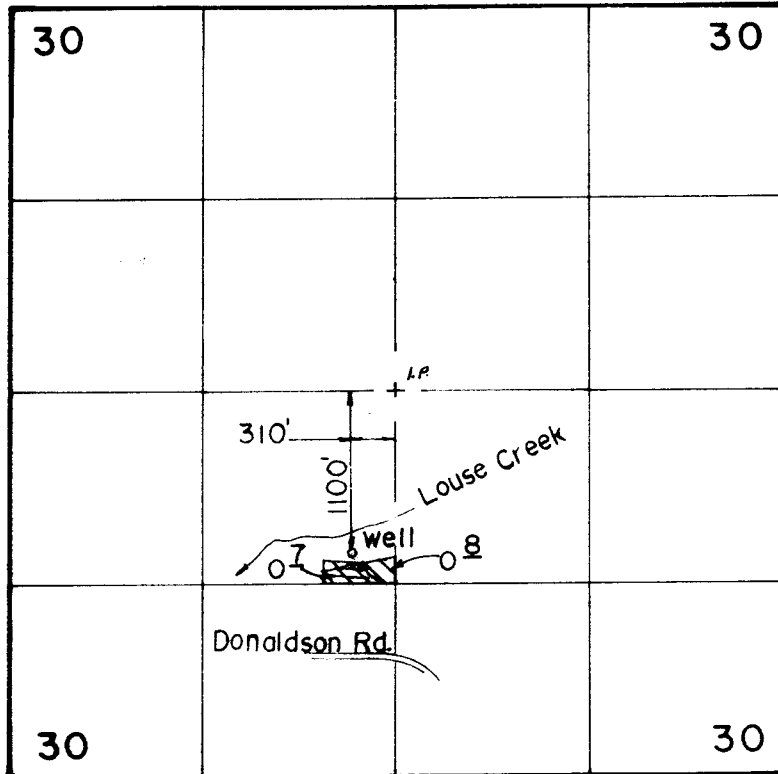

Scale: 1" = 1320'

FINAL PROOF SURVEY
UNDER

Application No. G-9294 Permit No. G-8657
IN NAME OF

BRUCE & CARROLL ALBERT

Surveyed JULY 29, 1987, by B. S. JAMES

REC'D

JAN 31 1988

W.M. DIST. 14
GRAVES PASS, ORE

41033-179-135K L.M.J.