

T. 3 S., R. 1 W. W. M.  
Scale 1" = 400'

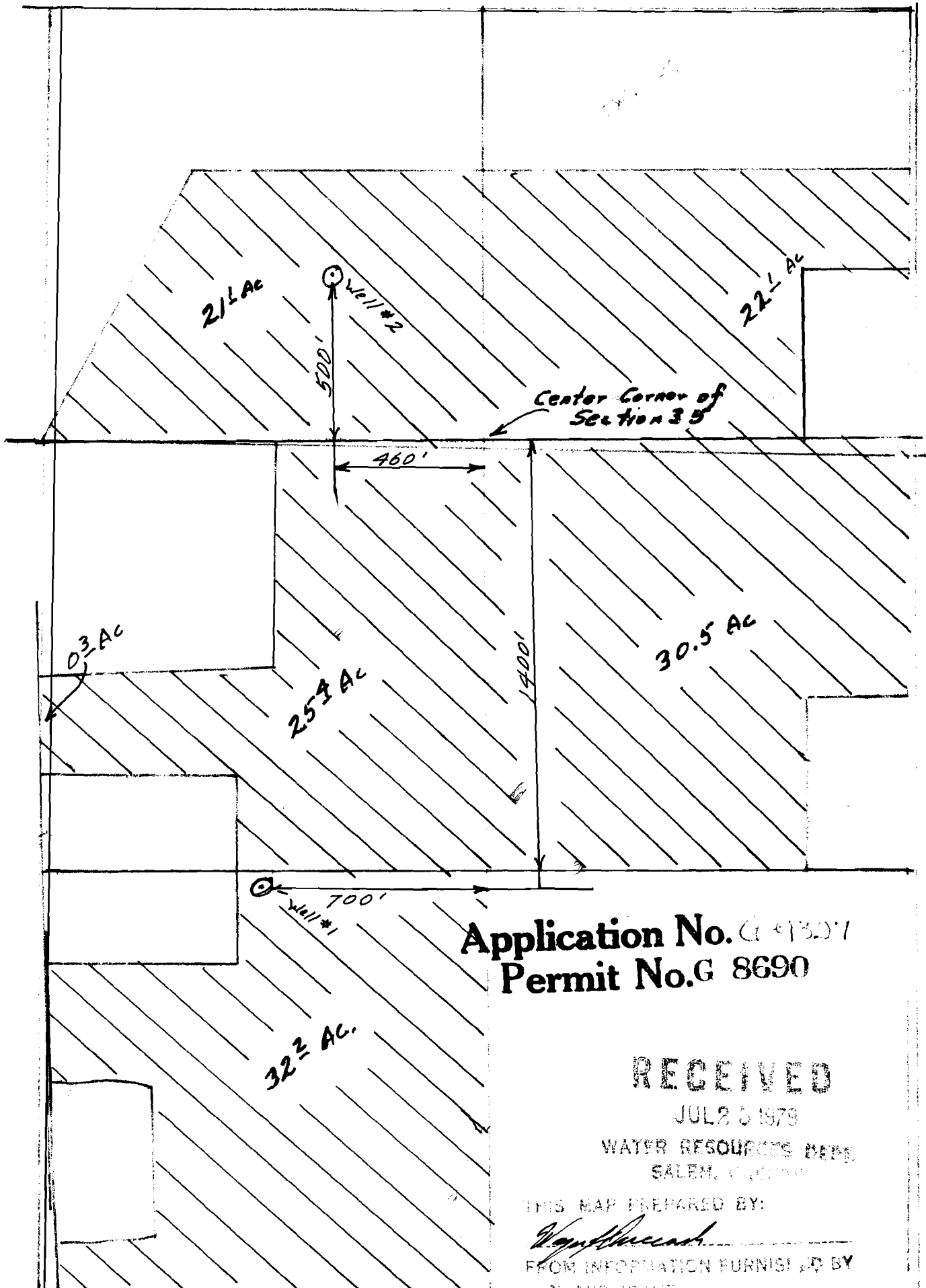

Application No. G 4307  
Permit No. G 8690

RECEIVED

JUL 25 1979

WATER RESOURCES DEPT.  
SALEM, OREGON

THIS MAP PREPARED BY:

*Handwritten signature*

FROM INFORMATION FURNISHED BY  
THE APPLICANT