

RECEIVED

APR 1 1966

WATER RESOURCES DEPT  
GALLIEN, OREGON

Twp. 18 S., R. 47 E., W.M.  
Sec. 11: NE cor  
SW  $\frac{1}{4}$  NW  $\frac{1}{4}$

Application for Permit  
C.S. Unterkircher  
3820 River Road  
Ontario, Oregon 97914

Applicant also located at  
pob 278  
Juntura Oregon 97911

Application No. \_\_\_\_\_  
Permit No. \_\_\_\_\_

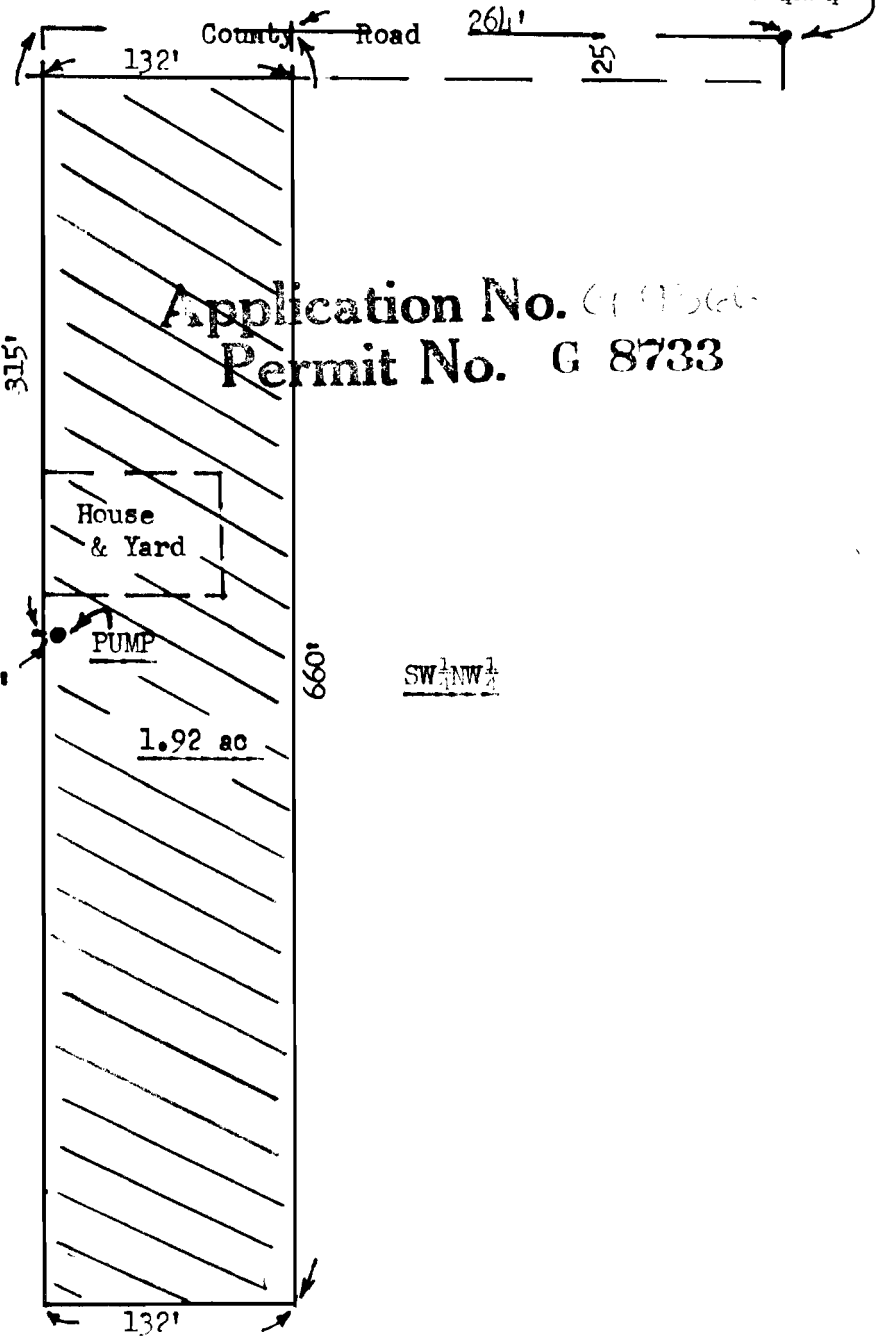

Scale 1" = 100'

Land in Malheur County, Oregon

In Twp 18 S., R. 47 E., W.M.  
Sec. 11: part SW  $\frac{1}{4}$  NW  $\frac{1}{4}$