

RECEIVED
 NOV 19 1979
 WATER RESOURCES DEPT
 SALEM, OREGON

Application No. G-9462
 Permit No. G 8866

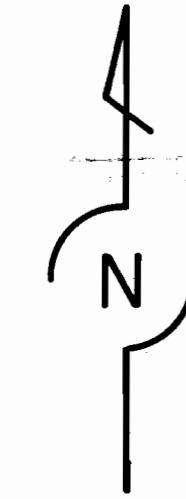
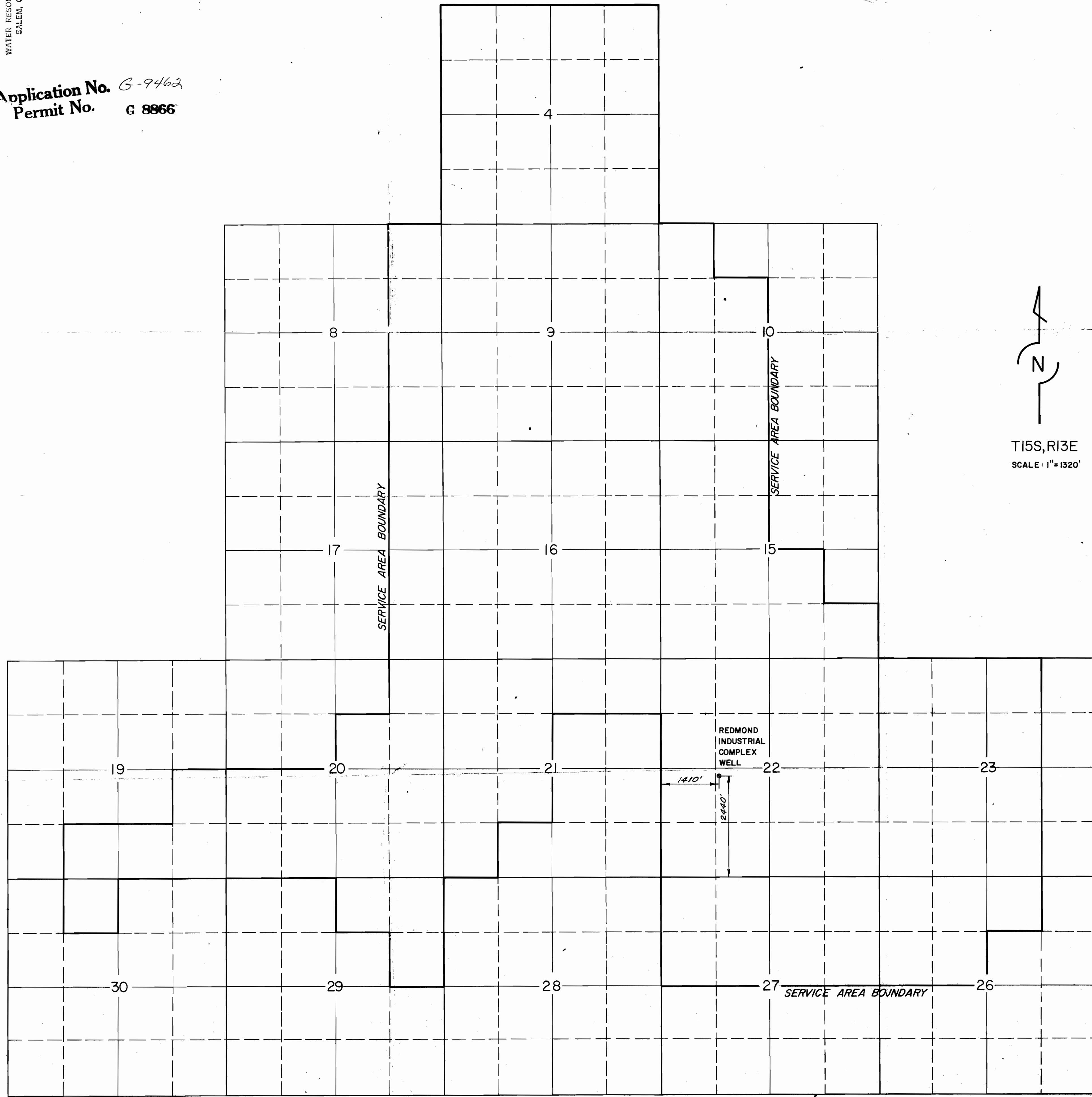

T15S, R13E
 SCALE: 1"=1320'

Design By	REVISIONS			REDMOND INDUSTRIAL COMPLEX WELL WATER RIGHTS APPLICATION SERVICE AREA, LOCATION MAP
Drawn By MM	No.	By	Date	
Checked By G. HALL				
Approved By				
Date 10-19-79				
Scale AS SHOWN				
Project No. 0106.091.B2				
Work Order No.				

Century West Engineering Corporation

Bend,
 Oregon