

T. 35 S., R. 5 W., W. M.  
SEC. 3

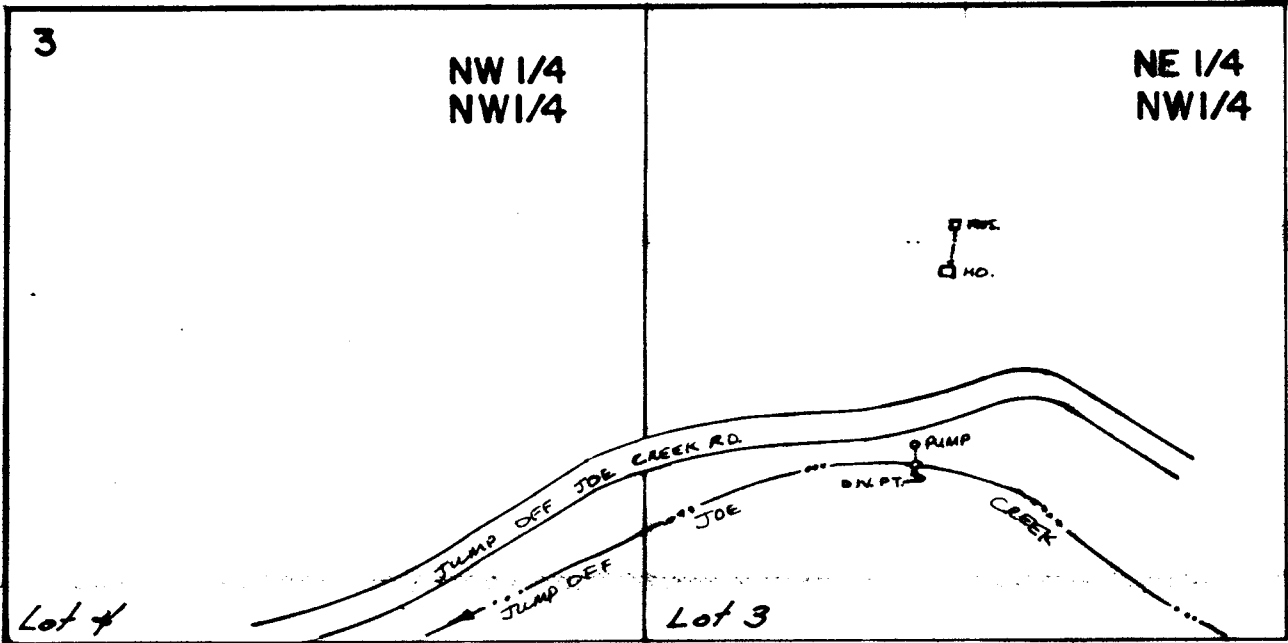

DIV. PT. 4 955' S. ● 765' W. FROM N. 1/4 COR. SEC. 3

SCALE: 1" = 400'

**FINAL PROOF SURVEY**  
UNDER

RECORDED  
AUG 22 1988  
SHE. DIST. 14  
GRANTS PASS, ORG.

Application No. 55641... Permit No. 41683.....  
IN NAME OF

**PAUL J. DeMARINIS**

Surveyed **JULY 11** 19**84**, by **B.S. JAMES**

PTS-1984-13A JMW.