

T. 38 S., R. 5 W., W. M.

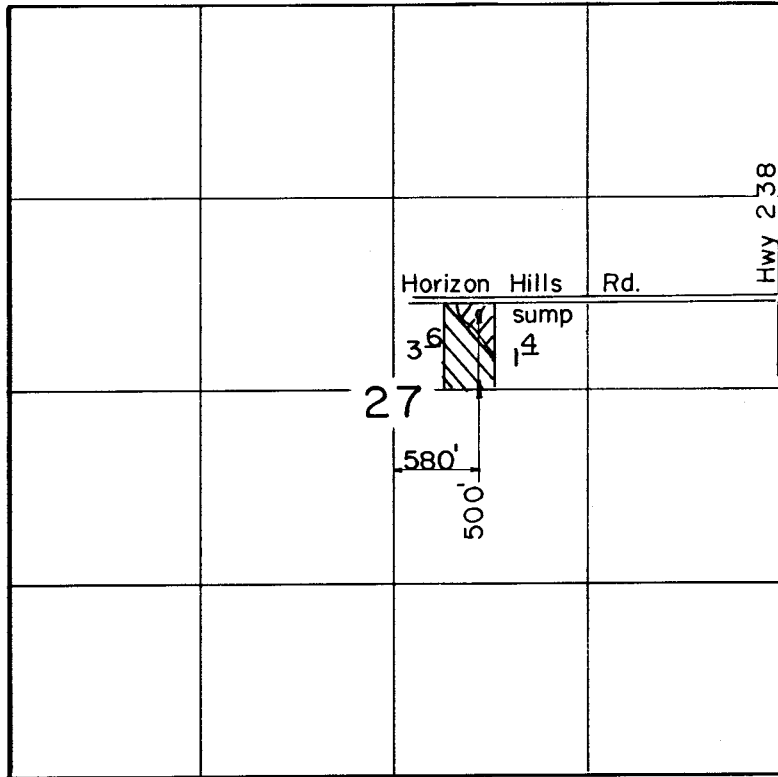

Scale: 1" = 1320'

RECEIVED

AUG 8 1991

WM. DIST. 14  
GRANTS PASS, ORE

**FINAL PROOF SURVEY**  
UNDER

Application No. G:9925 Permit No. G:9475...  
IN NAME OF

KENNETH...W...TULL...&...DOROTHY...M...PLUMLEE

Surveyed AUG...9... 1988, by B. S. JAMES...