

T. 41 S. R. 13 W. W.M.

RECEIVED

OCT 16 1981

WATER RESOURCES DEPT.
SALEM, OREGON

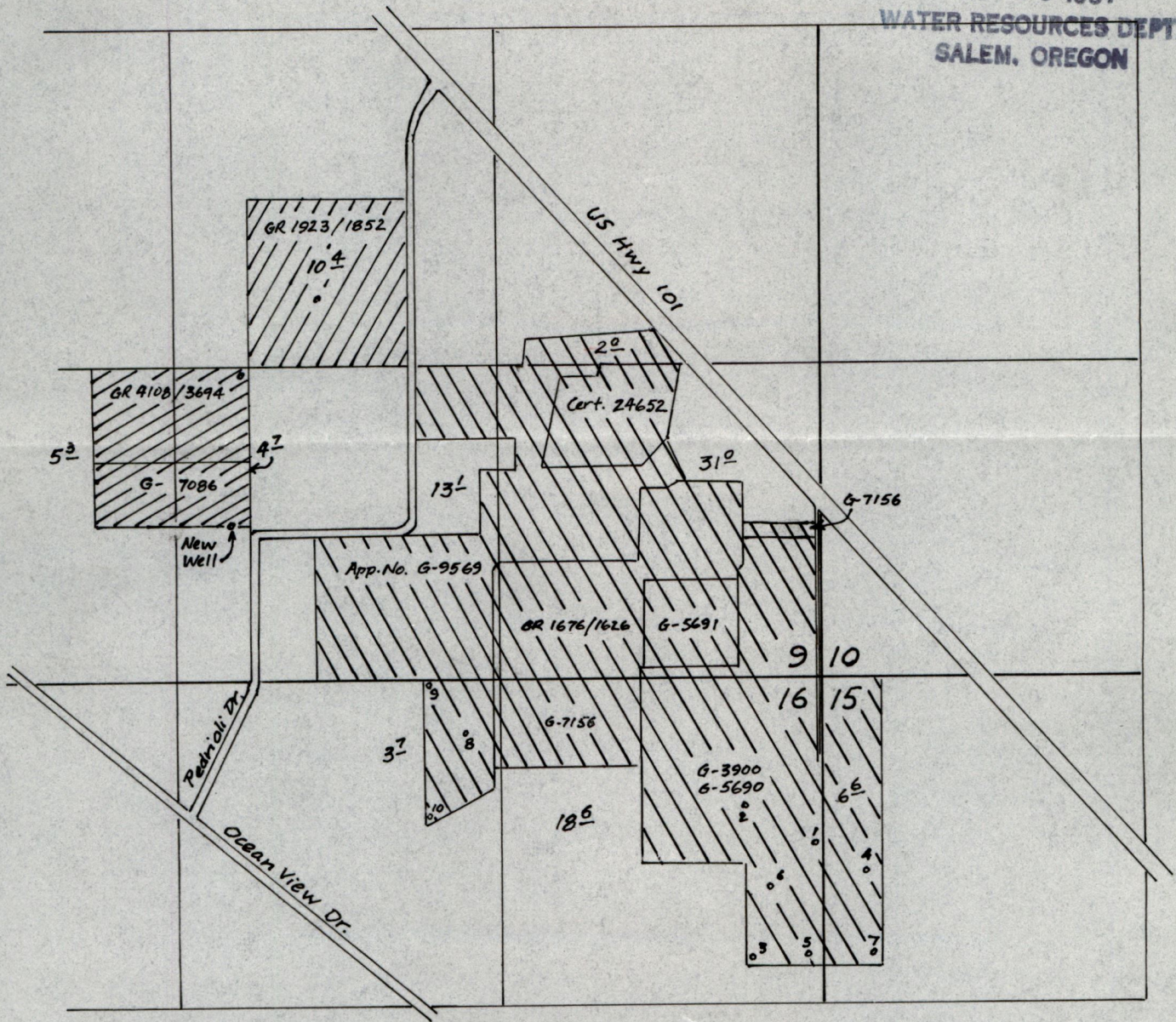

Scale: 8" = 1 mile

New Well located 650' N. $\frac{1}{4}$ 2415' W. from SE Cor. Sec. 9.



Lands to receive primary supply for air temp. control.



Lands to receive primary supply for air temp. control and supplemental supply for irrigation.



Lands to receive supplemental supply for irrigation and supplemental supply for air temp. control.

Application No. G-9570
Permit No. G 9494