

RECEIVED

FEB 14 1982

WATER RESOURCES DEPT
SALMON RIVER DISTRICT
OREGON

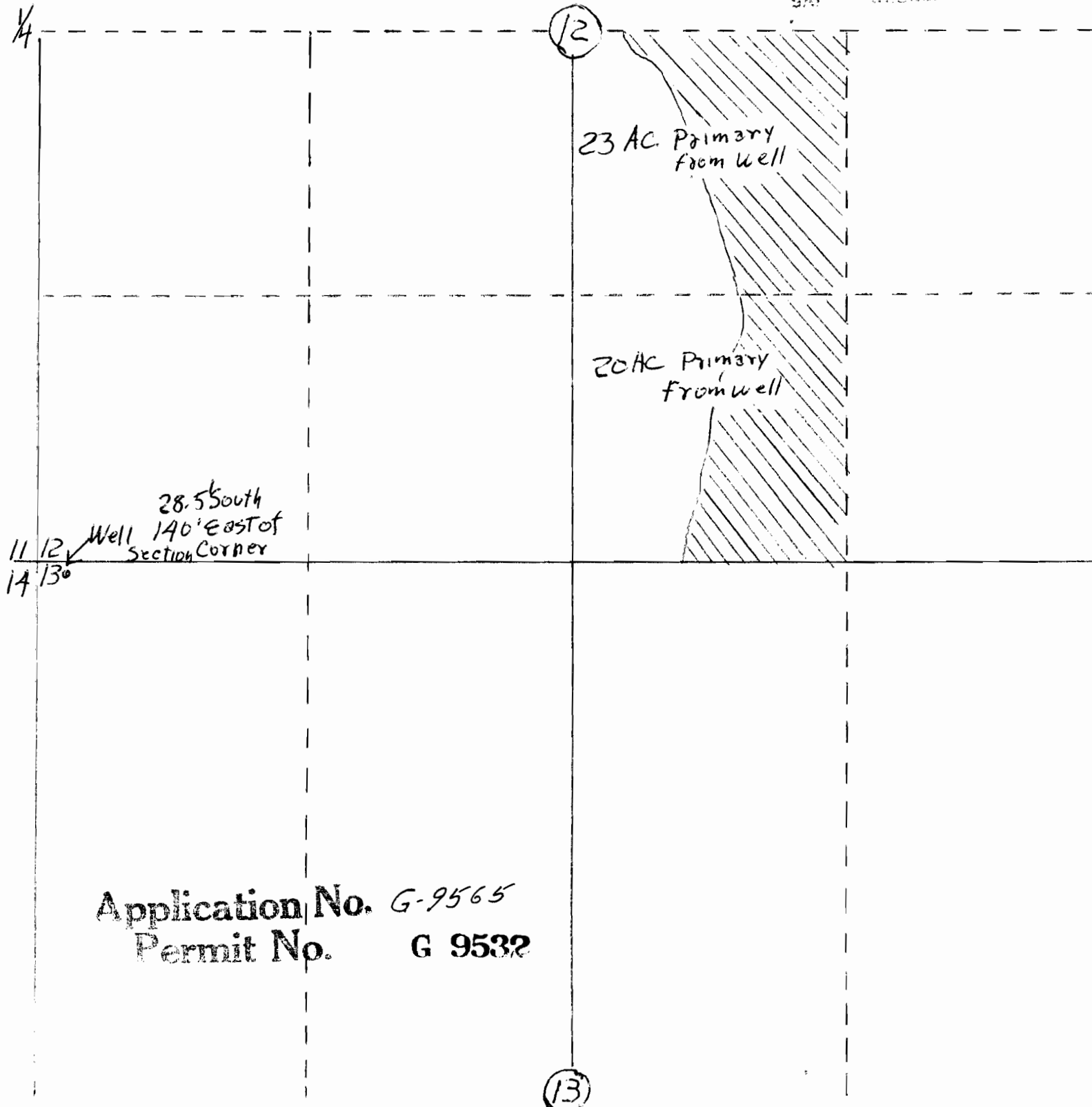

1/4
11 12 Well 28.5 South
14 13 140' East of
Section Corner

23 AC Primary
from Well

20 AC Primary
from Well

Application No. G-9565
Permit No. G 9532

13

Tp 15 S. R 10 E W. M.