

DISTRIBUTION SERVICE AREA
POLK COUNTY, OREGON
 SCALE: 1" = 1 MILE
 BOUNDARY LINE [Symbol]
 AREA TO BE ADDED TO COOPERATIVE [Symbol] (FEBRUARY 1, 1980)
 AREA TO BE DELETED FROM COOPERATIVE [Symbol] (FEBRUARY 1, 1980)
 AREA TO BE ADDED TO COOPERATIVE [Symbol] (JUNE 16, 1980) (Appl. G-9782)

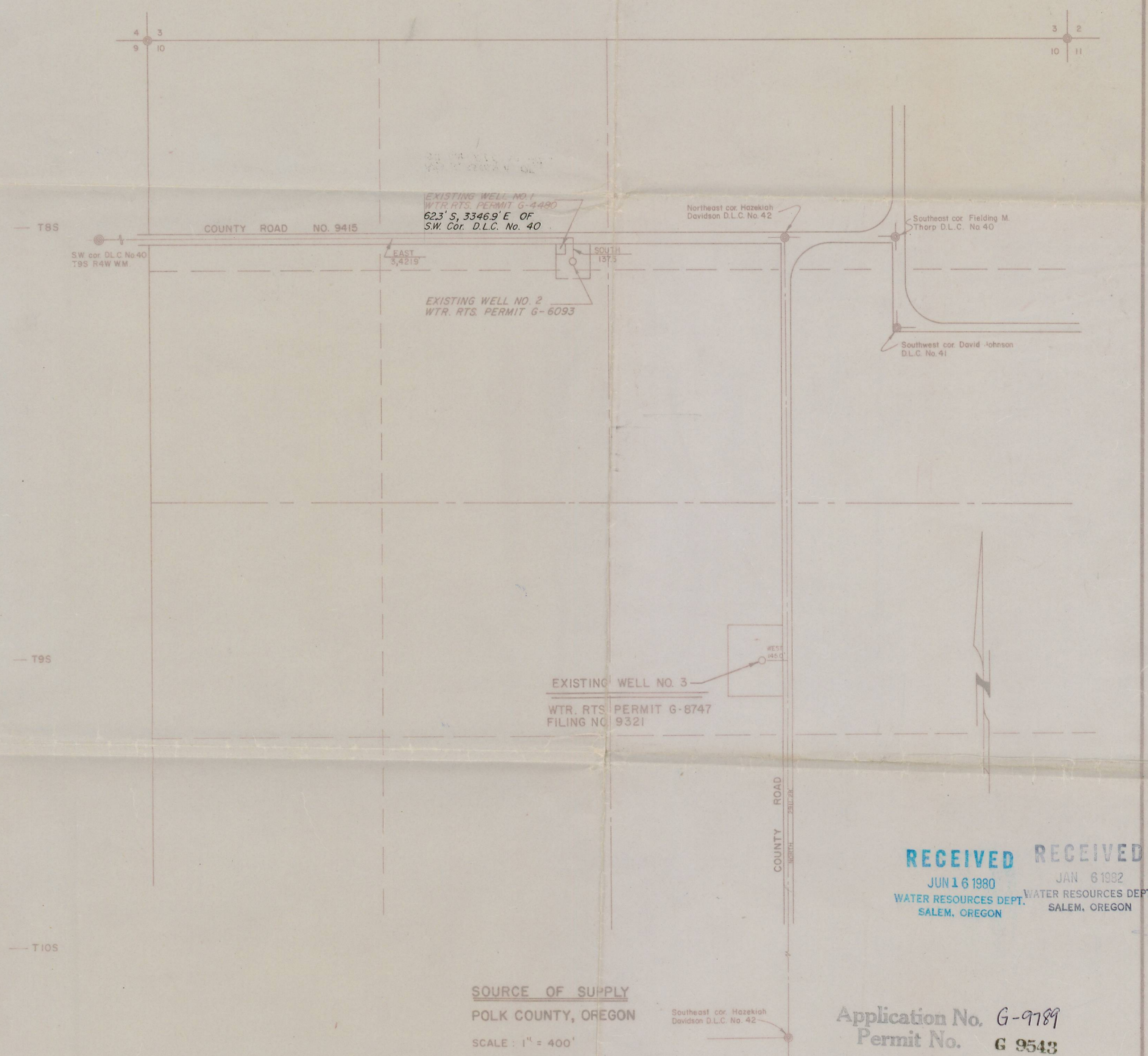

RECEIVED RECEIVED
 JUN 16 1980 JUN 6 1982
 WATER RESOURCES DEPT. WATER RESOURCES DEPT.
 SALEM, OREGON SALEM, OREGON

Application No. G-9789
 Permit No. G 9543



JUNE 16, 1980 J.M.P.
 REVISED FEBRUARY 1, 1980 J.M.P.

LUCKIAMUTE DOMESTIC WATER COOPERATIVE		
WATER RIGHTS MAP		
Scale: As Shown	Date: 6-18-1974	Revised: 2-12-1975
Design: M.G.B.	M. G. BOATWRIGHT & ASSOCIATES	SHEET
Drawn: W.F.J.	2613 Twelfth Street S.E.	
Checked: F.W.B.	SALEM, OREGON 97302	1 / 2