

T. 38 S., R. 5 W., W. M.

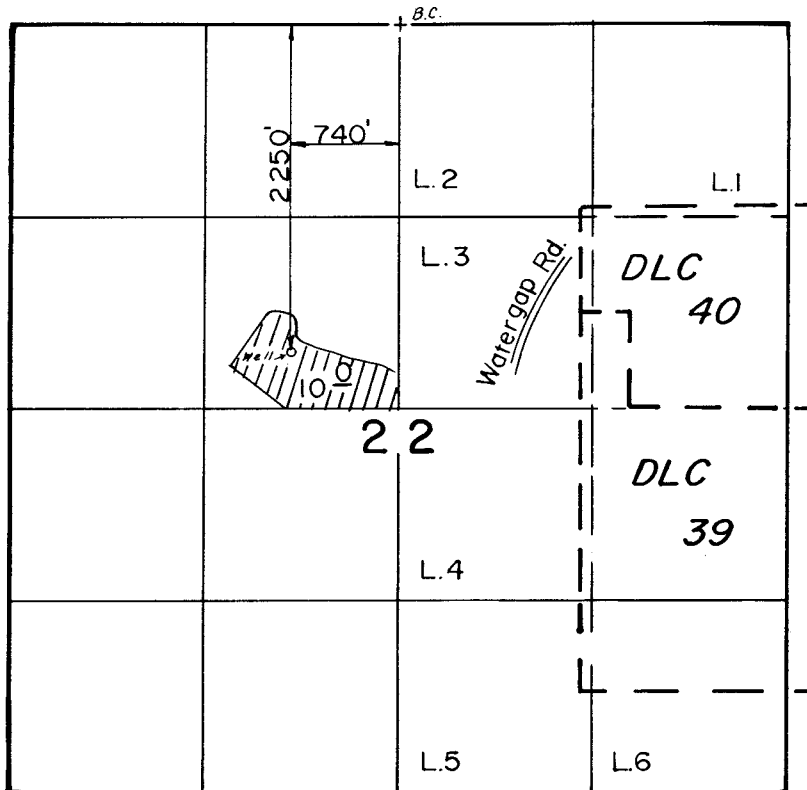

Scale: 1" = 1320'

RECEIVED

AUG 2 1991

WM. DIST. 14  
GRANTS PASS, ORE.

**FINAL PROOF SURVEY**  
UNDER

Application No. G-10606 Permit No. G-9724  
IN NAME OF

PERRY L. & ANN L. PETERSON

Surveyed AUG. 10. 1988, by B. S. JAMES