

R. 12 E. R. 13 E.

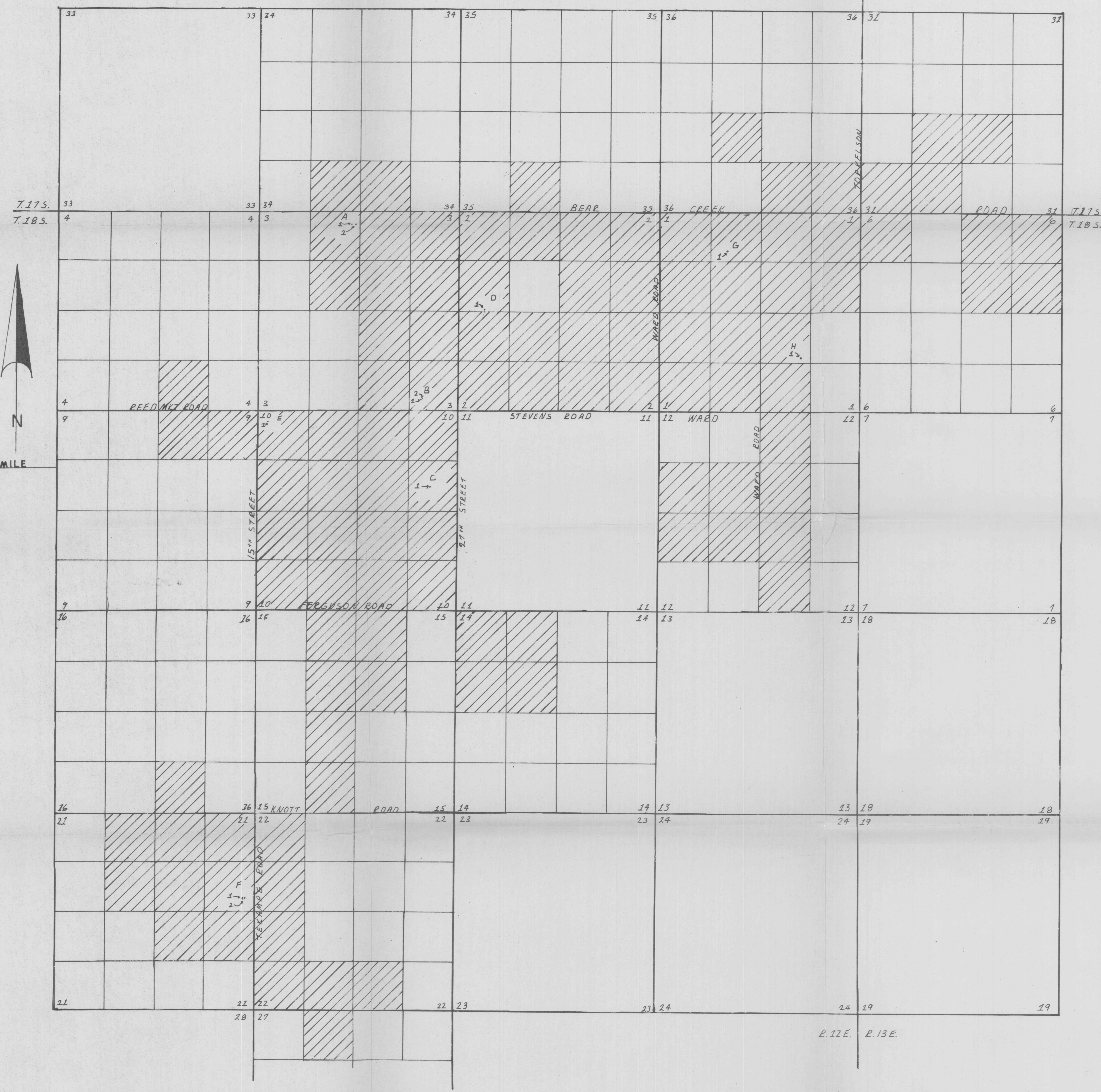

WELL LOCATIONS

AVION (Site A): WELL #1 325' S. AND 200' W. FROM THE N¹/₄ CORNER SEC. 3 T. 18 S. R. 12 E.
30,000 Gal. Res. WELL #2 325' S. AND 86' W. FROM THE N¹/₄ CORNER SEC. 3 T. 18 S. R. 12 E.
being WITHIN the NE¹/₄ NW¹/₄ SEC. 3 T. 18 S. R. 12 E. W.M. DESCHUTES COUNTY

DALY EST. (Site B): WELL #1 264' N AND 947' W FROM THE SE. CORNER OF SEC. 3 T. 18 S. R. 12 E.
30,000 Gal. Res. WELL #2 274' N AND 937' W FROM THE SE. CORNER OF SEC. 3 T. 18 S. R. 12 E.
being WITHIN the SE¹/₄ SE¹/₄ OF SEC. 3 T. 18 S. R. 12 E. W.M. DESCHUTES COUNTY

COUNTRY SUNSET (Site C): WELL #1 2000' S. AND 706' W. FROM THE NE CORNER SEC. 10 T. 18 S. R. 12 E. BEING WITHIN the SE¹/₄ NE¹/₄ SEC. 10 T. 18 S. R. 12 E. W.M. DESCHUTES COUNTY

SKYVIEW TERRACE (Site D): WELL #1 90' N. AND 700' E. FROM THE W¹/₄ CORNER SEC. 2 T. 18 S. R. 12 E. BEING WITHIN the SW¹/₄ NW¹/₄ SEC. 2 T. 18 S. R. 12 E. W.M. DESCHUTES COUNTY

PAULINA VIEW (Site E): WELL #1 268' S. AND 260' E. FROM THE NW CORNER SEC. 10 T. 18 S. R. 12 E. BEING WITHIN the NW¹/₄ NW¹/₄ SEC. 10 T. 18 S. R. 12 E. W.M. DESCHUTES COUNTY

TEKAMPE (Site F): WELL #1 2260' S. AND 315' W. FROM THE N.E. CORNER SEC. 21 T. 18 S. R. 12 E.
30,000 Gal. Res. R. 12 E.
WELL #2 2260' S. AND 300' W. FROM THE N.E. CORNER SEC. 21 T. 18 S. R. 12 E. BEING WITHIN the S.E¹/₄ NE¹/₄ SEC. 21 T. 18 S. R. 12 E. W.M. DESCHUTES COUNTY

DOBBIN (Site G): WELL #1 1010' S. AND 1805' E. FROM THE NW CORNER OF SEC. 1 T. 18 S. R. 12 E. BEING WITHIN the NE¹/₄ NW¹/₄ SEC. 1 T. 18 S. R. 12 E. W.M. DESCHUTES COUNTY

SOMERSET (Site H): WELL #1 1413' N. AND 1070' E. FROM THE S¹/₄ CORNER SEC. 1 T. 18 S. R. 12 E. BEING WITHIN the NW¹/₄ SE¹/₄ SEC. 1 T. 18 S. R. 12 E. W.M. DESCHUTES COUNTY

NOTE: AREAS APPLIED FOR ARE SHADED

RECEIVED
DEC 28 1982
WATER RESOURCES DEPT.
SALEM, OREGON

Application No. G-10184
Permit No. G 9946

R. 12 E. R. 13 E.