

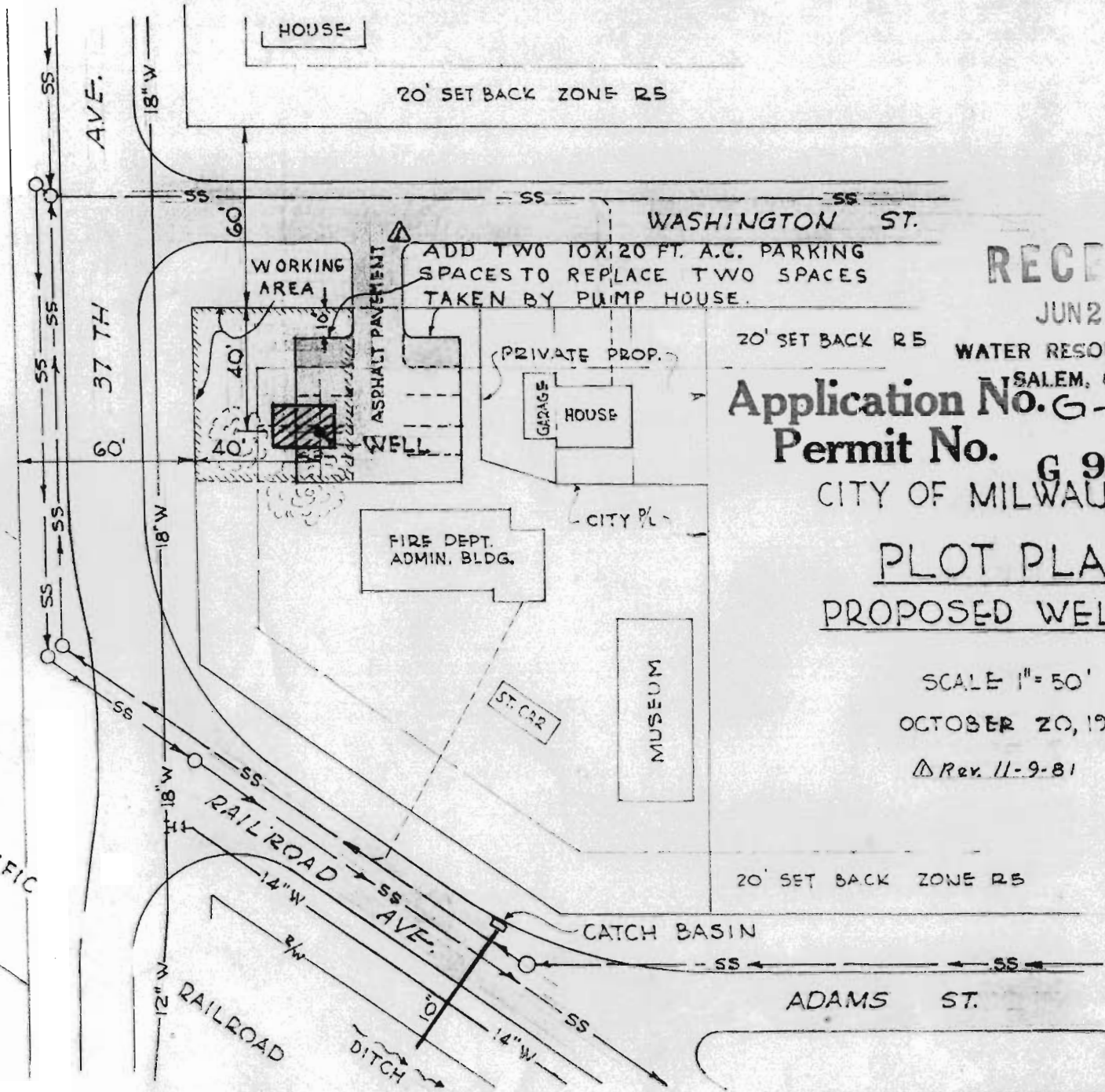

SOUTHERN PACIFIC
R/W



HOUSE
20' SET BACK ZONE RS

WASHINGTON ST.

ADD TWO 10X20 FT. A.C. PARKING SPACES TO REPLACE TWO SPACES TAKEN BY PUMP HOUSE.

WORKING AREA

ASPHALT PAVEMENT

WELL

PRIVATE PROP.

GARAGE HOUSE

FIRE DEPT. ADMIN. BLDG.

CITY PL.

ST. CAR

MUSEUM

20' SET BACK RS

WATER RESOURCES DEPT
SALEM, OREGON

Application No. G-10762

Permit No. G 9954

CITY OF MILWAUKIE

PLOT PLAN

PROPOSED WELL # 7

RECEIVED

JUN 28 1982

SCALE 1" = 50'

OCTOBER 20, 1981

Rev. 11-9-81

20' SET BACK ZONE RS

CATCH BASIN

ADAMS ST.

937-L-1
5845

R.1E.
R.2E.

23 24
26 25

24 21
25 30

21 22
30 29

22 23
29 28

26 25
35 36

25 30
34 31

30 29
31 32

29 28
32 33

T.1S.
T.2S.

26 25
35 36

31 32
4 5

T.1S.
T.2S.

32 33
5 4

Willamette River

MILWAUKIE & VICINITY

N.W. Corner
Gannett D.C. 39

○ CITY WELL LOCATIONS

SCALE 1"=800'

Application No. G-10762
Permit No. G 9954

RECEIVED
JUN 28 1982
WATER RESOURCES DEPT
SALEM, OREGON

R.1E.
R.2E.