

DESCHUTES RIVER WOODS

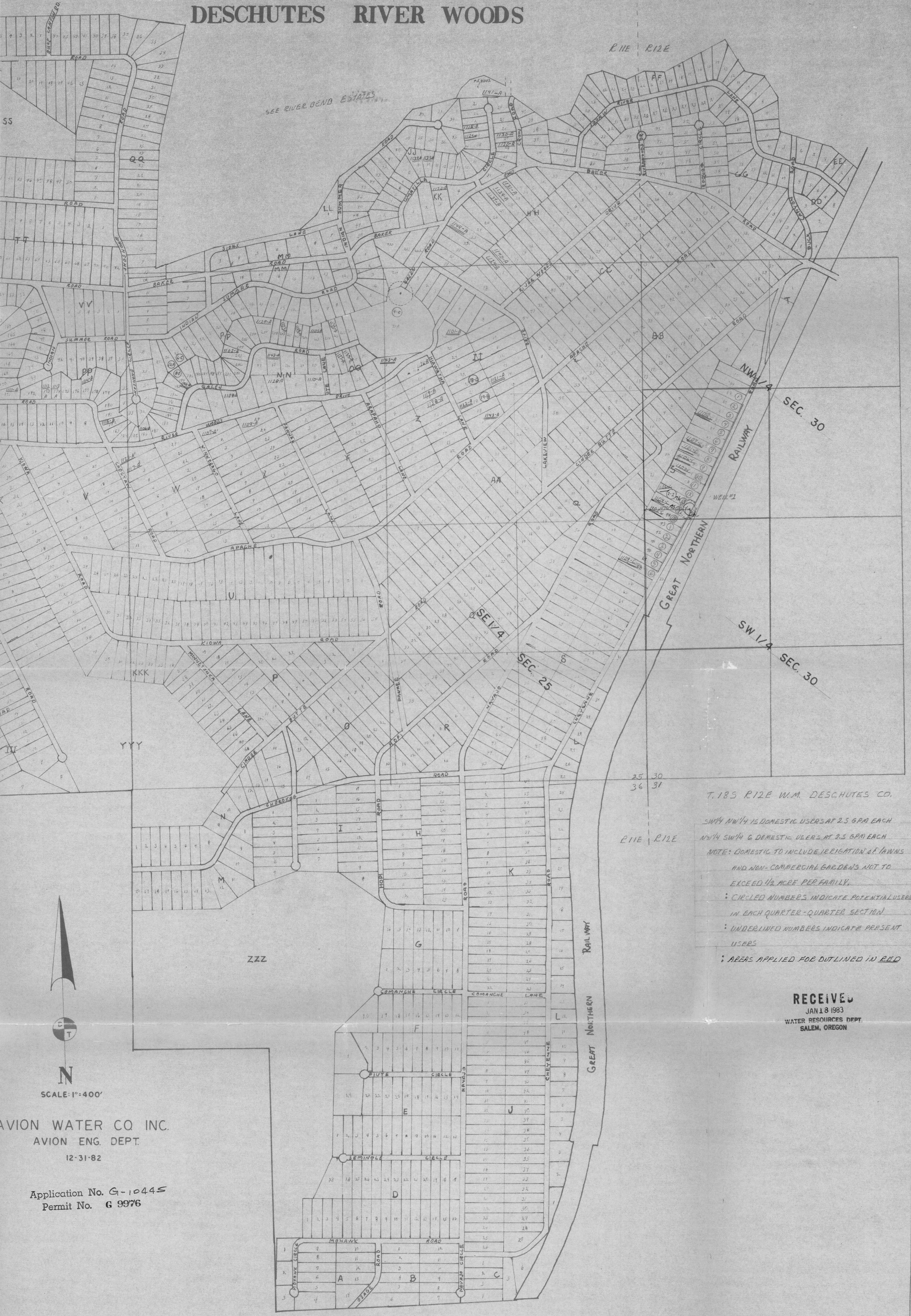

SEE RIVER BEND ESTATES

E 1/2 R 12E

SEC. 30

SEC. 25

SW 1/4 SEC. 30

25 30
36 31
E 1/2 R 12E

T. 18S R. 12E W.M. DESCHUTES CO.
 SW 1/4 NW 1/4 IS DOMESTIC USERS AT 2.5 GPM EACH
 NW 1/4 SW 1/4 G DOMESTIC USERS AT 2.5 GPM EACH
 NOTE: DOMESTIC TO INCLUDE IRRIGATION OF LAWNS
 AND NON-COMMERCIAL GARDENS NOT TO
 EXCEED 1/2 ACRE PER FAMILY.
 : CIRCLED NUMBERS INDICATE POTENTIAL USERS
 IN EACH QUARTER-QUARTER SECTION
 : UNDERLINED NUMBERS INDICATE PRESENT
 USERS
 : AREAS APPLIED FOR OUTLINED IN RED

RECEIVED
 JAN 18 1983
 WATER RESOURCES DEPT.
 SALEM, OREGON

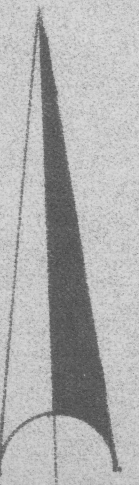

SCALE: 1"=400'

AVION WATER CO INC.
 AVION ENG. DEPT.
 12-31-82

Application No. G-10445
 Permit No. G 9976

DESCHUTES RIVER WOODS



SEE RIVER BEND ESTATES

R11E R12E

SEC. 30

SEC. 25

SW 1/4 SEC. 30

R11E R12E
25 30
36 31

T. 18S R. 12E W.M. DESCHUTES CO.
SW 1/4 NW 1/4 IS DOMESTIC USERS AT 2.5 GPM EACH
NW 1/4 SW 1/4 G DOMESTIC USERS AT 2.5 GPM EACH
NOTE: DOMESTIC TO INCLUDE IRRIGATION OF LAWNS
AND NON-COMMERCIAL GARDENS NOT TO
EXCEED 1/2 ACRE PER FAMILY.
: CIRCLED NUMBERS INDICATE POTENTIAL USERS
IN EACH QUARTER-QUARTER SECTION
: UNDERLINED NUMBERS INDICATE PRESENT
USERS
: AREAS APPLIED FOR OUTLINED IN RED

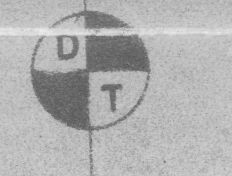
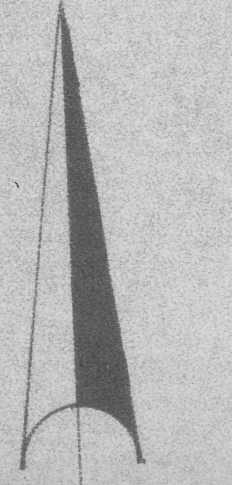

SCALE: 1" = 400'

AVION WATER CO INC.
AVION ENG. DEPT.
12-31-82

Application No. G-10445
Permit No. G 9976

RECEIVED
JAN 18 1983
WATER RESOURCES DEPT.
SALEM, OREGON